

0 10 20 40 60 80 100 120 140 160 Miles

**RESEARCH & POLLING**  
INC.

For the New Mexico  
Legislative Council Service

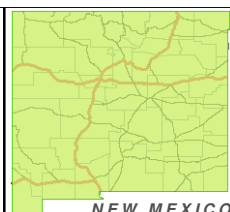

**LEGEND** Created: July 12, 2011

- Counties
- Interstate Highway
- Rivers
- US Highway

Research & Polling, Inc. distributes this map assuming no liability for any errors, omissions, or inaccuracies in the information provided regardless of the cause in reliance upon any maps.



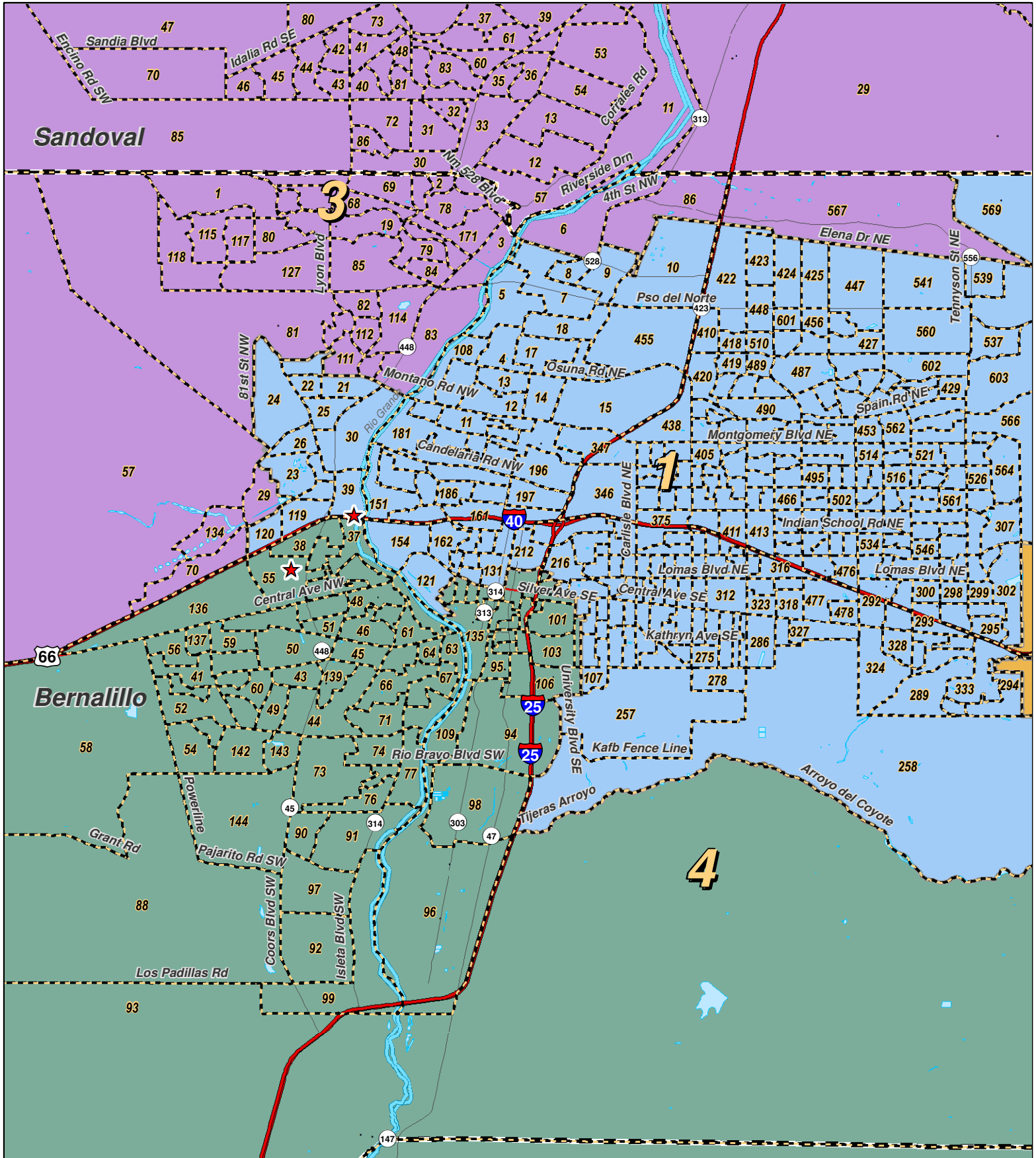

0 5 Miles

**Issued: July 28, 2011**

For the New Mexico  
Legislative Council Service



**LEGEND** Created: July 26, 2011

★ Legislators	🌊 Rivers	🛣 Interstate
⬭ Precincts	🌊 Lakes / Ponds	🛣 US Highway
⬭ Counties		🛣 State Highway

Research & Polling, Inc. distributes this map assuming no liability for any errors, omissions, or inaccuracies in the information provided regardless of the cause in reliance upon any maps.

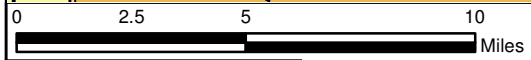
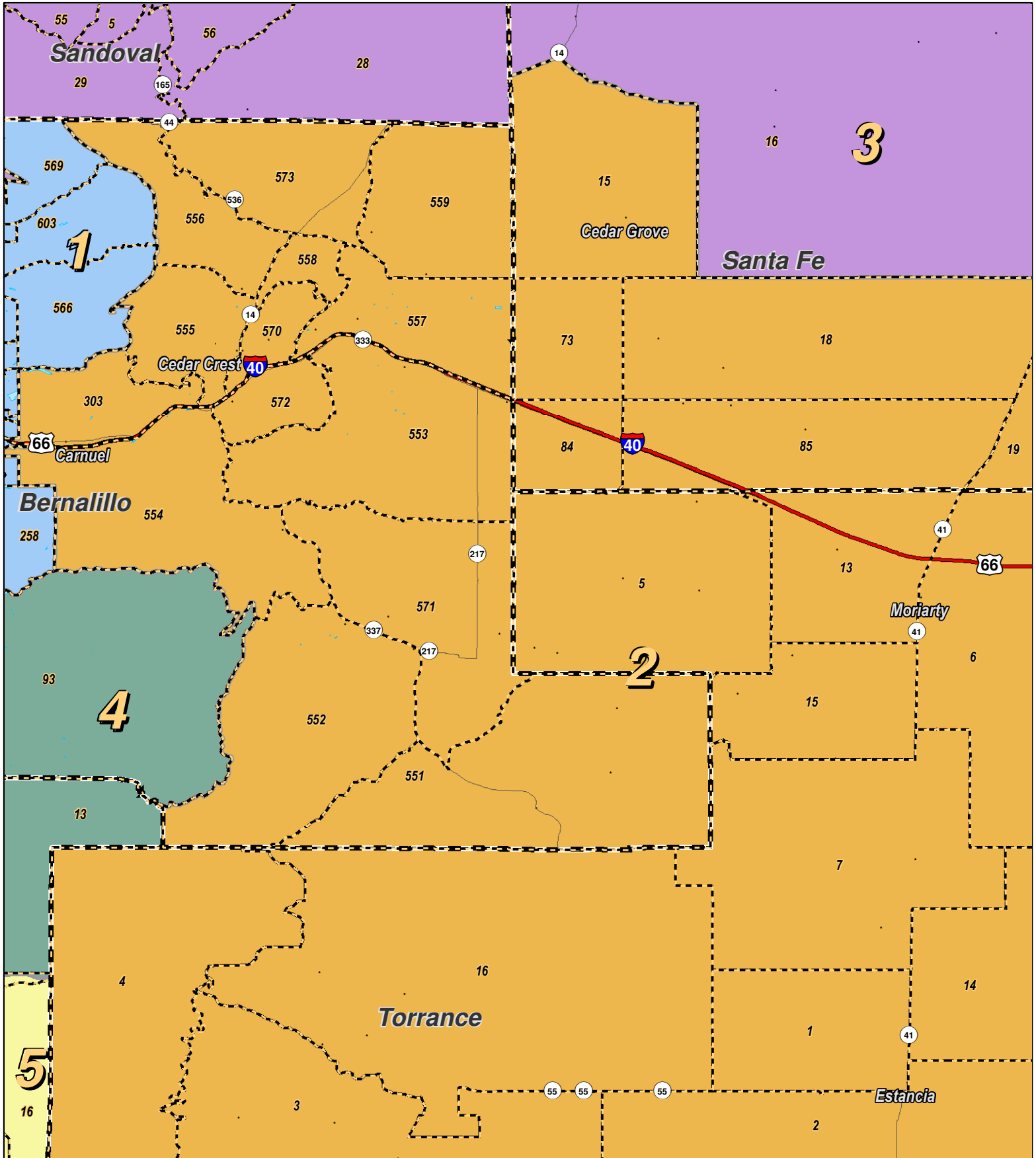

For the New Mexico  
Legislative Council Service



## LEGEND

Created: July 12, 2011

Precincts	Interstate
Counties	US Highway
Rivers	State Highway

Research & Polling, Inc. distributes this map assuming no liability for any errors, omissions, or inaccuracies in the information provided regardless of the cause in reliance upon any maps.

# NM PRC: Current Districts

# Albuquerque (West)

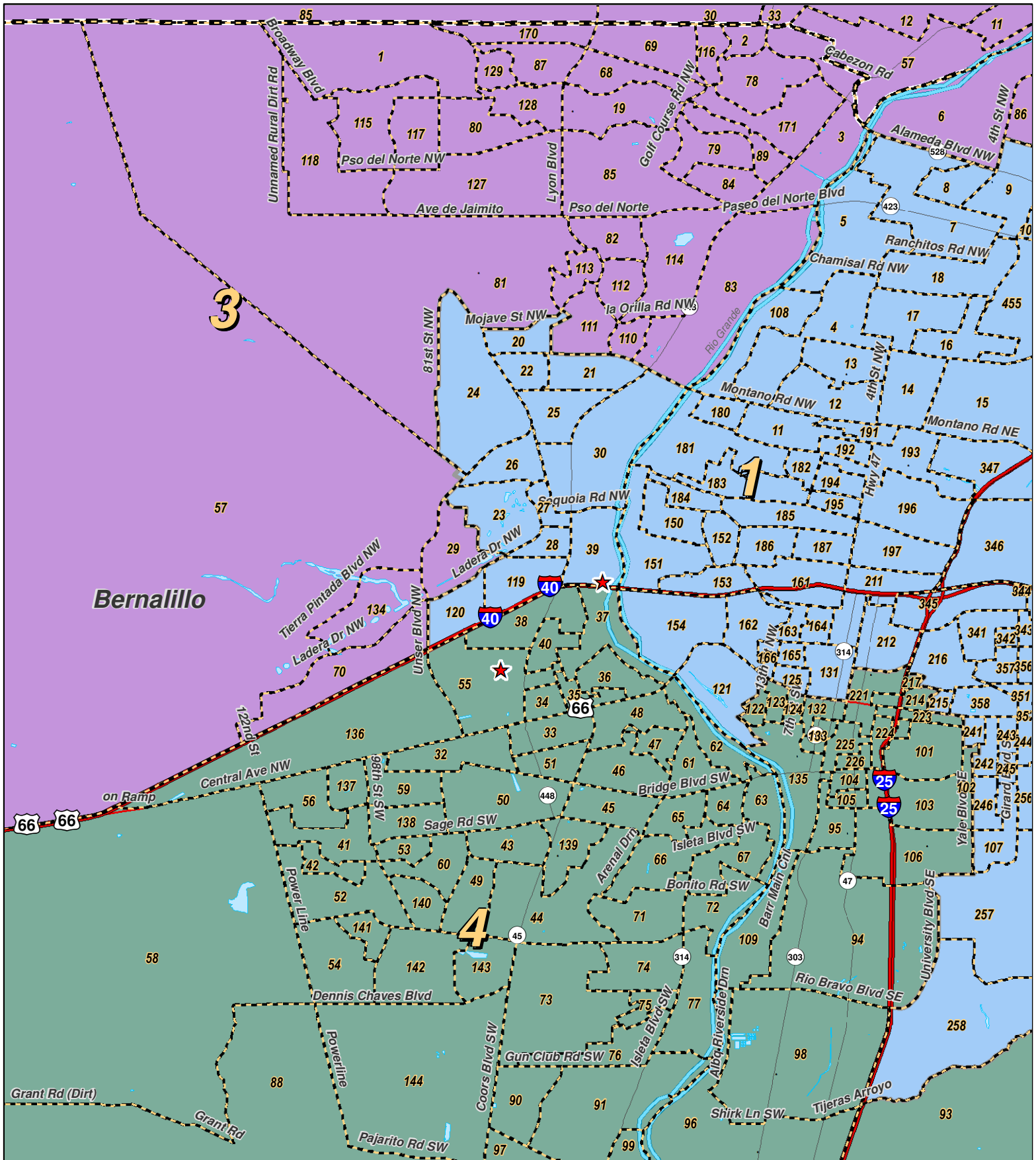

0 2.5 5 Miles

**RESEARCH & POLLING INC.**

For the New Mexico Legislative Council Service



**LEGEND** Created: July 12, 2011

- Counties
- Rivers
- Interstate
- US Highway
- State Highway

Research & Polling, Inc. distributes this map assuming no liability for any errors, omissions, or inaccuracies in the information provided regardless of the cause in reliance upon any maps.

# NM PRC: Current Districts

# Albuquerque (East)

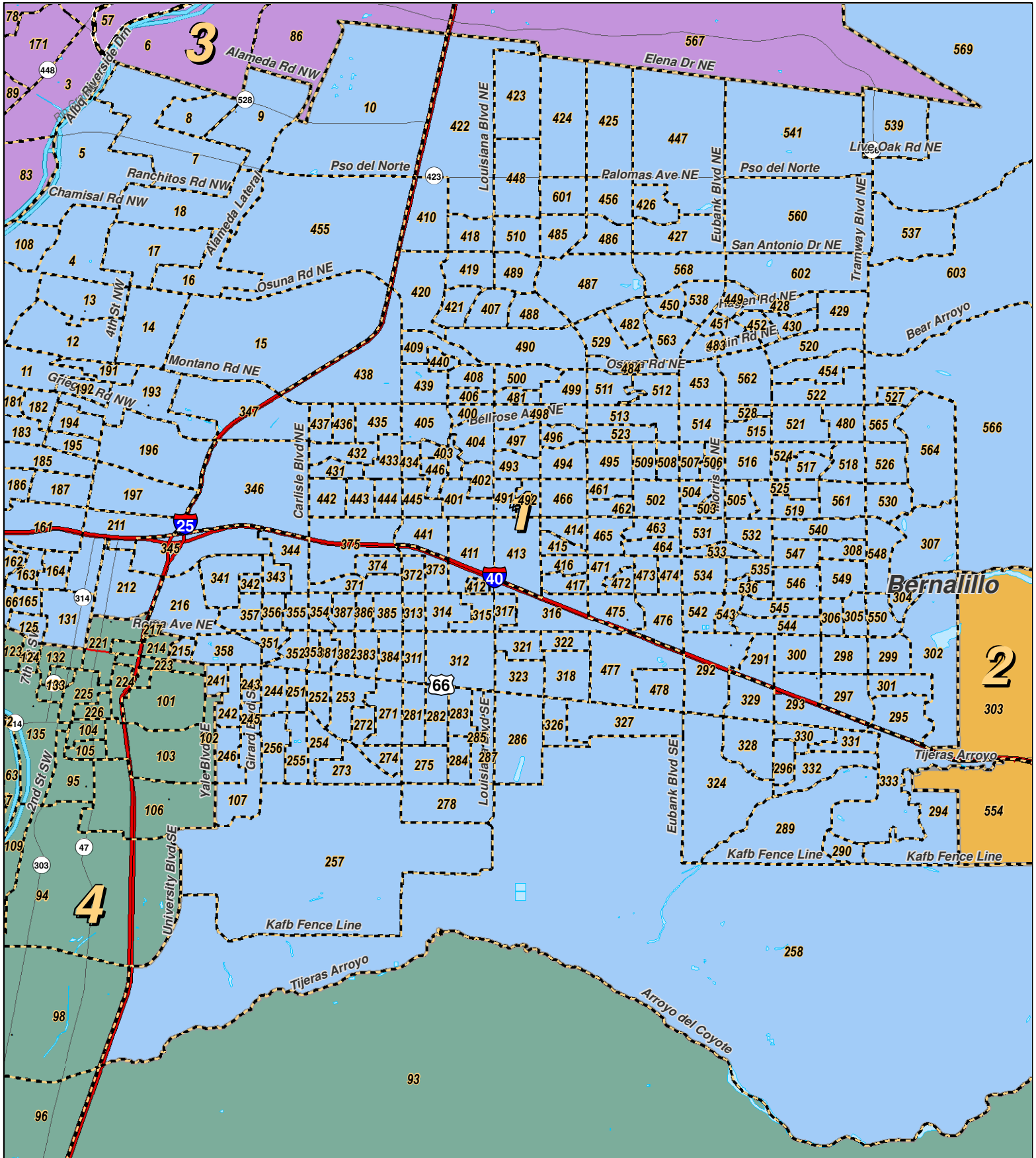

0 3 Miles

**Issued: July 28, 2011**

For the New Mexico  
Legislative Council Service



**LEGEND** Created: July 26, 2011

★ Legislators	🌊 Rivers	🛣 Interstate
⬜ Precincts	🌊 Lakes / Ponds	🛣 US Highway
⬜ Counties		🛣 State Highway

Research & Polling, Inc. distributes this map assuming no liability for any errors, omissions, or inaccuracies in the information provided regardless of the cause in reliance upon any maps.

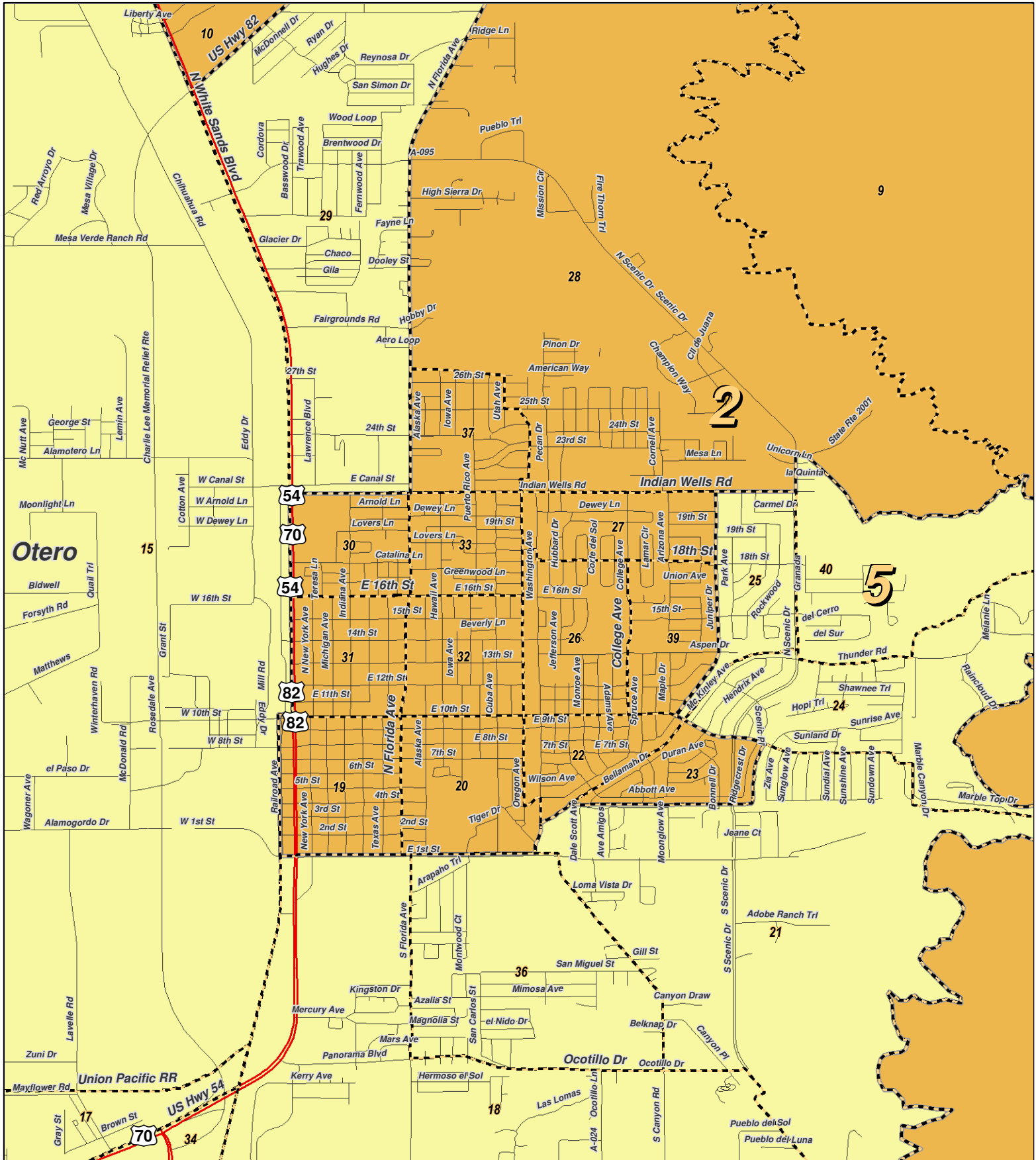

0 1 2 Miles

**RESEARCH & POLLING**  
INC.

For the New Mexico  
Legislative Council Service



**LEGEND** Created: July 12, 2011

Counties	Interstate
Rivers	US Highway
	State Highway

Research & Polling, Inc. distributes this map assuming no liability for any errors, omissions, or inaccuracies in the information provided regardless of the cause in reliance upon any maps.

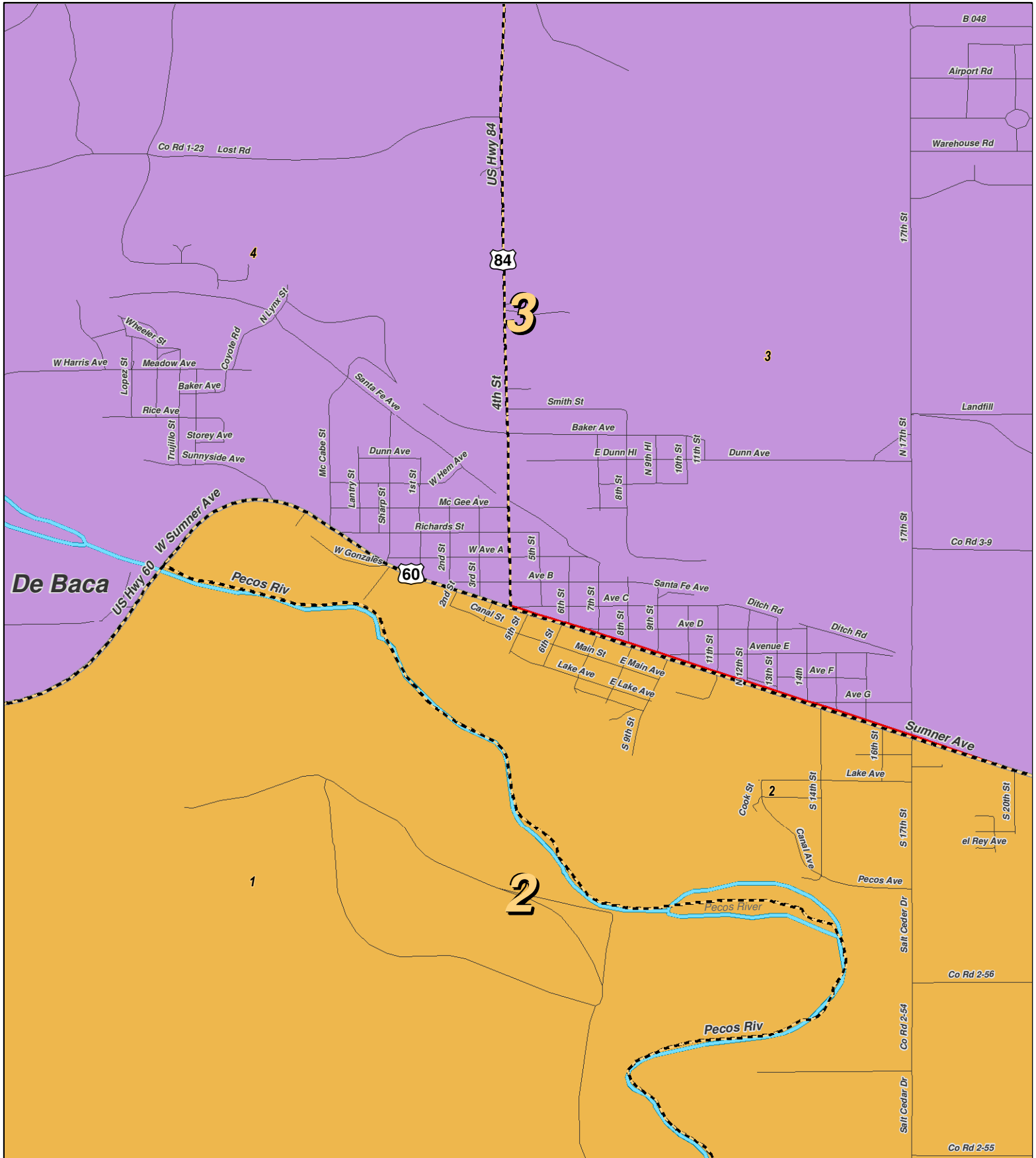

0 0.5 1 Miles

**RESEARCH & POLLING INC.**

For the New Mexico Legislative Council Service



**LEGEND** Created: July 12, 2011

Counties	Interstate
Rivers	US Highway
	State Highway

Research & Polling, Inc. distributes this map assuming no liability for any errors, omissions, or inaccuracies in the information provided regardless of the cause in reliance upon any maps.



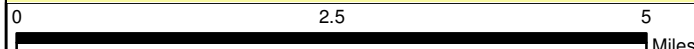
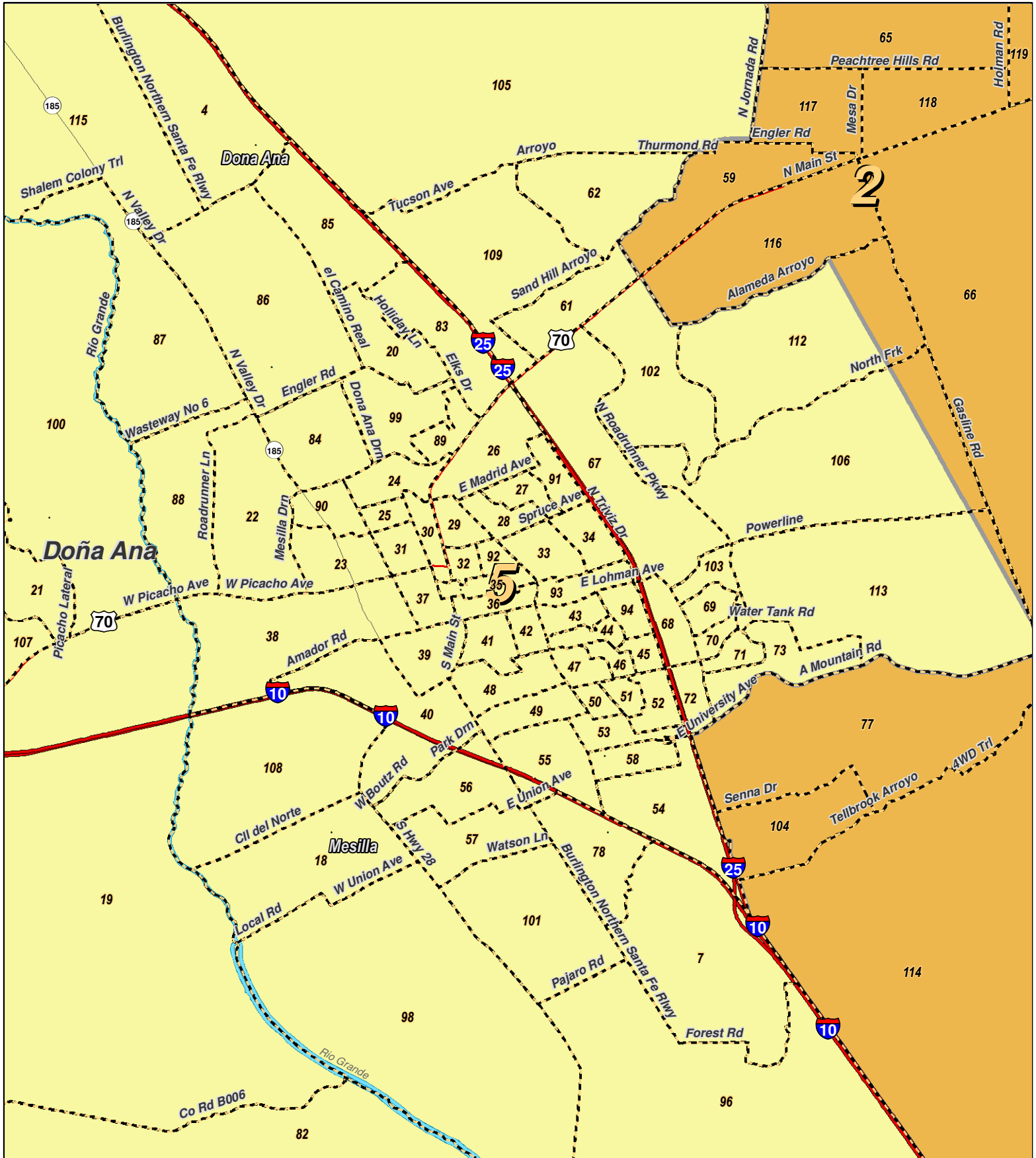

For the New Mexico  
Legislative Council Service



## LEGEND

- Counties
- Rivers
- Interstate
- US Highway
- State Highway

Research & Polling, Inc. distributes this map assuming no liability for any errors, omissions, or inaccuracies in the information provided regardless of the cause in reliance upon any maps.

Created: July 12, 2011

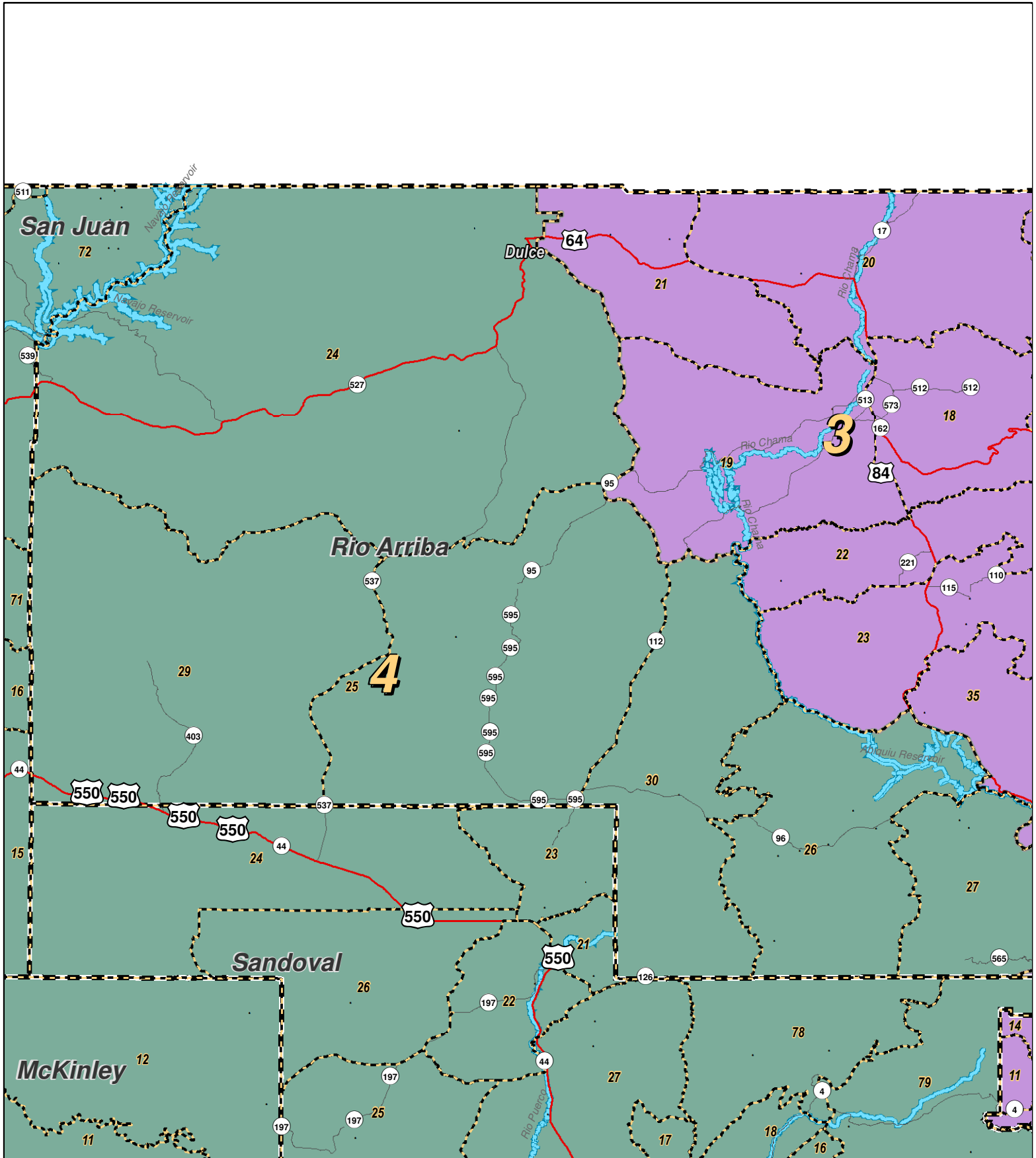

0 2.5 5 10 15 20 25 30 35 Miles

**RESEARCH & POLLING**  
INC.

For the New Mexico  
Legislative Council Service



**LEGEND** Created: July 12, 2011

Precincts	Interstate
Counties	US Highway
Rivers	State Highway

Research & Polling, Inc. distributes this map assuming no liability for any errors, omissions, or inaccuracies in the information provided regardless of the cause in reliance upon any maps.

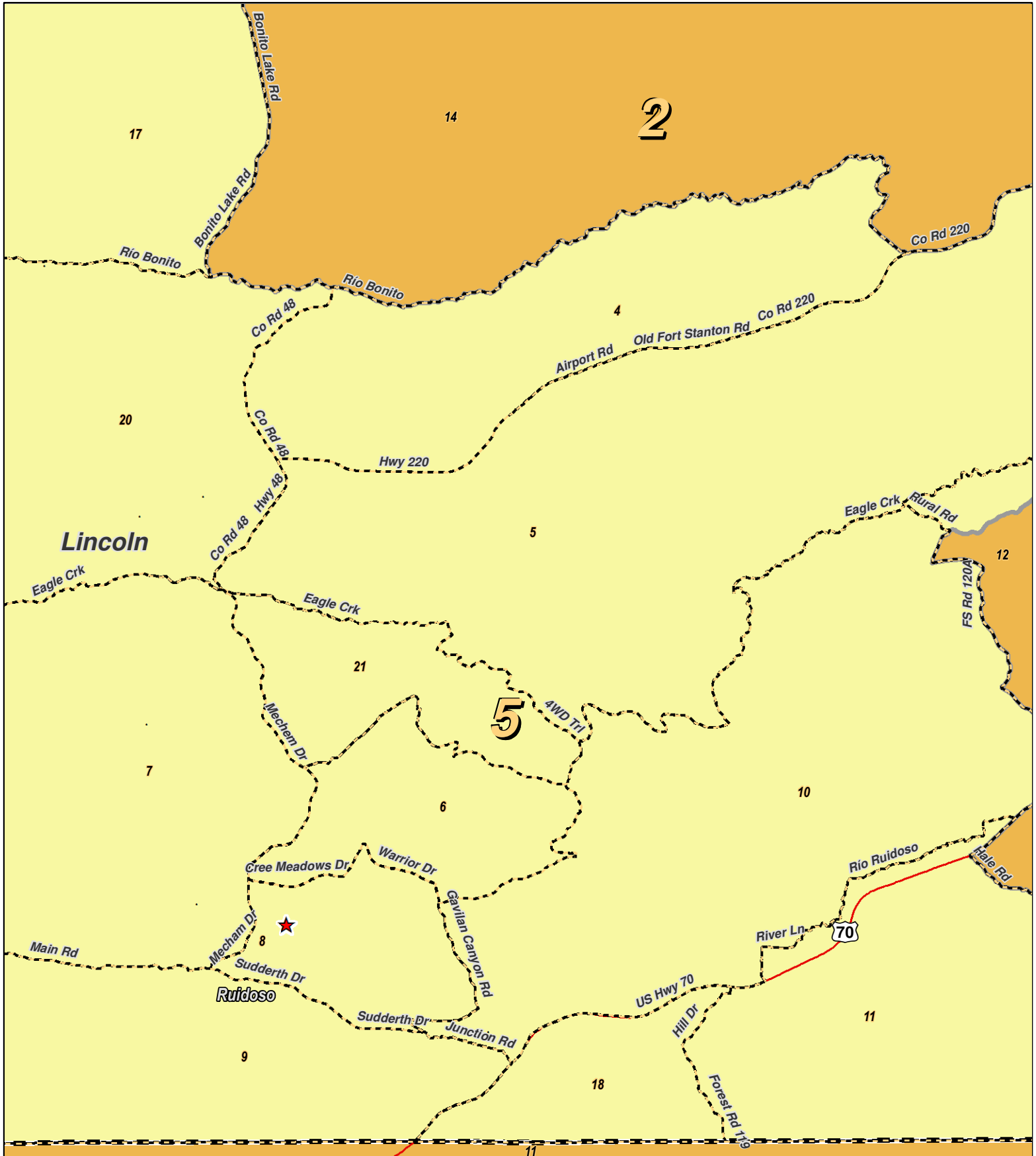

0 2.5 5 M

**RESEARCH & POLLING INC.**

For the New Mexico Legislative Council Service



**LEGEND** Created: July 12, 2011

Counties	Interstate
Rivers	US Highway
	State Highway

Research & Polling, Inc. distributes this map assuming no liability for any errors, omissions, or inaccuracies in the information provided regardless of the cause in reliance upon any maps.

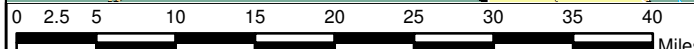
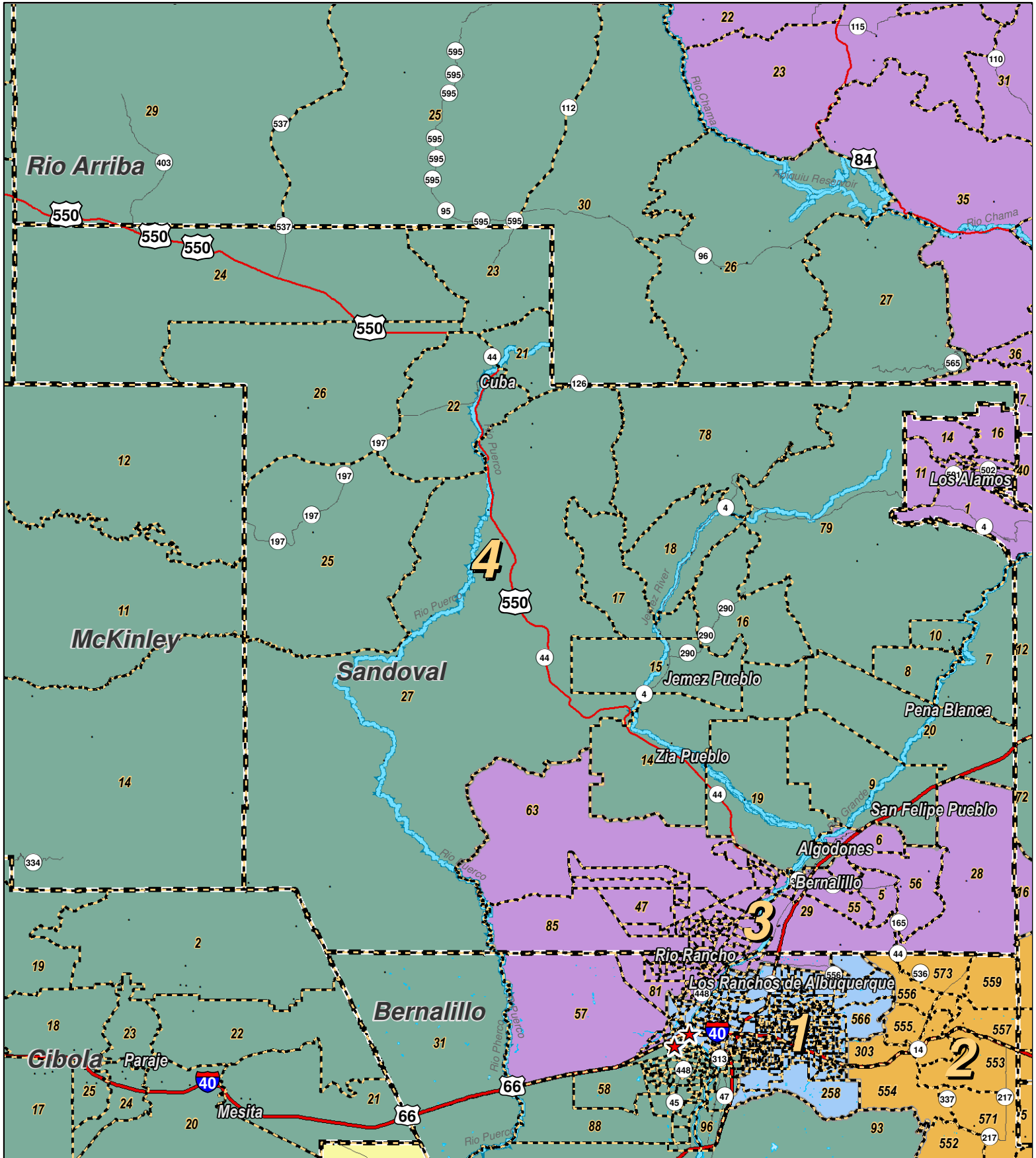

For the New Mexico  
Legislative Council Service



## LEGEND

Created: July 12, 2011

- Precincts
- Counties
- Rivers
- Interstate
- US Highway
- State Highway

Research & Polling, Inc. distributes this map assuming no liability for any errors, omissions, or inaccuracies in the information provided regardless of the cause in reliance upon any maps.

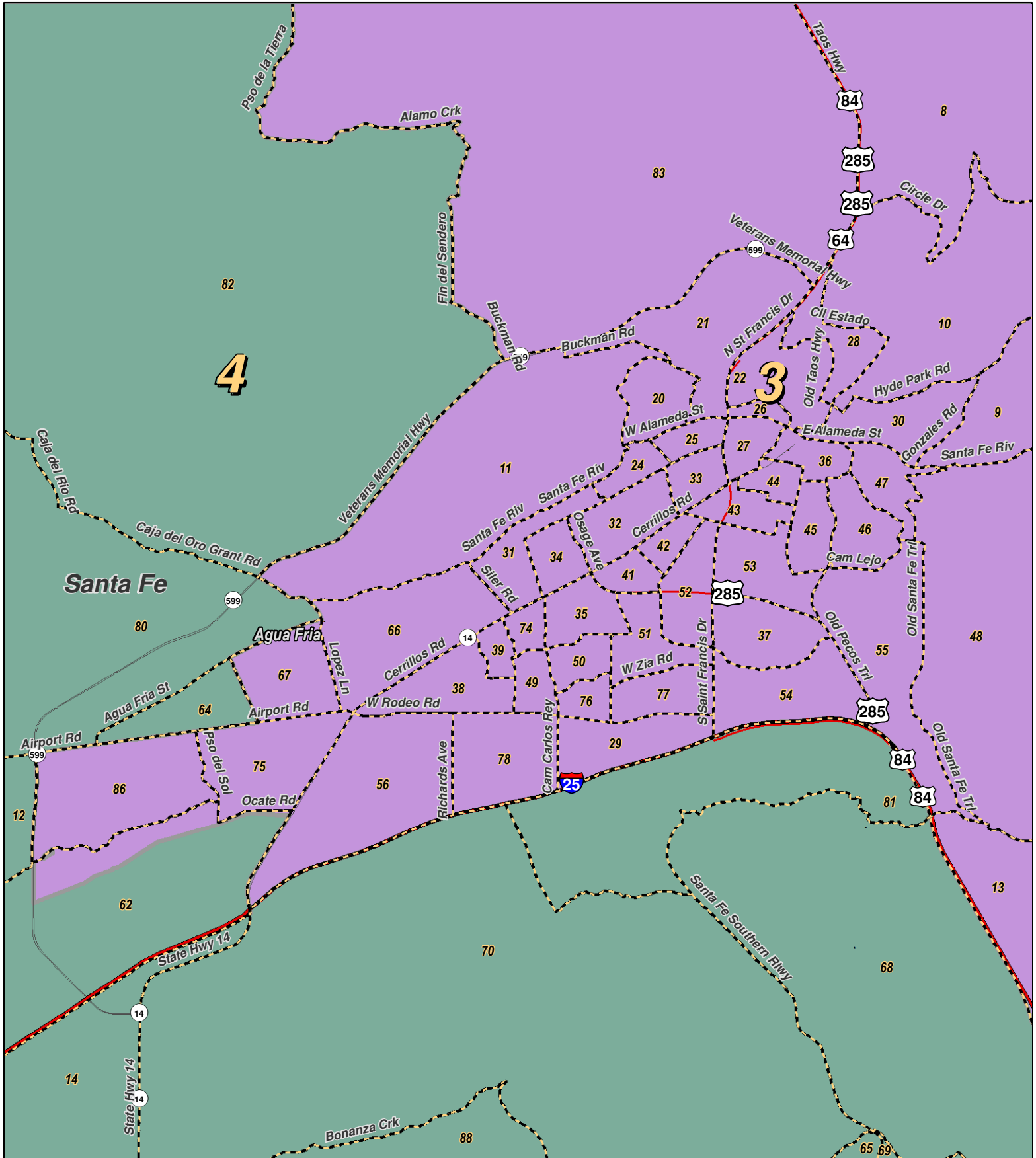

0 2.5 5  
Miles

**RESEARCH & POLLING INC.**

For the New Mexico  
Legislative Council Service



**LEGEND** Created: July 12, 2011

Counties	Interstate
Rivers	US Highway
	State Highway

Research & Polling, Inc. distributes this map assuming no liability for any errors, omissions, or inaccuracies in the information provided regardless of the cause in reliance upon any maps.

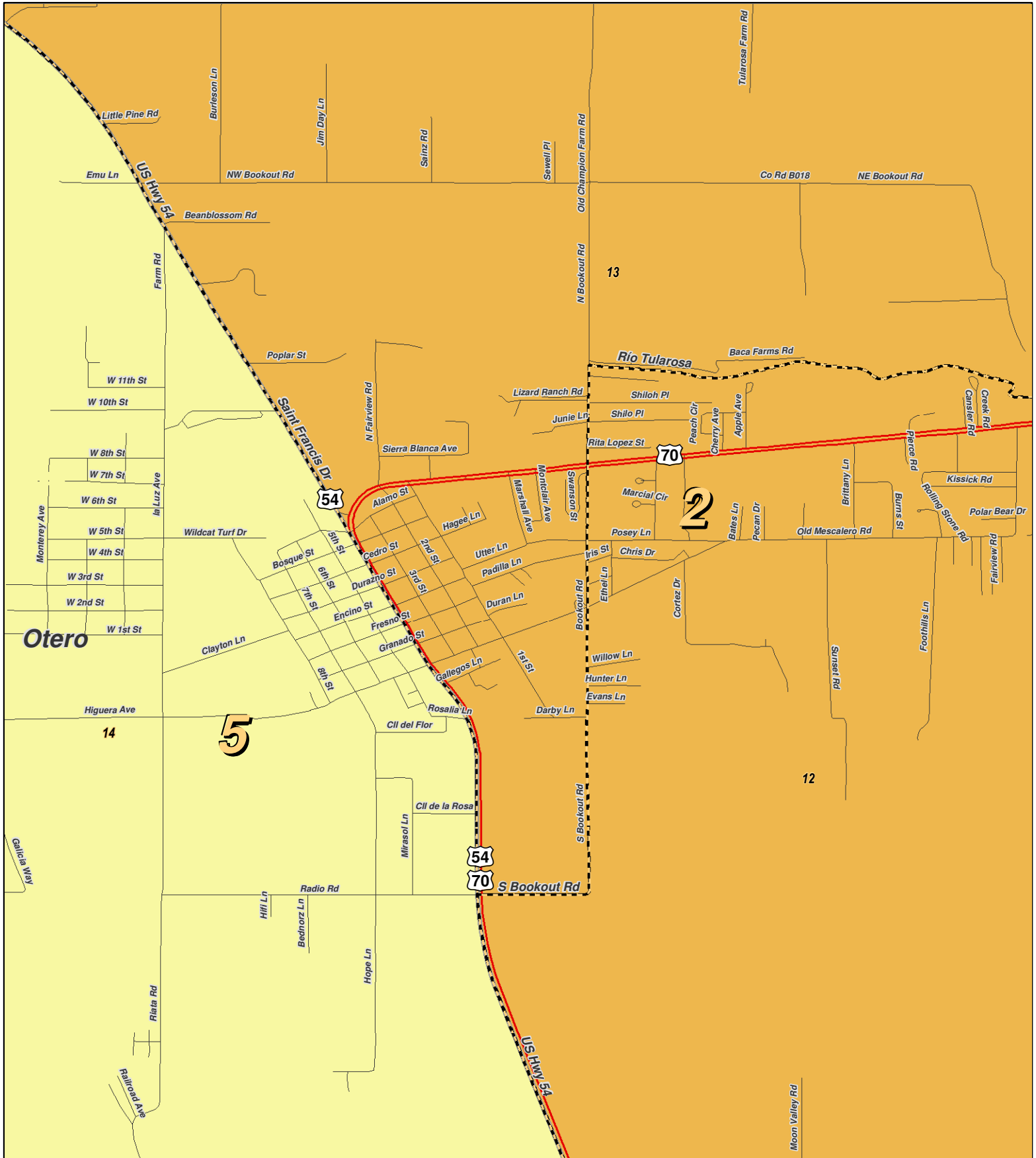

0 0.5 1 Miles

**RESEARCH & POLLING INC.**

For the New Mexico Legislative Council Service



**LEGEND** Created: July 12, 2011

Counties	Interstate
Rivers	US Highway
	State Highway

Research & Polling, Inc. distributes this map assuming no liability for any errors, omissions, or inaccuracies in the information provided regardless of the cause in reliance upon any maps.

District	Pop	Deviation	Hispanic	Non-Hispanic Origin				
				White	Native American	Black	Asian	Other Races
1	400,255	-11,581 -2.8%	154,695 38.6%	199,550 49.9%	15,347 3.8%	10,227 2.6%	11,502 2.9%	8,934 2.2%
18+	315,395		110,121 34.9%	171,235 54.3%	11,326 3.6%	8,060 2.6%	9,089 2.9%	5,564 1.8%
2	378,355	-33,481 -8.1%	168,893 44.6%	186,208 49.2%	6,211 1.6%	8,927 2.4%	2,570 0.7%	5,546 1.5%
18+	276,863		109,020 39.4%	151,470 54.7%	4,431 1.6%	6,620 2.4%	2,067 0.7%	3,255 1.2%
3	443,301	31,465 7.6%	221,574 50.0%	186,541 42.1%	14,190 3.2%	6,440 1.5%	6,445 1.5%	8,111 1.8%
18+	337,196		156,686 46.5%	155,266 46.0%	10,379 3.1%	4,938 1.5%	5,036 1.5%	4,891 1.5%
4	446,579	34,743 8.4%	186,084 41.7%	110,770 24.8%	135,143 30.3%	4,812 1.1%	2,648 0.6%	7,122 1.6%
18+	317,917		124,221 39.1%	91,445 28.8%	92,437 29.1%	3,836 1.2%	2,143 0.7%	3,835 1.2%
5	390,689	-21,147 -5.1%	222,157 56.9%	150,741 38.6%	4,477 1.1%	5,056 1.3%	3,140 0.8%	5,118 1.3%
18+	293,136		151,278 51.6%	128,432 43.8%	3,389 1.2%	3,999 1.4%	2,621 0.9%	3,417 1.2%
<b>Totals</b>	2,059,179	Ideal: 411,836	953,403 46.3%	833,810 40.5%	175,368 8.5%	35,462 1.7%	26,305 1.3%	34,831 1.3%
18+	1,540,507		651,326 42.3%	697,848 45.3%	121,962 7.9%	27,453 1.8%	20,956 1.4%	20,962 1.2%





Issued: July 28, 2011

District Profile

District	Total Population	Deviation		Adult Hispanic	Adult Non-Hispanic			Performance Measure		Registered Voters				
					White	Native American	Black	Dem	Rep	Total	% Dem	% Rep	% DTS	% Other
1	400,255	-11,581	-2.8%	34.9%	54.3%	3.6%	2.6%	53.0%	47.0%	264,938	46.0%	33.8%	16.4%	3.7%
2	378,355	-33,481	-8.1%	39.4%	54.7%	1.6%	2.4%	37.3%	62.7%	186,483	38.3%	44.5%	15.5%	1.8%
3	443,301	31,465	7.6%	46.5%	46.0%	3.1%	1.5%	60.4%	39.6%	283,842	56.9%	26.3%	14.1%	2.9%
4	446,579	34,743	8.4%	39.1%	28.8%	29.1%	1.2%	59.0%	41.0%	218,698	54.1%	25.6%	17.3%	2.6%
5	390,689	-21,147	-5.1%	51.6%	43.8%	1.2%	1.4%	50.7%	49.3%	206,203	48.0%	32.5%	16.7%	2.8%
<b>New Mexico</b>	2,059,179	<b>Ideal: 411,836</b>		42.3%	45.3%	7.9%	1.8%	53.0%	47.0%	1,160,164	49.3%	31.9%	15.9%	2.9%