

MUNICIPAL WATER USE

Legislative Finance Committee

Adrienne L. Widmer, P.E.

Las Cruces Utilities Director

June 27, 2023

 CITY OF LAS CRUCES



WATER OPERATIONS & MAINTENANCE LINE OF BUSINESS

- ✓38,114 customers
- ✓Over 4,000 fire hydrants
- ✓Over 10,000 valves
- ✓Over 600 miles of water distribution lines
- ✓Operate over 40 wells
- ✓42 MGD capacity
- ✓12 reservoirs with 25.4 MG capacity
- ✓7 booster stations
- ✓Over 40 wells sites, 8 boosters, 8 tanks, 4 pressure tanks (JWC)
- ✓Staff of 58, plus 5 contract
- ✓Operating budget \$20.350M
- ✓Personnel budget \$4.522M
- ✓Capital budget \$1.199M
- ✓Equipment budget \$1.931M

WATER USE HISTORY

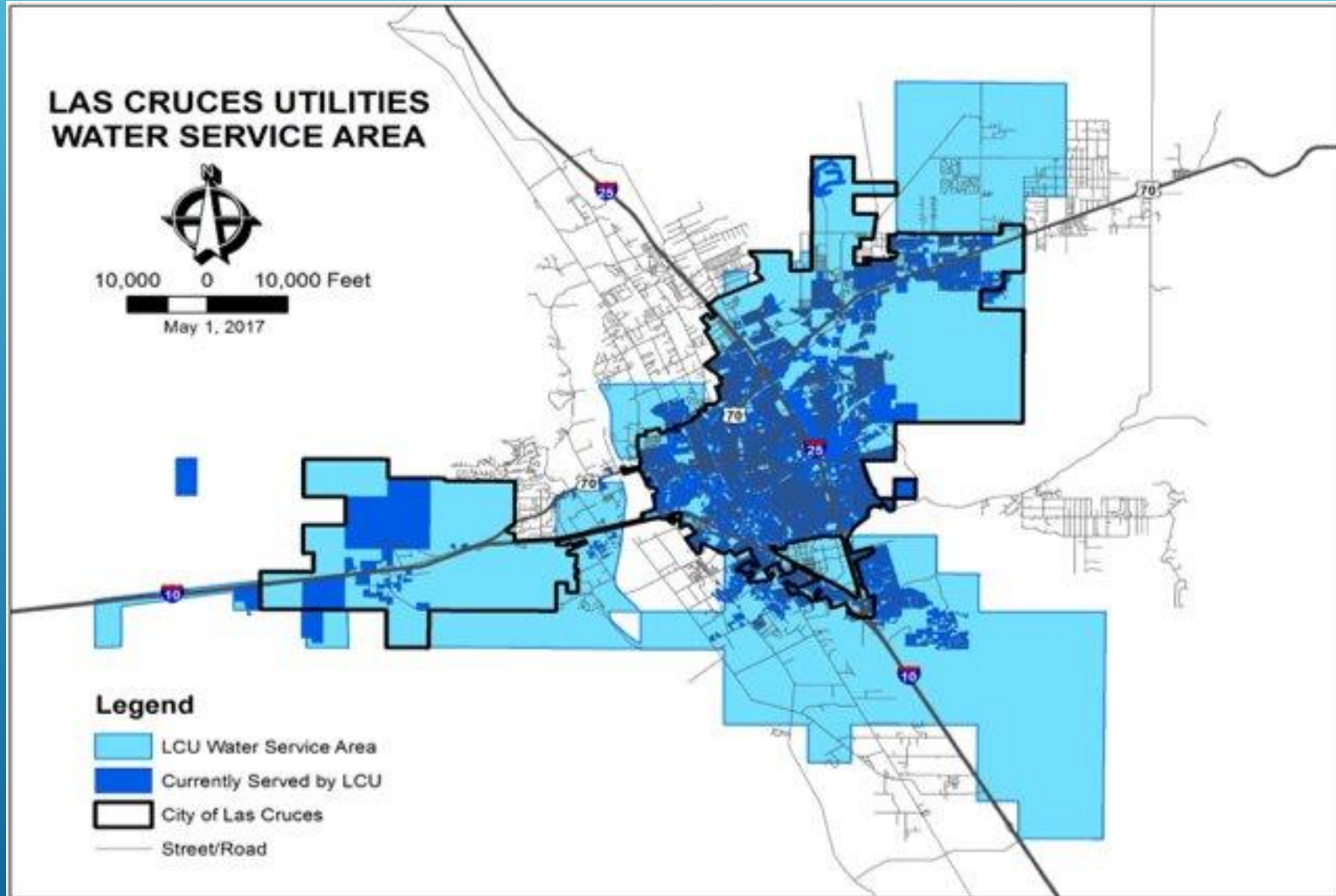

- ✓ Acequia Madre de Las Cruces – 1840s
- ✓ Neighborhood Wells – 1880s
- ✓ Municipal Well System Initiated - 1905

**CITY OF LAS CRUCES
40-YEAR WATER
DEVELOPMENT PLAN**

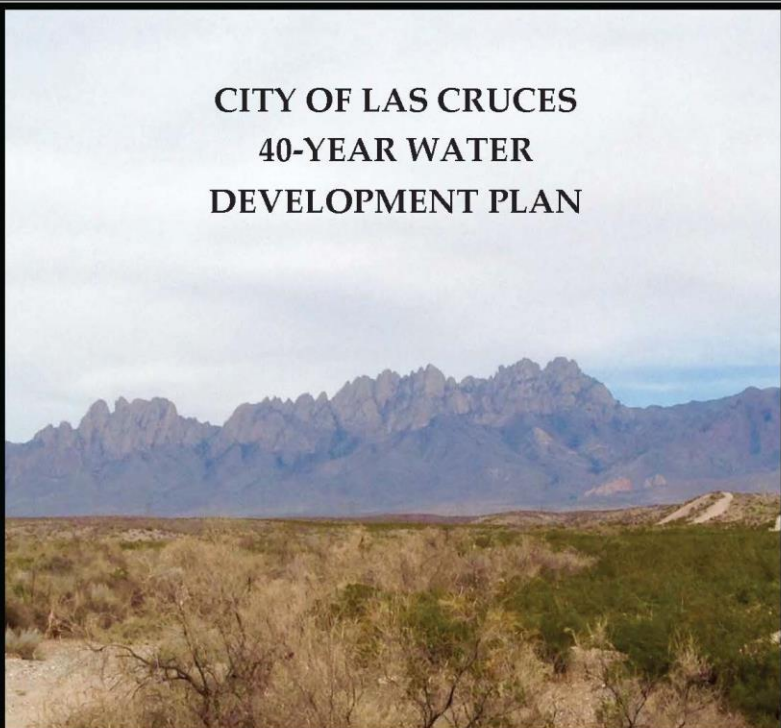

by

Annie M. McCoy, CPG

John W. Shomaker, PhD, CPG

JOHN SHOMAKER & ASSOCIATES, INC.
Water-Resource and Environmental Consultants

2611 Broadbent Parkway NE
Albuquerque, New Mexico 87107

www.shomaker.com

505-345-3407

prepared for

Las Cruces Utilities
City of Las Cruces

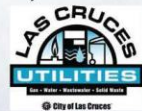

April 2017

Shomaker

- ✓ 40-Year Water Development Plan
 - ✓ Mandated for Cities
 - ✓ Advanced Planning for no shortages during drought
 - ✓ Approved by State Engineer

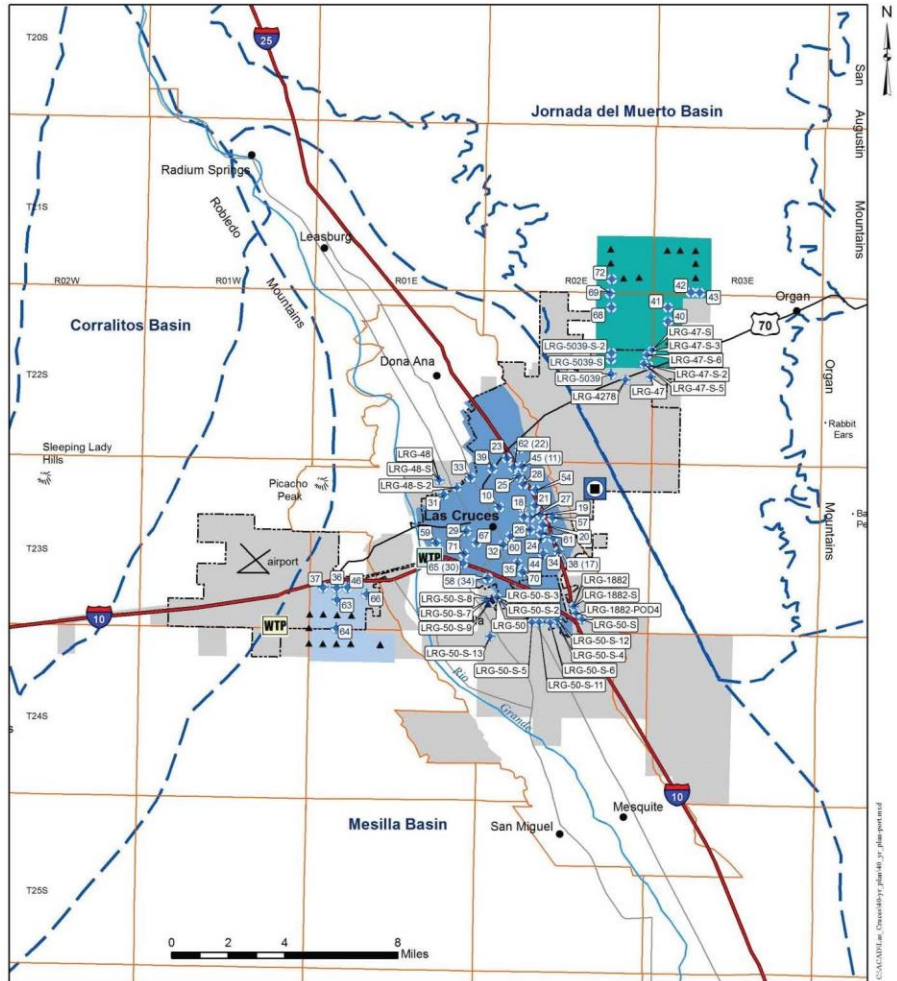

Explanation			
	East Mesa water reclamation		Well Field
	Jacob A Hands wastewater treatment facility		East Mesa
	West Mesa water treatment facility		Valley
	City of Las Cruces well		West Mesa
	NMOSE permitted well		Las Cruces city limits (Jan. 2016)
			basin boundary
			City of Las Cruces water rights place-of-use (April 2017)

- ✓ Valley Well Field
- ✓ West Mesa Well Field
- ✓ East Mesa Well Field
 - ✓ Imports Water to the Rio Grande
- ✓ Active – Managed Demand Use
- ✓ Inactive – Water Level Monitoring

TYPICAL WATER USERS

- ✓ 83,632 SFR Population
- ✓ 30,880 MFR Population
- ✓ 18 Elementary Schools – 8,239 Students
- ✓ 4 Middle Schools – 3,344 Students
- ✓ 4 High Schools – 6,546 Students
- ✓ 10 Private/Charter Schools – 1,452 Students
- ✓ 3 Hospitals – 3,650 Employees
- ✓ Example Industrial Use
 - ✓ Olam – 100 to 200 Employees
 - ✓ Saputo Dairy – 460 Employees
 - ✓ Alaska Industries – 310 Employees
- ✓ Numerous Commercial Use
- ✓ Parks, Trails, Sport Fields
- ✓ Emergency Water Supply Backup
 - ✓ Town of Mesilla
 - ✓ Dona Ana MDWCA

ANNUAL EVALUATION OF
2021 WATER-LEVEL MONITORING DATA
FROM THE CITY OF LAS CRUCES
WATER SUPPLY WELLS, NEW MEXICO



prepared by



JOHN SHOMAKER & ASSOCIATES, INC.
Water-Resource and Environmental Consultants
www.shomaker.com ♦ 505-345-3407

prepared for



LAS CRUCES UTILITIES
City of Las Cruces, New Mexico



AUGUST 2022



CURRENT AND PROACTIVE PLANNING

- ✓ Water Level Monitoring – 2011
- ✓ Water Quality Meets All State and Federal Regulations for Potable Water Use
- ✓ East Mesa Water Reclamation
- ✓ Conceptual Aquifer Recovery and Reuse Projects

GROUNDWATER DIVERSIONS

 Three (3) Year Comparison and Summary of Metered Groundwater Diversions in the Lower Rio Grande Water Master District (Acre-Feet) 									
Category	2018		2019		2020		3-Year Total		
Irrigation	244,310	83.44%	217,187	81.91%	218,231	82.11%	679,728	82.52%	
Drinking Water: Municipal, Mutual Domestic, and individual Domestic Supply (includes 2,400 AF of estimated unmetered domestic)	39,474	13.48%	38,719	14.60%	40,164	15.11%	118,357	14.37%	
City of Las Cruces	22,158		21,316		21,401				
New Mexico State University	2,608		3,028		3,087				
Mutual Domestic	7,213		7,870		12,204				
Other Drinking Water	7,496		6,505		3,472				
Commercial/Industrial/Dairy	8,400	2.87%	7,997	3.02%	6,662	2.51%	23,059	2.80%	
All Other Uses	618	0.21%	1,237	0.47%	738	0.28%	2,593	0.31%	
Total	292,802		265,139		265,794		823,736	100%	

Reasonable efforts have been made by the New Mexico Office of the State Engineer (OSE) to verify the accuracy of this data. However, this data may be subject to change if and when more information becomes available. 4-20-2021 RJS, LRG Water Master, Manager

Table 2.

- ✓ City of Las Cruces
 - ✓ 8.05% Total Pumping
- ✓ Regional Wastewater Treatment
 - ✓ Return Flow \approx 4% Effect on Rio Grande Total

WATER CONSERVATION

LAS CRUCES UTILITIES

WATER CONSERVATION REGULATIONS

WHY DOES LAS CRUCES HAVE WATER RESTRICTIONS?

The City of Las Cruces restricts outdoor watering in the interest of water conservation.

Day-of-week restrictions help prevent overwatering of landscapes. Deeper, less frequent watering will cause plants to send their roots deeper and survive longer without water. Some newly planted plants may require daily watering to get established and residents may request a variance when this applies.

Time-of-day restrictions, which are in effect April through September, help reduce evaporation losses during watering.

WATERING PROHIBITIONS

While there are many ways to waste water, a few of them are prohibited by City regulations:

- Water flowing beyond property boundaries, for example, onto the street or sidewalk.
- Watering so much that it ponds on the property.
- Using a hose without a shut-off valve to wash a vehicle.
 - We suggest you use two buckets—one bucket of soapy water, and a second bucket of clean water for rinsing.
- Using a hose to clean impervious surfaces, for example driveways and sidewalks.
 - Use a broom instead.
- Using a hose to clean oil and hazardous chemicals.
 - For oil spots, first apply kitty litter and most of it can be removed without water. Then use a bucket of soapy water and a brush to clean off the remainder.

WATERING RESTRICTIONS

The restrictions apply to all residential and commercial properties served by Las Cruces Utilities.

- Outdoor watering for odd-numbered addresses is only allowed on Wednesday, Friday, and Sunday.
- Even addresses allowed only on Tuesday, Thursday, and Saturday.
- Between April 1st and September 30th all outdoor watering is prohibited between 10 a.m. and 6 p.m.

Warm Season Outdoor Watering

	SUN	MON	TUES	WED	THUR	FRI	SAT
10:00 a.m. - 9:59 a.m.	Green	Gray	Green	Green	Green	Green	Green
10:00 a.m. - 9:59 p.m.	Watering Prohibited						
6:00 p.m. - 5:59 p.m.	Green	Gray	Green	Green	Green	Green	Green
6:00 p.m. - 11:59 p.m.	Gray	Gray	Green	Green	Green	Green	Green
	Gray	Watering Prohibited	Green	Green	Green	Green	Green

Cool Season Outdoor Watering

	SUN	MON	TUES	WED	THUR	FRI	SAT
12:00 a.m. - 11:59 p.m.	Green	Gray	Green	Green	Green	Green	Green
	Gray	Watering Prohibited	Green	Green	Green	Green	Green

For more information about watering restrictions, visit the Water Conservation Program web pages at www.lcutilities.org/waterconservation



Las Cruces Utilities

Water Conservation Program

rh Diaz@lascruces.gov (575) 528-3549

REPORT WATER WASTE

- The Water Waste Hotline for reporting water waste and watering violations is (575) 528-4444. If you see water being wasted, please report it.
- Be prepared to provide the date and approximate time, street address or intersections, and what you observed.

WATERING VIOLATION FEES

The following fees may be assessed for watering violations:

First:	no fee
Second:	\$20
<i>optional audit at customer's expense in lieu of fee</i>	
Third:	\$30
Fourth:	\$40
Fifth and subsequent:	\$50

Each day that watering takes place can be a separate violation.

- ✓ Annual OSE gpcd Calculator
 - ✓ 2022 Total gpcd = 161.43
 - ✓ Meeting 2035 goal of 165 gpcd
 - ✓ 2022 SFR gpcd = 112
 - ✓ Meeting 2035 goal of 118 gpcd
- ✓ Advanced Metering Infrastructure
- ✓ Utility Hawk
- ✓ NO-DES Equipment
- ✓ Violations
- ✓ Water Restriction
 - ✓ Ordinance No. 44 – April 1914

TOP RANKINGS CITY 2001 – 2021

NUMEROUS MAGAZINES AND ORGANIZATIONS

- ✓ Best Places to Live
- ✓ Top 10 for Hispanics to Live
- ✓ Best Places to Retire
- ✓ Best Small Metro Area for Business & Careers
- ✓ Top 50 Motorcoach Destination
- ✓ Top Sports Town of Year
- ✓ Top 10 Most Overlooked City
- ✓ Most Secure Place to Live for a Medium-Sized City
- ✓ Top 10 Best Performing City
- ✓ Top 20 Towns of the Future
- ✓ Top 25 Cities for Jobs
- ✓ Runner Up for Best Sustainable Community
- ✓ Top Rankings for Best-Run City
- ✓ Tied for Number 1 for Most Charitable City
- ✓ Fittest City in New Mexico
- ✓ One of Best Cities for K-12 Teachers