

New Mexico Border Authority

Legislative Finance Committee

Project Updates

October 26, 2017

15-1040 Columbus Border Area Flood Control

- * Phase I A/B Report Draft is completed and will be released in a 11/15/17 meeting
- * Currently negotiating right-of-way donation
- * Preliminary Design: Spring 2018
- * Final Design: Fall 2018

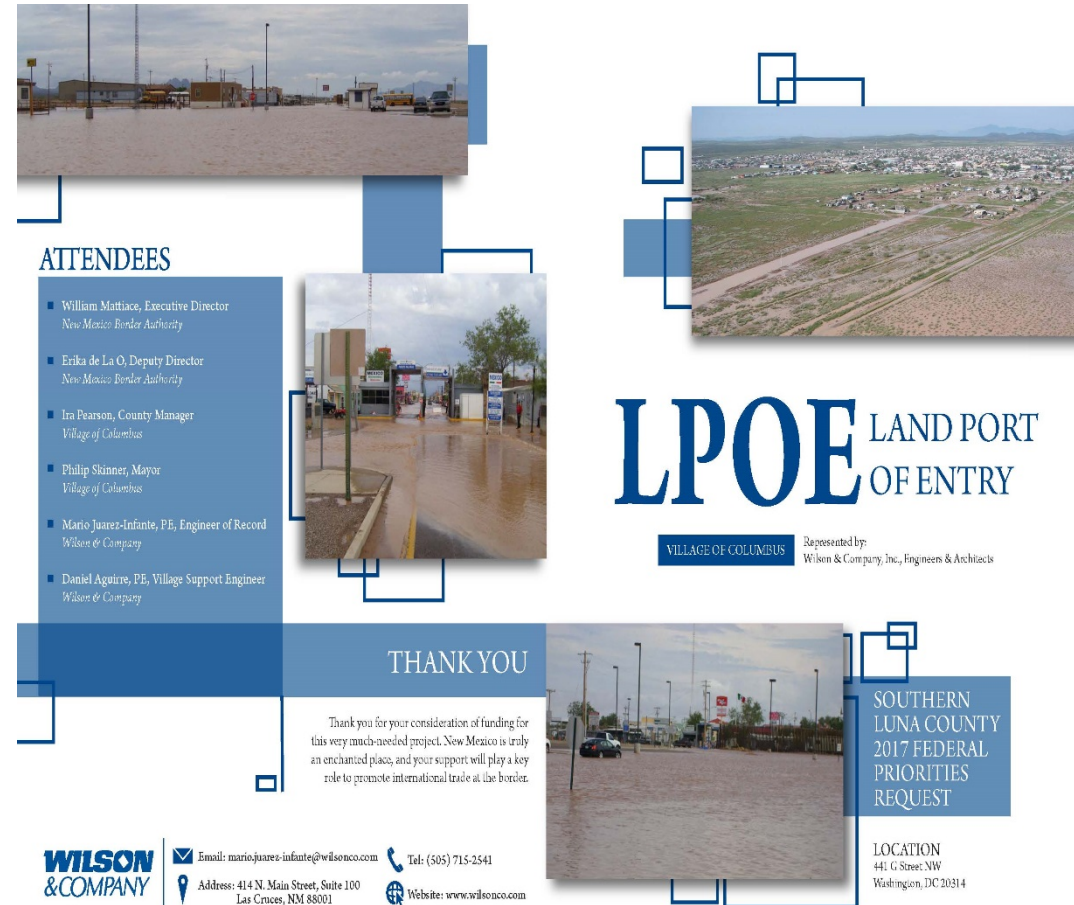

ATTENDEES

- William Mattiace, Executive Director
New Mexico Border Authority
- Erika de La O, Deputy Director
New Mexico Border Authority
- Ira Pearson, County Manager
Village of Columbus
- Philip Skinner, Mayor
Village of Columbus
- Mario Juarez-Infante, PE, Engineer of Record
Wilson & Company
- Daniel Aguirre, PE, Village Support Engineer
Wilson & Company

THANK YOU

Thank you for your consideration of funding for this very much-needed project. New Mexico is truly an enchanted place, and your support will play a key role to promote international trade at the border.

WILSON & COMPANY

Email: mario.juarez-infante@wilsonco.com Tel: (505) 715-2541
Address: 414 N. Main Street, Suite 100 Las Cruces, NM 88001 Website: www.wilsonco.com

LPOE LAND PORT OF ENTRY

VILLAGE OF COLUMBUS Represented by:
Wilson & Company, Inc., Engineers & Architects

SOUTHERN LUNA COUNTY 2017 FEDERAL PRIORITIES REQUEST

LOCATION
441 G Street, NW
Washington, DC 20314

15-1041 Columbus Port of Entry Street & Drainage Improvement - CIPF

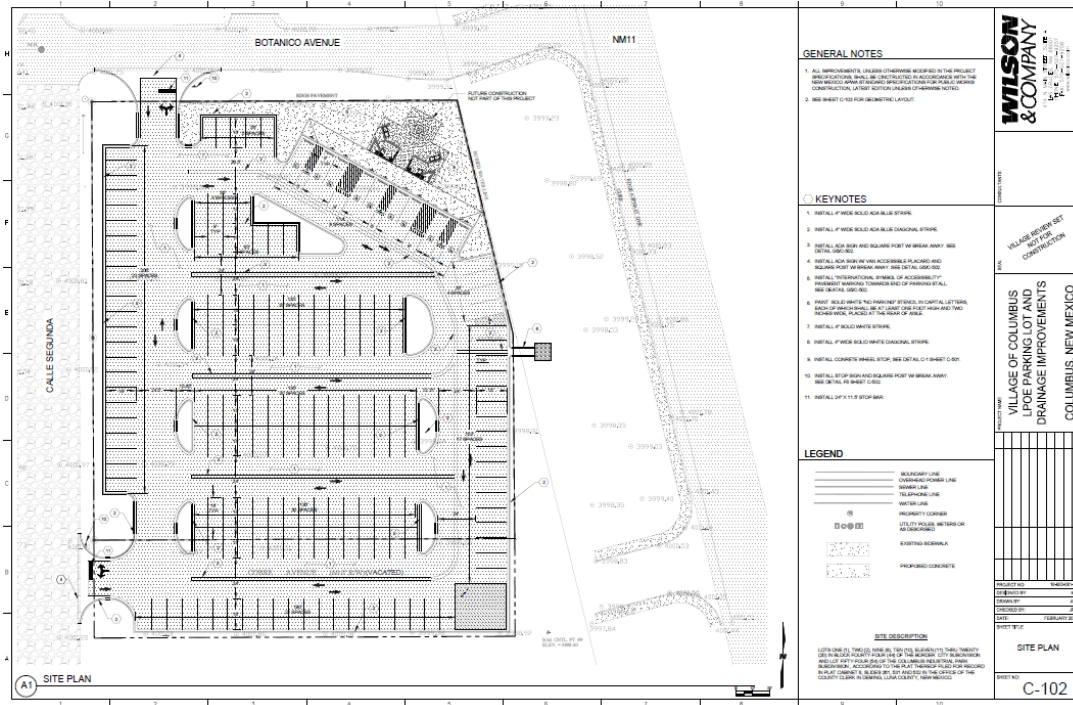

- The \$200,000 was leveraged on three projects to secure US Dept. of Commerce EDA funds:
- NM 11 Corridor Phase 1 A/B Report
- LPOE Fire Tank and Dedicated Fire Line (presented to NMFA 10.24.17)
- LPOE Parking Lot Design (working with Deming Public Schools and Luna County to secure construction funding)

A2003 Santa Teresa Border Authority Building and Site Improvements

- Conference room and office expansion
- Plans and Design funds expended
- RFP to be disseminated by December 2017
- Expect construction to begin Spring 2018

A2004 Santa Teresa Port of Entry Visitor's Center



- To accommodate Mexican Nationals by providing a resting area
- Blue prints are being finalized
- Invoicing forthcoming
- RFP to be disseminated by December 2017
- Expect construction to begin early 2018

A2624 Santa Teresa Airport Fire Station



- Expanding to be able to provide services as a HAZMAT facility
- Planning and Design feedback meeting being held today from stakeholders
- Balance of approx. \$1,000,000 plus is for construction

Santa Teresa Port of Entry Feasibility Study

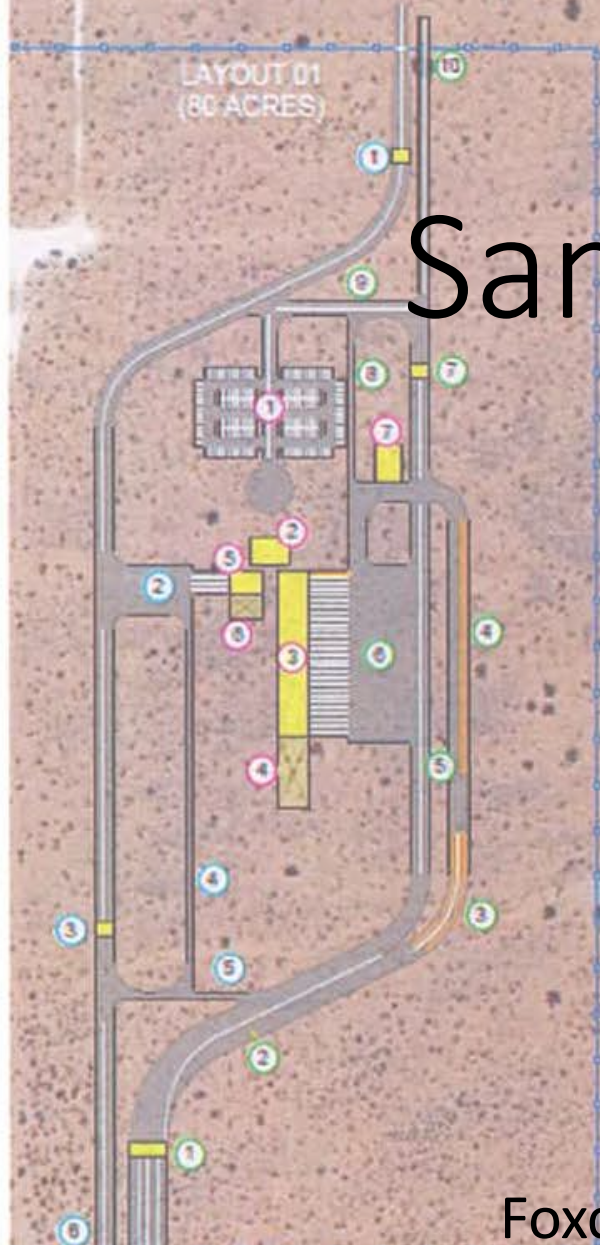

- 8. INBOUND RETURN TO P
 - 9. INBOUND RETURN TO A
 - 10. INBOUND EXIT TO HWY
- (X) COMMERCIAL OUTBOUND
- 1. OUTBOUND PRIMARY P
 - 2. OUTBOUND COMMERC
 - 3. OUTBOUND COMMERC
 - 4. OUTBOUND RETURN TO
 - 5. OUTBOUND RETURN TO
 - 6. OUTBOUND TO SAN JEE
- (X) BUILDINGS/STAFF:
- 1. STAFF BUILDING PARKING
 - 2. ADMIN/WORKY BUILDING
 - 3. INBOUND DOCKS
 - 4. FUTURE INBOUND DOCK
 - 5. OUTBOUND DOCKS
 - 6. FUTURE OUTBOUND DOCK
 - 7. HAZMAT CANOPY

Railroad Update

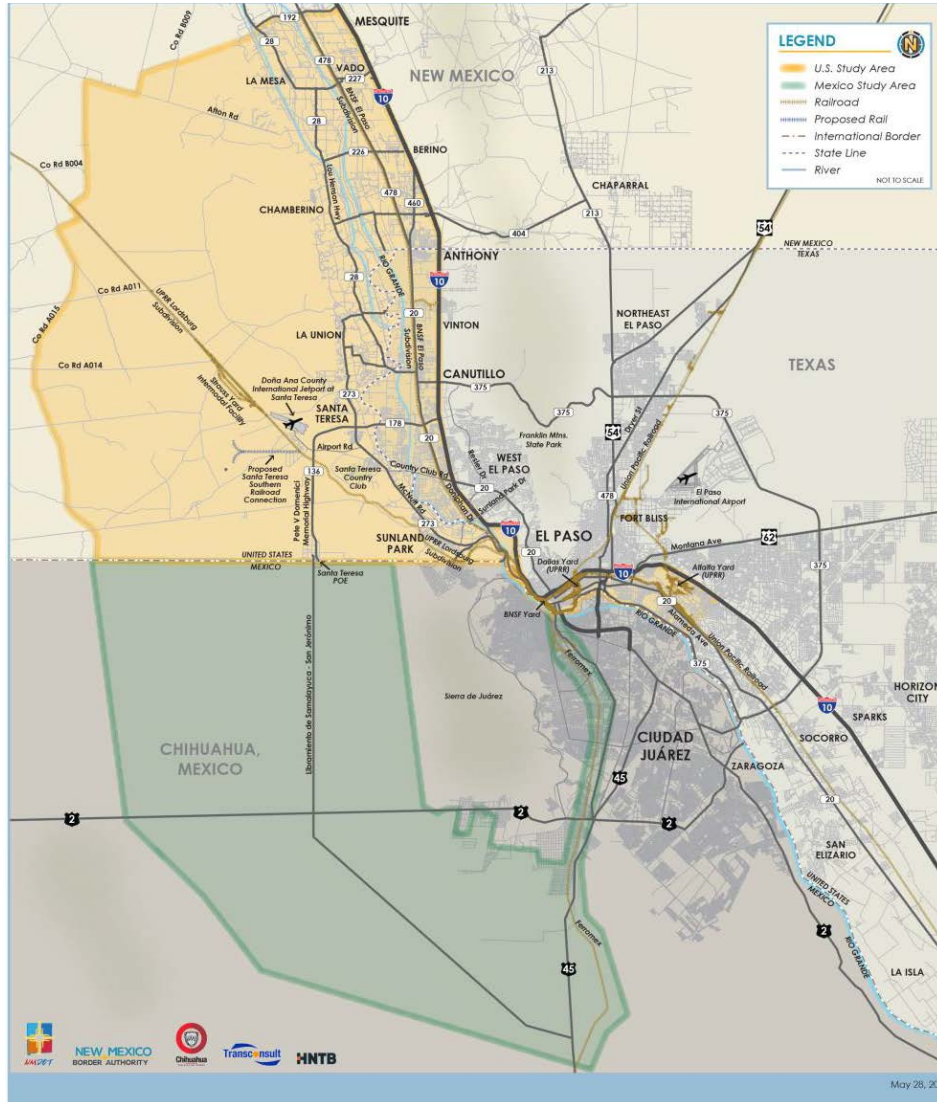

- ❑ Construct a new rail bypass between Chihuahua and New Mexico to:
 - ❑ Expedite cross-border flow of trade
 - ❑ Eliminate rail operation conflicts in urban areas of Cd. Juárez and El Paso
 - ❑ Currently conversing with the three railroads: UP, BNSF, and Ferromex