

For the New Mexico  
Legislative Council Service

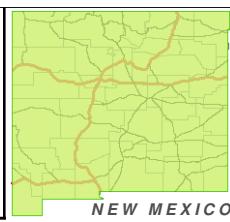

# LEGEND

Created: July 12, 2011

- Counties
- Interstate Highway
- Rivers
- US Highway

Research & Polling, Inc. distributes this map assuming no liability for any errors, omissions, or inaccuracies in the information provided regardless of the cause in reliance upon any maps.



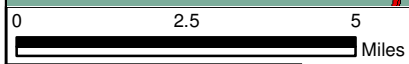
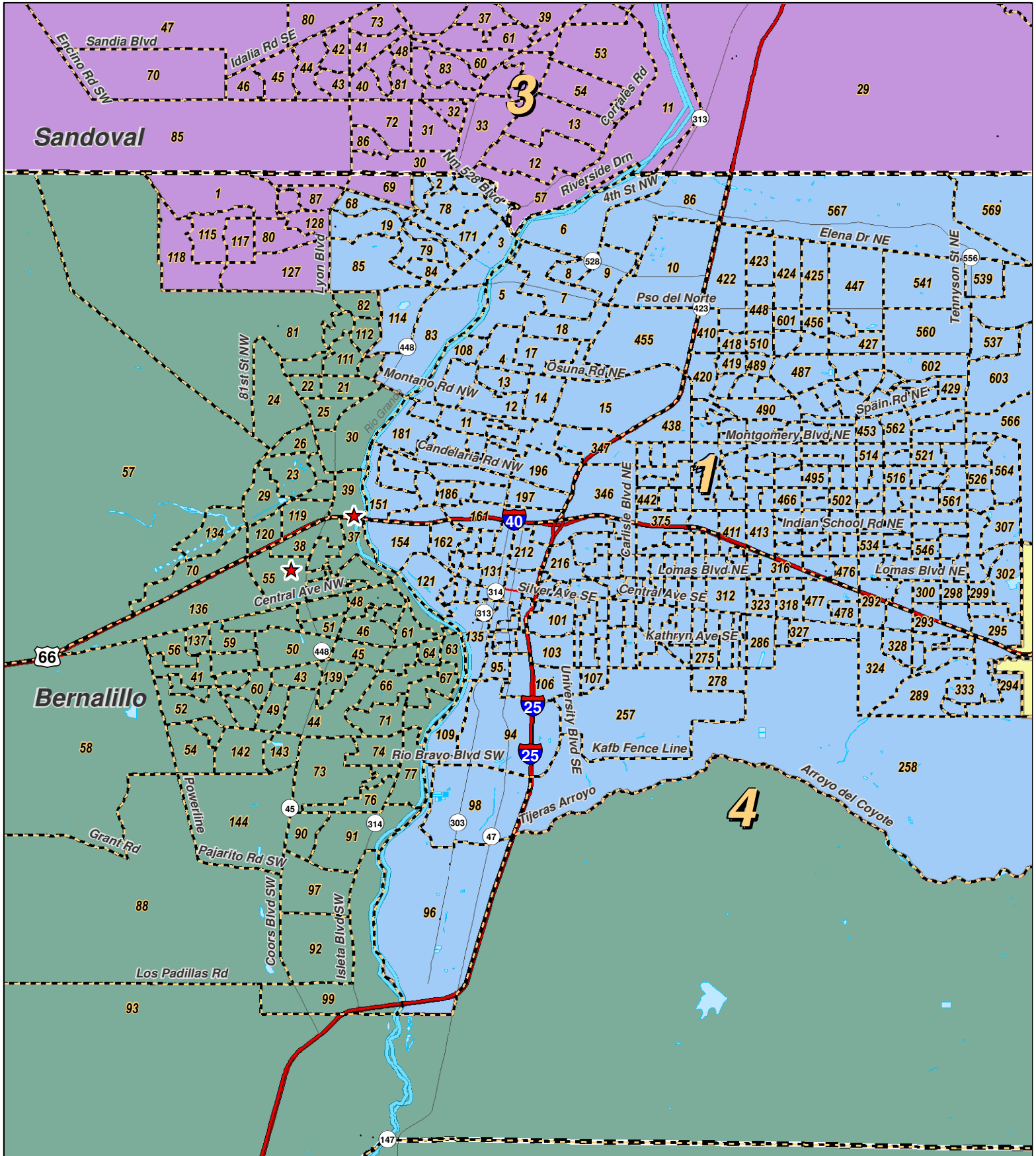

For the New Mexico  
Legislative Council Service



**LEGEND** Created: July 12, 2011

Precincts	Interstate
Counties	US Highway
Rivers	State Highway

Research & Polling, Inc. distributes this map assuming no liability for any errors, omissions, or inaccuracies in the information provided regardless of the cause in reliance upon any maps.

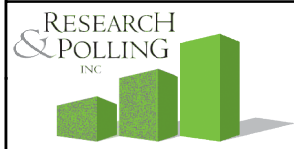
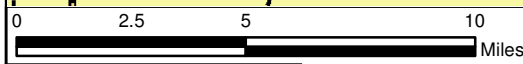
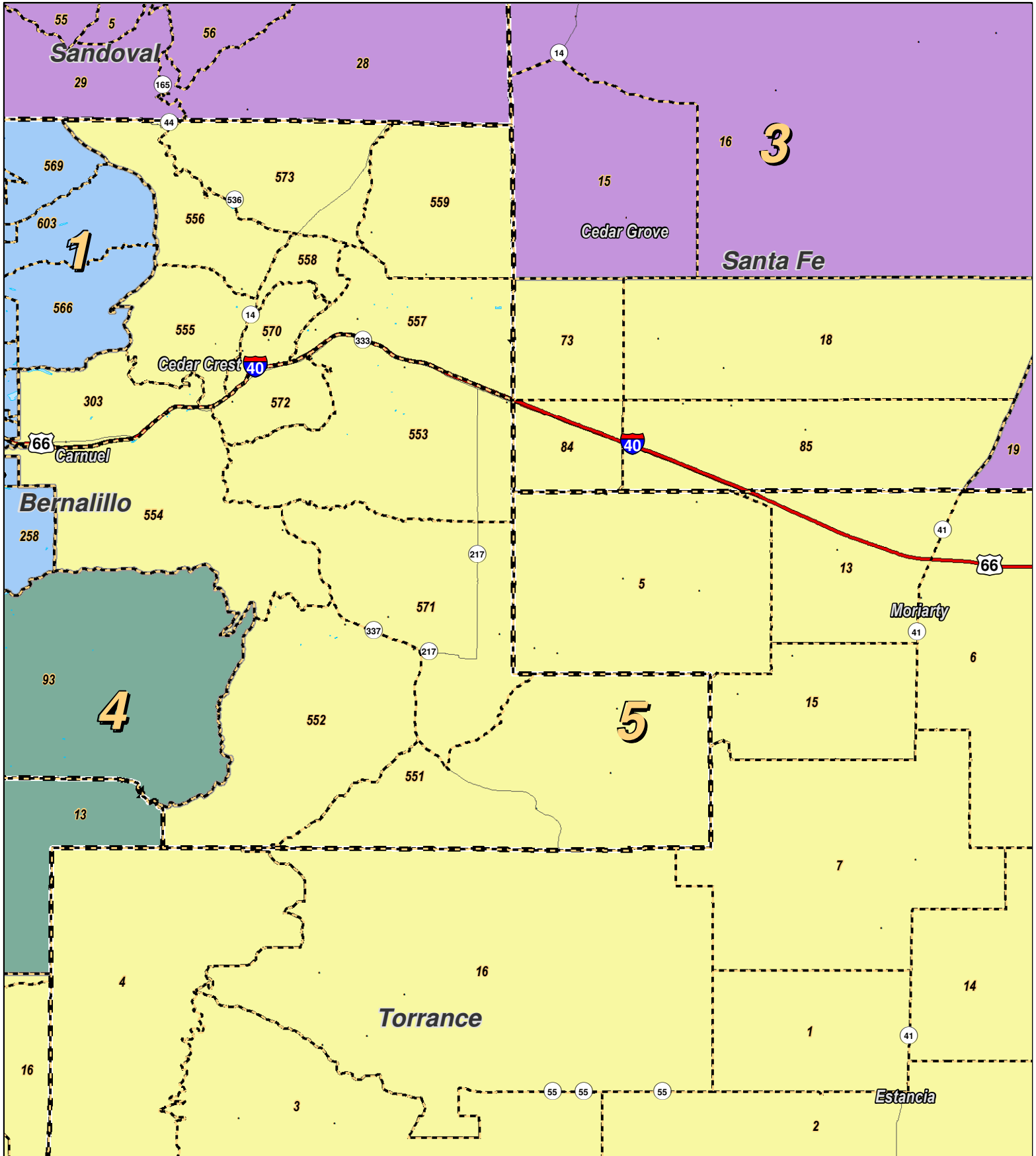

For the New Mexico  
Legislative Council Service



## LEGEND

Created: July 12, 2011

Precincts	Interstate
Counties	US Highway
Rivers	State Highway

Research & Polling, Inc. distributes this map assuming no liability for any errors, omissions, or inaccuracies in the information provided regardless of the cause in reliance upon any maps.

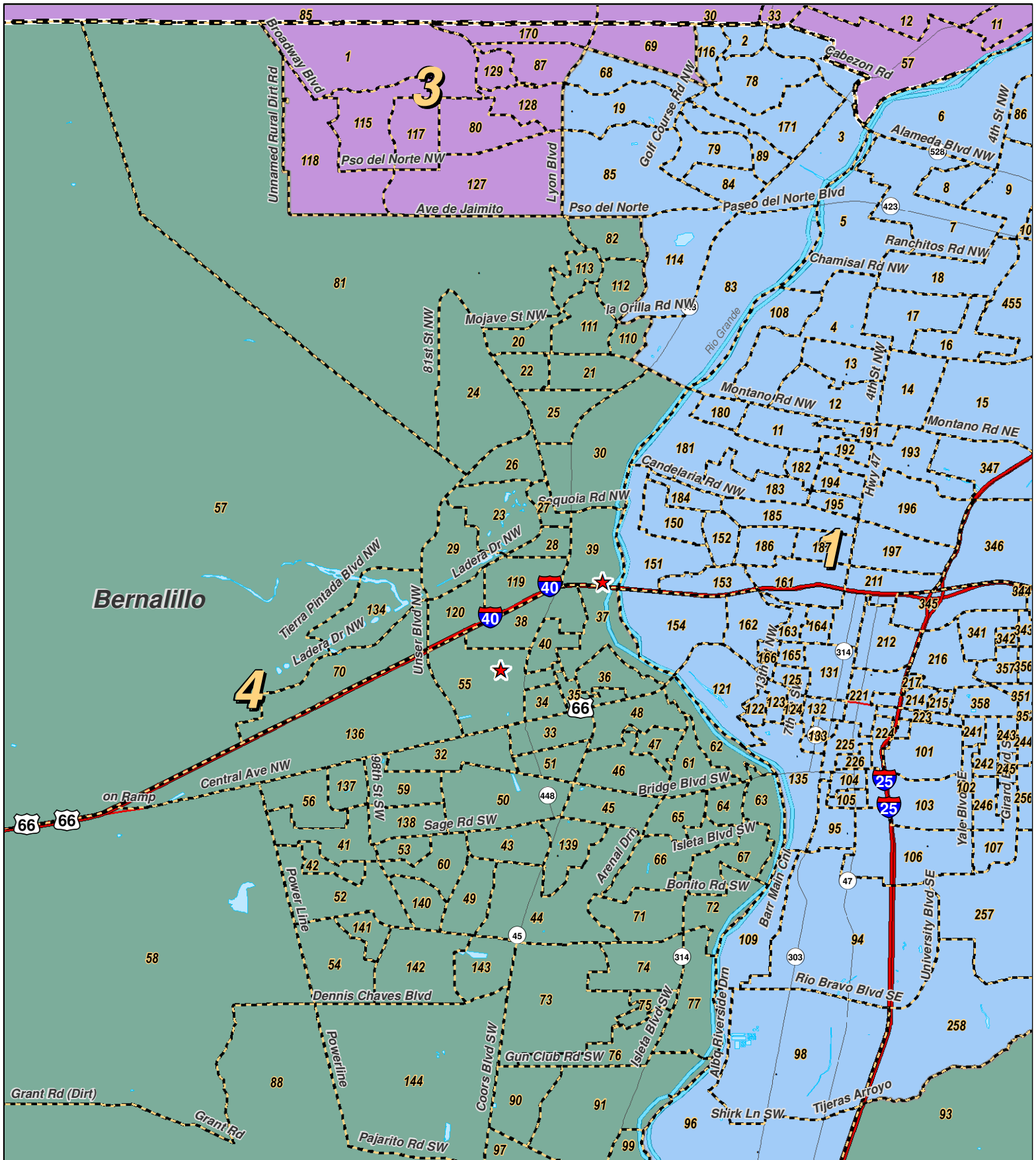

0 2.5 5 Miles

**RESEARCH & POLLING INC.**

For the New Mexico Legislative Council Service



## LEGEND

Created: July 12, 2011

- Counties
- Rivers
- Interstate
- US Highway
- State Highway

Research & Polling, Inc. distributes this map assuming no liability for any errors, omissions, or inaccuracies in the information provided regardless of the cause in reliance upon any maps.

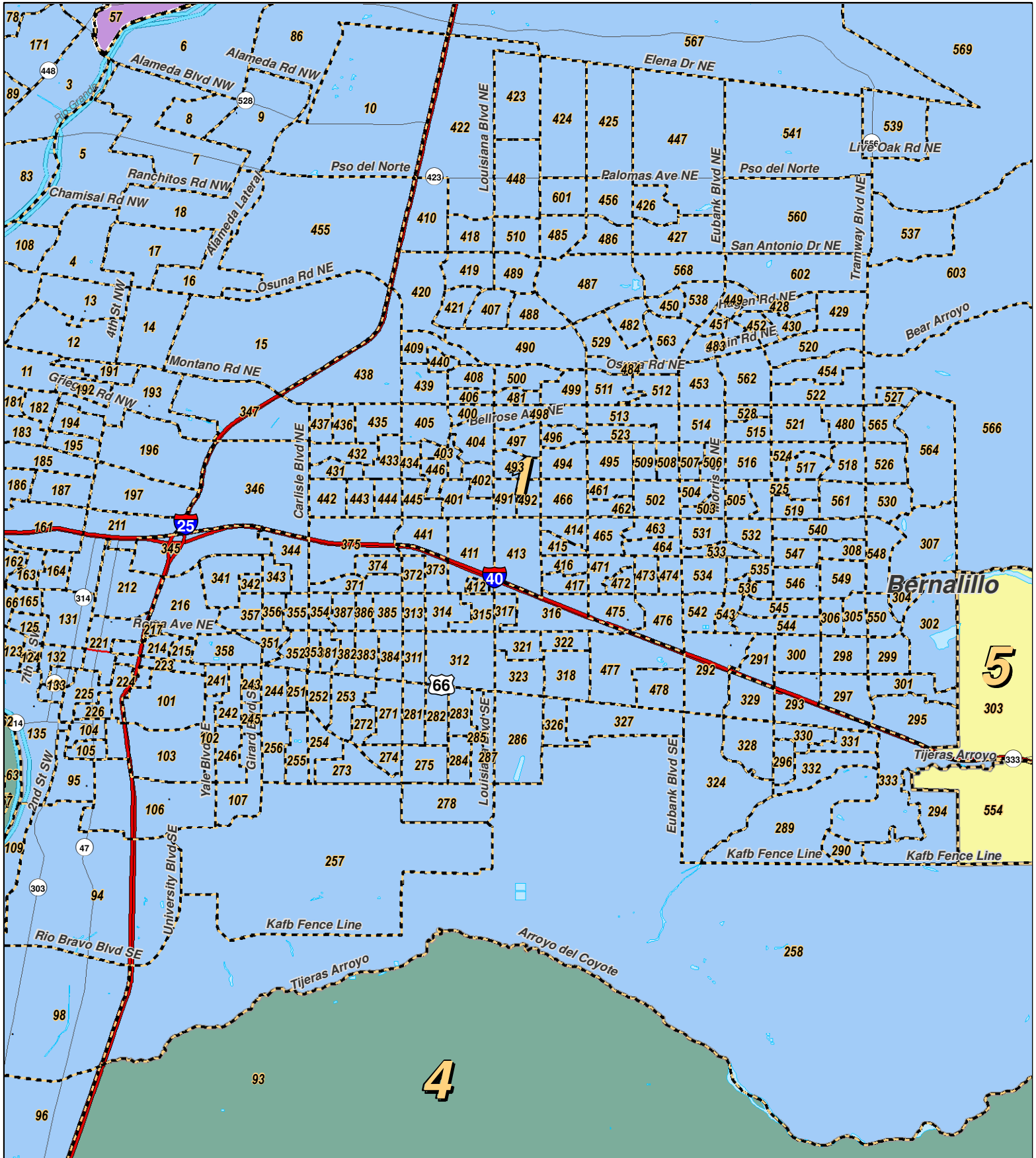

0 2.5 5 Miles

**RESEARCH & POLLING INC.**

For the New Mexico Legislative Council Service



**LEGEND** Created: July 12, 2011

- Counties
- Rivers
- Interstate
- US Highway
- State Highway

Research & Polling, Inc. distributes this map assuming no liability for any errors, omissions, or inaccuracies in the information provided regardless of the cause in reliance upon any maps.

District	Pop	Deviation	Hispanic	Non-Hispanic Origin				
				White	Native American	Black	Asian	Other Races
1	430,663	18,827 4.6%	168,441 39.1%	212,283 49.3%	16,673 3.9%	11,400 2.6%	12,283 2.9%	9,583 2.2%
18+	339,517		120,102 35.4%	182,105 53.6%	12,477 3.7%	9,011 2.7%	9,757 2.9%	6,065 1.8%
2	398,772	-13,064 -3.2%	184,281 46.2%	189,374 47.5%	6,489 1.6%	9,841 2.5%	2,896 0.7%	5,891 1.5%
18+	295,246		122,395 41.5%	154,932 52.5%	4,645 1.6%	7,414 2.5%	2,350 0.8%	3,510 1.2%
3	395,316	-16,520 -4.0%	185,256 46.9%	165,569 41.9%	27,567 7.0%	4,626 1.2%	5,294 1.3%	7,004 1.8%
18+	299,454		129,749 43.3%	138,762 46.3%	19,172 6.4%	3,501 1.2%	4,125 1.4%	4,145 1.4%
4	412,482	646 0.2%	175,280 42.5%	103,851 25.2%	118,581 28.7%	4,972 1.2%	2,722 0.7%	7,076 1.7%
18+	291,053		116,030 39.9%	84,102 28.9%	81,215 27.9%	3,871 1.3%	2,143 0.7%	3,692 1.3%
5	421,946	10,110 2.5%	240,145 56.9%	162,733 38.6%	6,058 1.4%	4,623 1.1%	3,110 0.7%	5,277 1.3%
18+	315,237		163,050 51.7%	137,947 43.8%	4,453 1.4%	3,656 1.2%	2,581 0.8%	3,550 1.1%
<b>Totals</b>	2,059,179	Ideal: 411,836	953,403 46.3%	833,810 40.5%	175,368 8.5%	35,462 1.7%	26,305 1.3%	34,831 1.3%
18+	1,540,507		651,326 42.3%	697,848 45.3%	121,962 7.9%	27,453 1.8%	20,956 1.4%	20,962 1.1%

**District Profile**

District	Total Population	Deviation		Adult Hispanic	Adult Non-Hispanic			Performance Measure		Registered Voters				
					White	Native American	Black	Dem	Rep	Total	% Dem	% Rep	% DTS	% Other
1	430,663	18,827	4.6%	35.4%	53.6%	3.7%	2.7%	53.2%	46.8%	313,754	46.0%	33.6%	16.9%	3.5%
2	398,772	-13,064	-3.2%	41.5%	52.5%	1.6%	2.5%	40.2%	59.8%	201,407	42.1%	42.2%	14.2%	1.5%
3	395,316	-16,520	-4.0%	43.3%	46.3%	6.4%	1.2%	63.2%	36.8%	241,342	58.5%	23.5%	15.0%	3.0%
4	412,482	646	0.2%	39.9%	28.9%	27.9%	1.3%	54.6%	45.4%	174,884	50.5%	30.4%	16.2%	2.9%
5	421,946	10,110	2.5%	51.7%	43.8%	1.4%	1.2%	51.2%	48.8%	228,775	49.7%	30.5%	16.9%	3.0%
<b>New Mexico</b>	2,059,179			42.3%	45.3%	7.9%	1.8%	53.0%	47.0%	1,160,162	49.3%	31.9%	15.9%	2.9%



**NM PRC: Concept E**

## District Definitions by County and Precinct

Section 8-7-6 NMSA 1978 (being Laws 2001 (1st S.S.), Chapter 3, Section 3) is repealed and a new Section 8-7-6 NMSA 1978 is enacted to read:

"[NEW MATERIAL] PUBLIC REGULATION COMMISSION DISTRICT ONE.--Public regulation commission district one is composed of Bernalillo county precincts 2 through 19, 68, 78, 79, 83 through 86, 89, 94 through 96, 98, 101 through 109, 114, 116, 121 through 125, 131 through 133, 135, 150 through 154, 161 through 166, 171, 180 through 187, 191 through 197, 211, 212, 214 through 217, 221, 223 through 226, 241 through 246, 251 through 258, 271 through 275, 278, 281 through 287, 289 through 302, 304 through 308, 311 through 318, 321 through 324, 326 through 333, 341 through 347, 351 through 358, 371 through 375, 381 through 387, 400 through 456, 461 through 466, 471 through 478, 480 through 500, 502 through 550, 560 through 569 and 601 through 603."

Section 8-7-7 NMSA 1978 (being Laws 2001 (1st S.S.), Chapter 3, Section 4) is repealed and a new Section 8-7-7 NMSA 1978 is enacted to read:

"[NEW MATERIAL] PUBLIC REGULATION COMMISSION DISTRICT TWO.--Public regulation commission district two is composed of Chaves county; Colfax county; Curry county; De Baca county; Eddy county; Guadalupe county; Harding county; Lea county; Lincoln county; Mora county; Otero county; Quay county; Roosevelt county; San Miguel county precincts 1 through 17 and 25 through 28; and Union county."

Section 8-7-8 NMSA 1978 (being Laws 2001 (1st S.S.), Chapter 3, Section 5) is repealed and a new Section 8-7-8 NMSA 1978 is enacted to read:

"[NEW MATERIAL] PUBLIC REGULATION COMMISSION DISTRICT THREE.--Public regulation commission district three is composed of Bernalillo county precincts 1, 69, 80, 87, 115, 117, 118, 127 through 129 and 170; Los Alamos county; Rio Arriba county; San Miguel county precincts 18 through 24; Sandoval county; Santa Fe county precincts 1 through 17, 19 through 72, 74 through 83 and 86 through 88; and Taos county."

Section 8-7-9 NMSA 1978 (being Laws 2001 (1st S.S.), Chapter 3, Section 6) is repealed and a new Section 8-7-9 NMSA 1978 is enacted to read:

"[NEW MATERIAL] PUBLIC REGULATION COMMISSION DISTRICT FOUR.--Public regulation commission district four is composed of Bernalillo county precincts 20 through 67, 70 through 77, 81, 82, 88, 90 through 93, 97, 99, 110 through 113, 119, 120, 134 and 136 through 144; Cibola county; McKinley county; San Juan county; and Valencia county precinct 13."

Section 8-7-10 NMSA 1978 (being Laws 2001 (1st S.S.), Chapter 3, Section 7) is repealed and a new Section 8-7-10 NMSA 1978 is enacted to read:

"[NEW MATERIAL] PUBLIC REGULATION COMMISSION DISTRICT FIVE.--Public regulation commission district five is composed of Bernalillo county precincts 303, 551 through 559 and 570 through 573; Catron county; Dona Ana county; Grant county; Hidalgo county; Luna county; Santa Fe county precincts 18, 73, 84 and 85; Sierra county; Socorro county; Torrance county; and Valencia county precincts 1 through 12 and 14 through 41."