

For the New Mexico Legislative Council Service

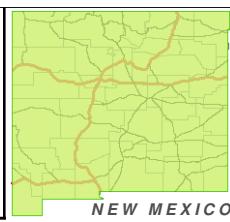

LEGEND Created: September 17, 2011

- Counties
- Interstate Highway
- Rivers
- US Highway

Research & Polling, Inc. distributes this map assuming no liability for any errors, omissions, or inaccuracies in the information provided regardless of the cause in reliance upon any maps.

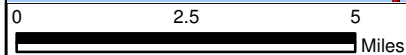
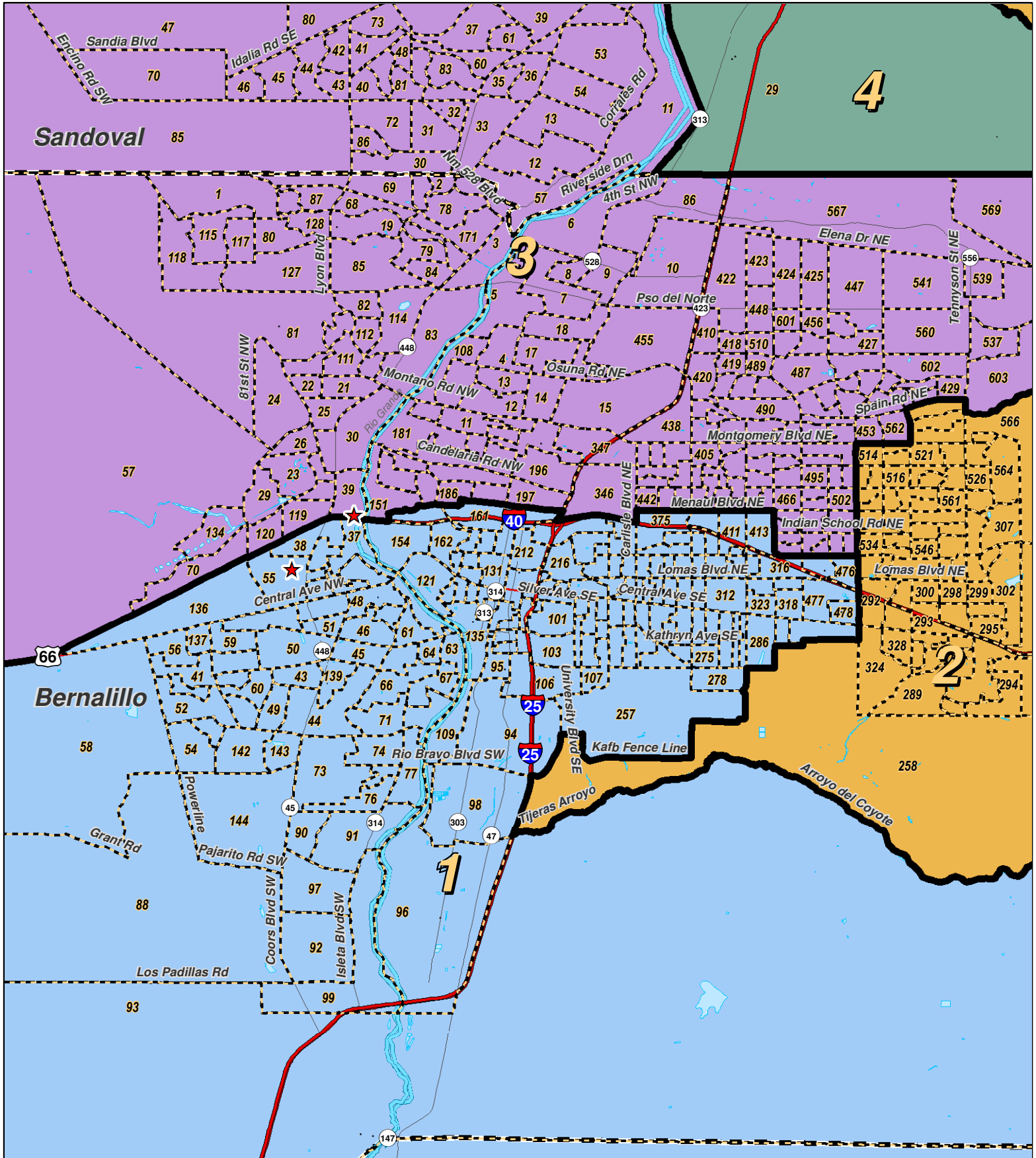

For the New Mexico Legislative Council Service



LEGEND Created: September 17, 2011

- Precincts
- Counties
- Interstate
- US Highway

Research & Polling, Inc. distributes this map assuming no liability for any errors, omissions, State highway provided regardless of the cause in reliance upon any maps.

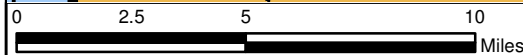
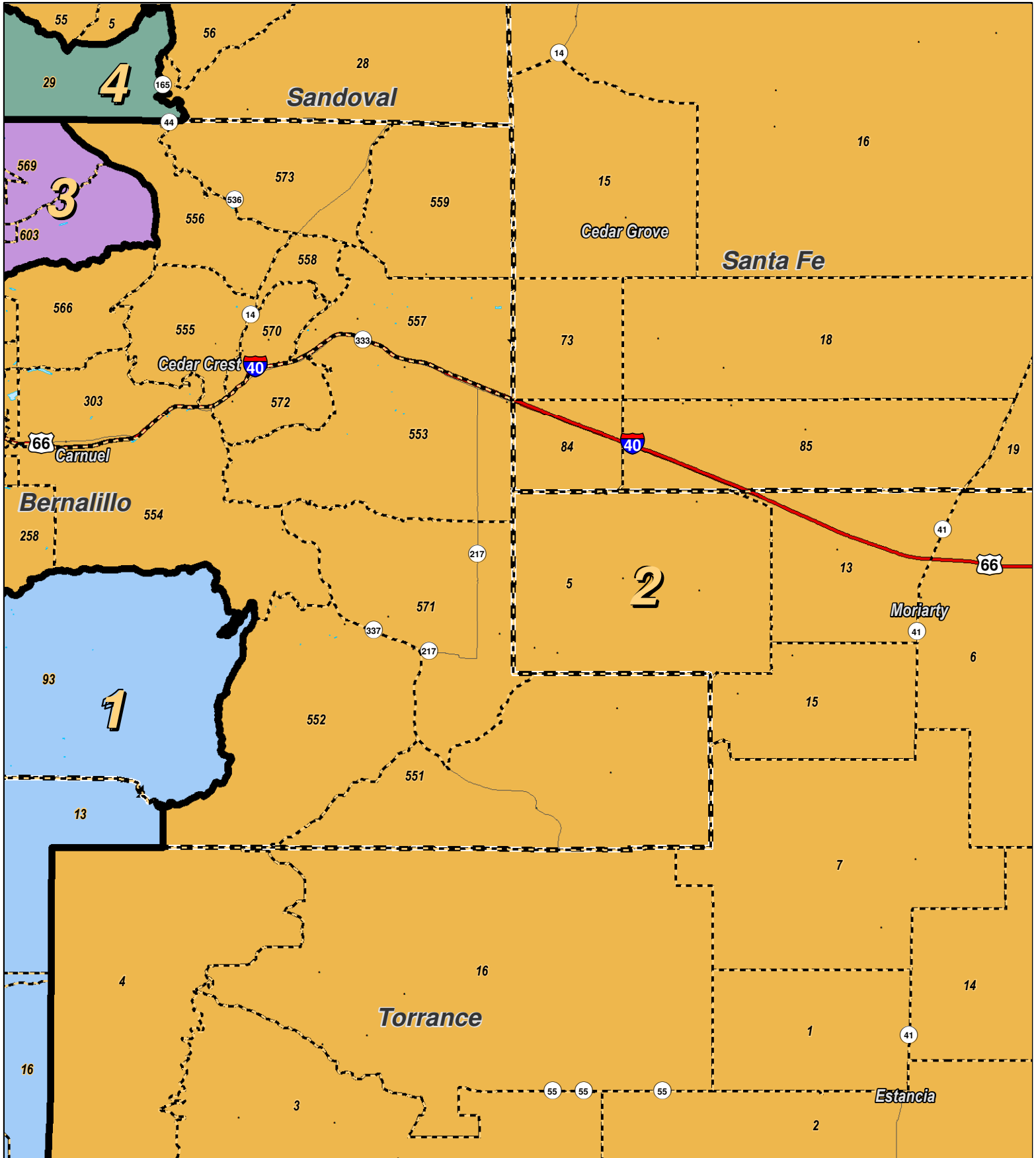

For the New Mexico Legislative Council Service



LEGEND Created: September 17, 2011

- Precincts
- Counties
- Interstate
- US Highway

Research & Polling, Inc. distributes this map assuming no liability for any errors, omissions, or inaccuracies in the information provided regardless of the cause in reliance upon any maps.

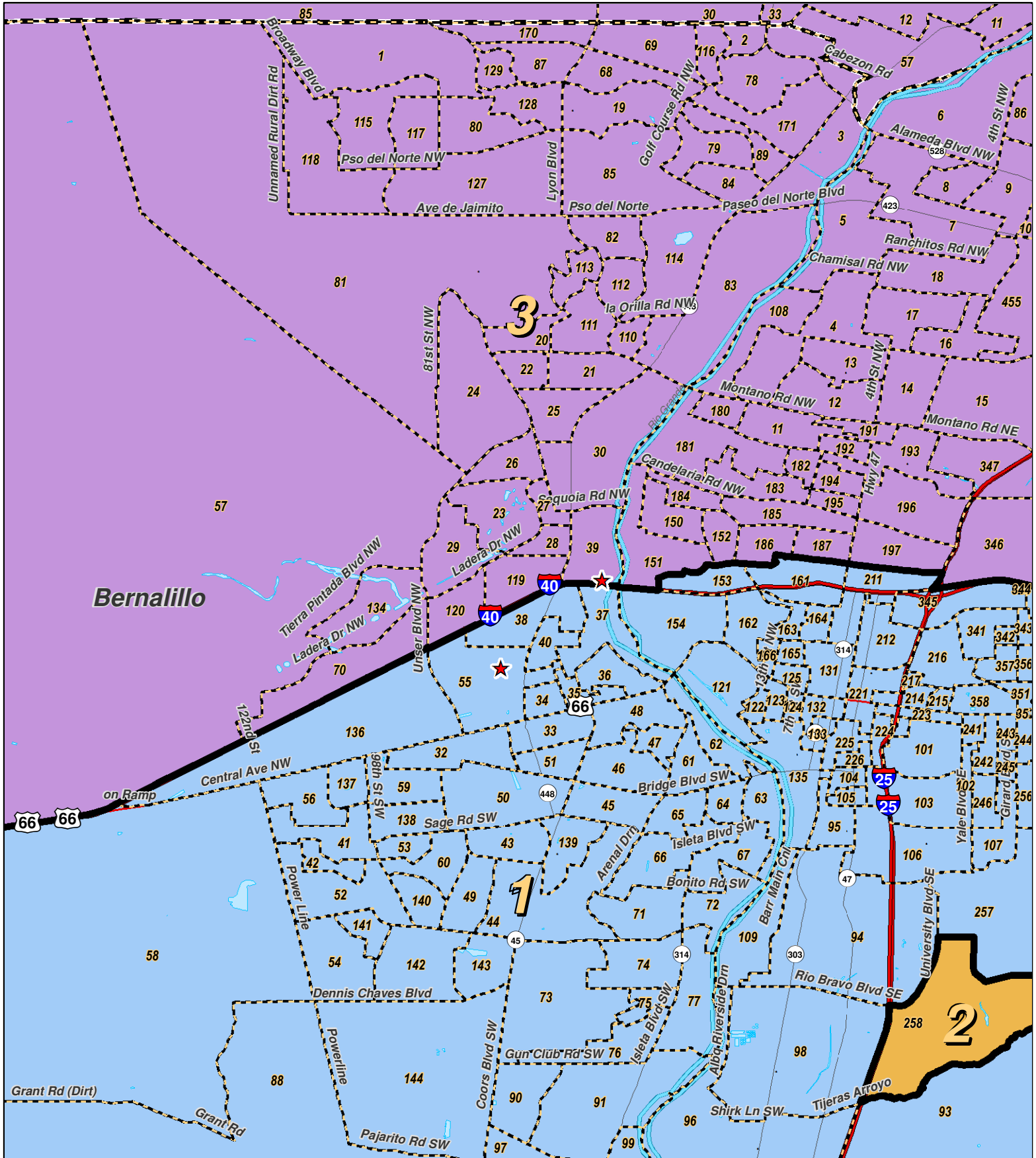

0 2.5 5 Miles

RESEARCH & POLLING INC.

For the New Mexico Legislative Council Service



LEGEND Created: September 17, 2011

- Counties
- Rivers
- Interstate
- US Highway
- State Highway

Research & Polling, Inc. distributes this map assuming no liability for any errors, omissions, or inaccuracies in the information provided regardless of the cause in reliance upon any maps.

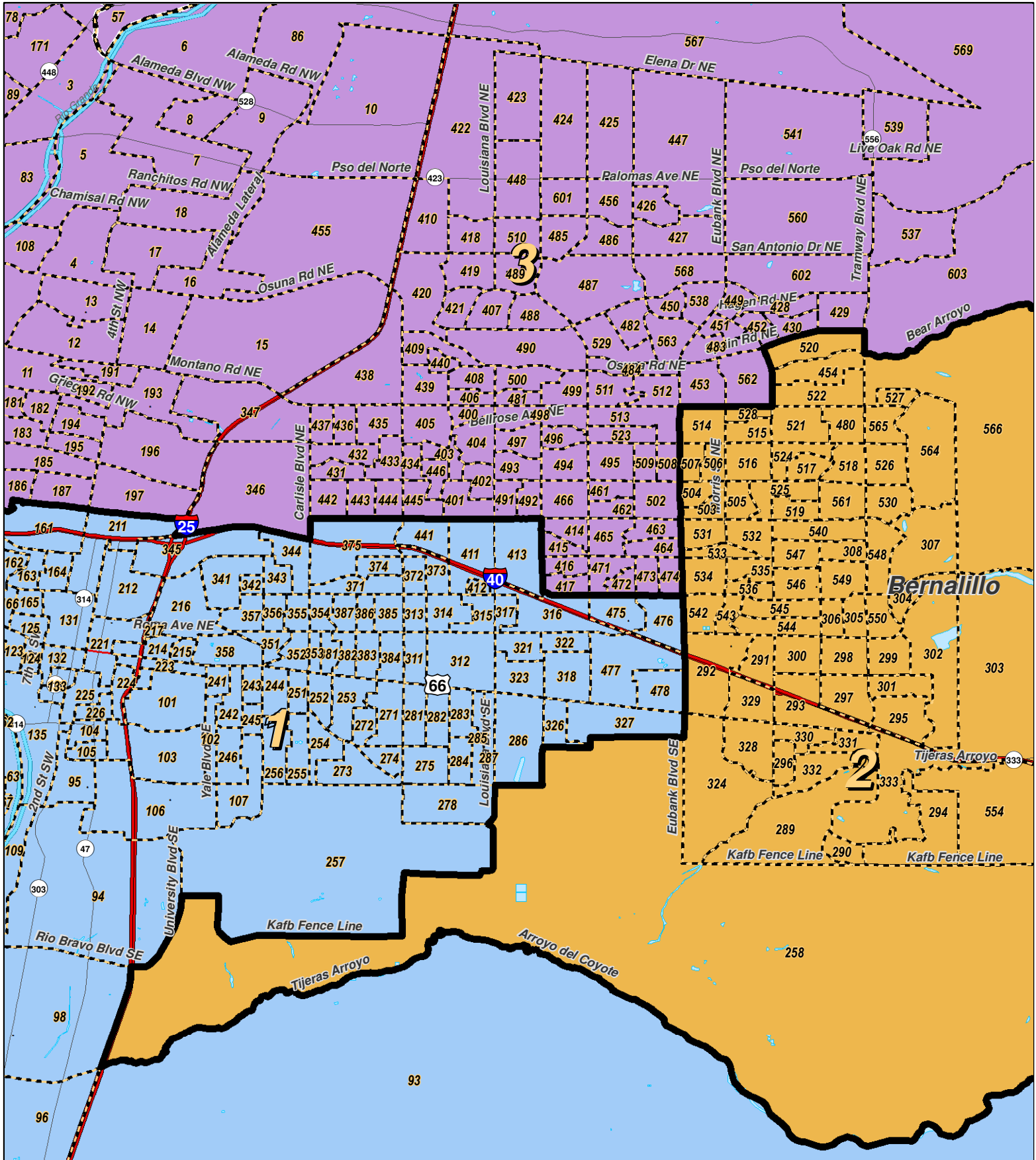

0 2.5 5 Miles

RESEARCH & POLLING INC.

For the New Mexico Legislative Council Service



LEGEND Created: September 17, 2011

- Counties
- Rivers
- Interstate
- US Highway

Research & Polling, Inc. distributes this map assuming no liability for any errors, omissions, or inaccuracies in the information provided regardless of the cause in reliance upon any maps.

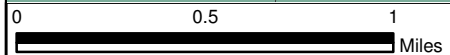
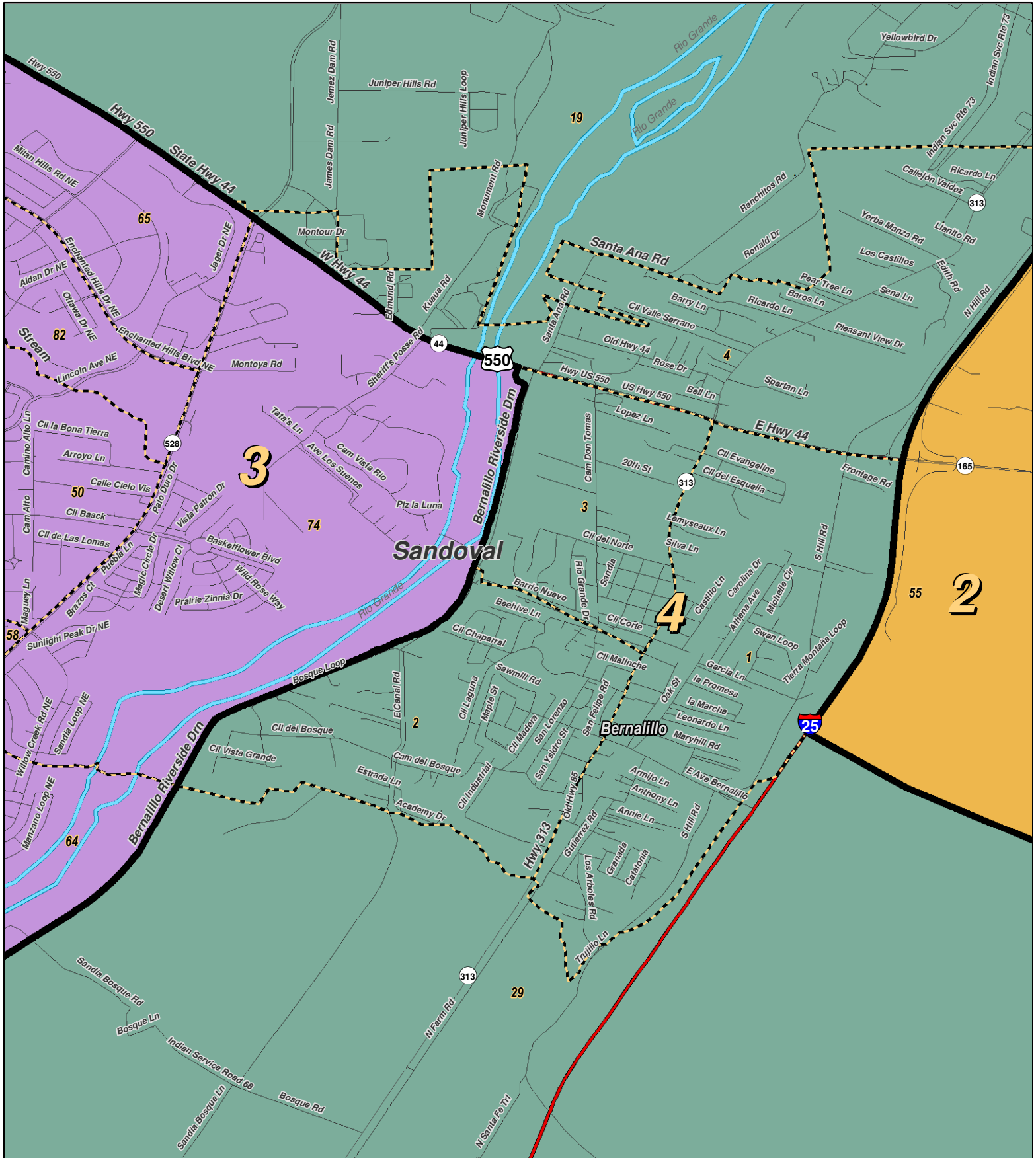

For the New Mexico
Legislative Council Service



LEGEND Created: September 17, 2011

- Counties
- Interstate
- Rivers
- US Highway

Research & Polling, Inc. distributes this map assuming no liability for any errors, omissions, or inaccuracies in the information provided regardless of the cause in reliance upon any maps.

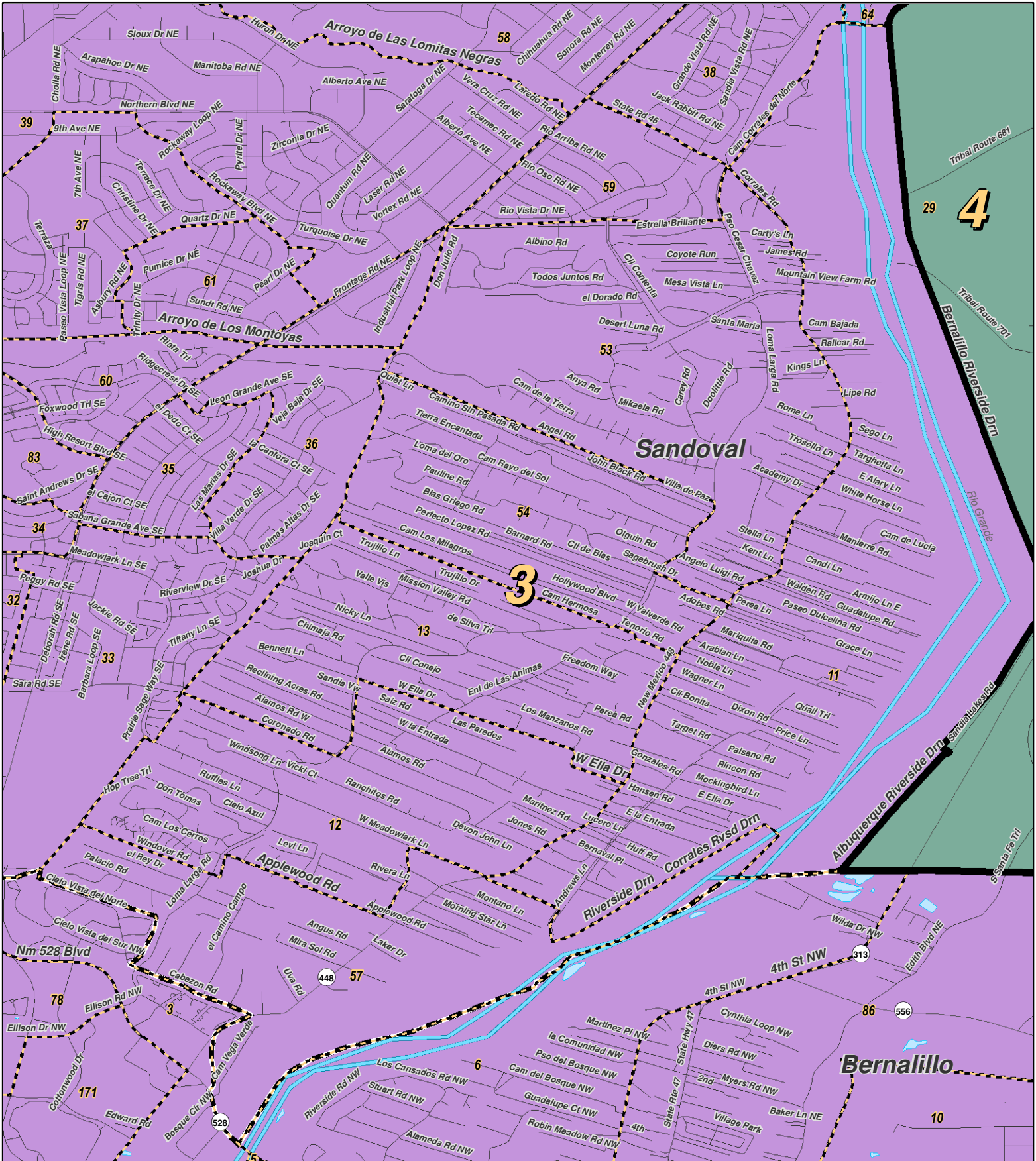

0 1 2 Miles

RESEARCH & POLLING INC.

For the New Mexico Legislative Council Service



LEGEND Created: September 17, 2011

- Counties
- Rivers
- Interstate
- US Highway

Research & Polling, Inc. distributes this map assuming no liability for any errors, omissions, or inaccuracies in the information provided regardless of the cause in reliance upon any maps.

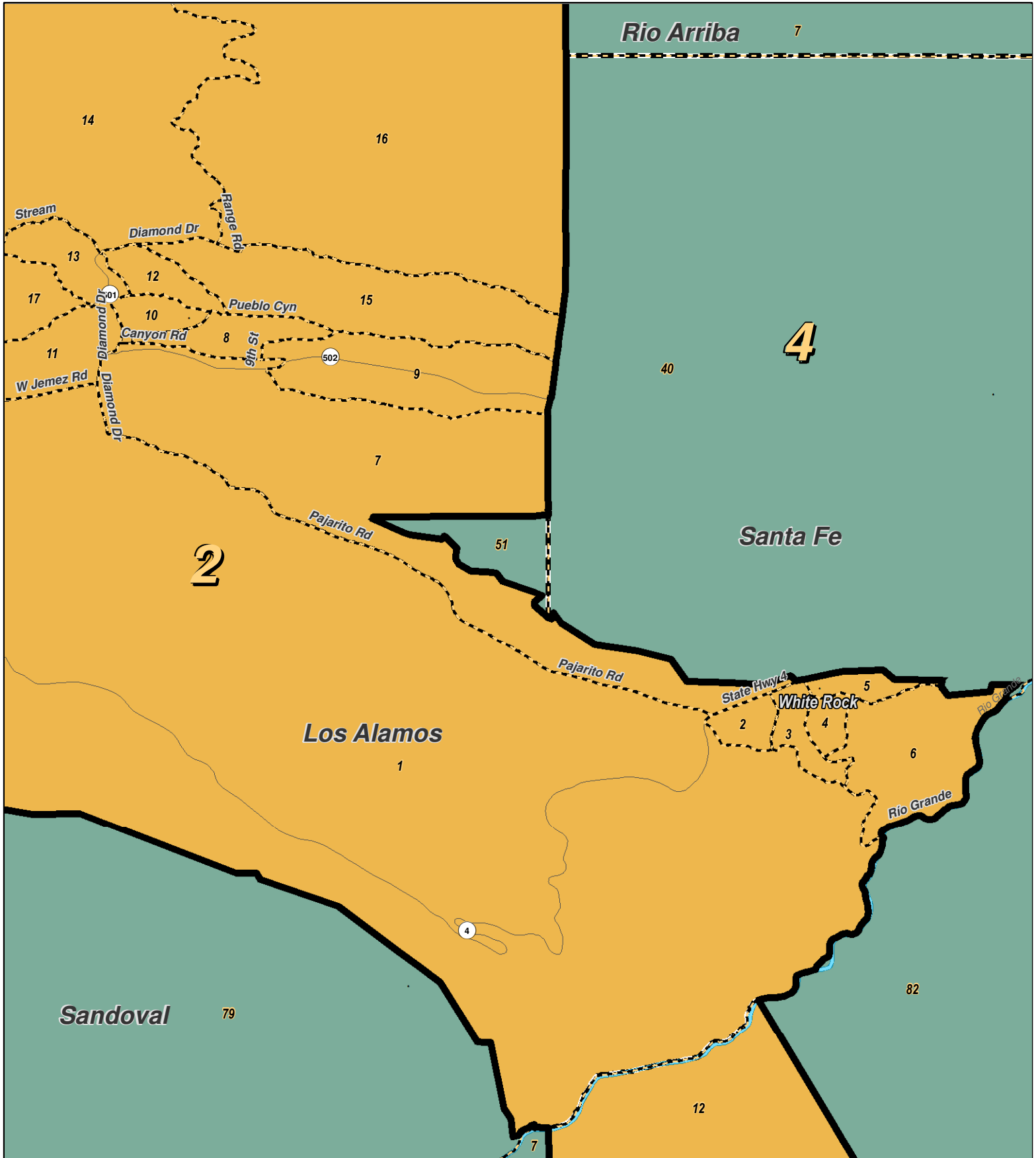

0 2 4 Miles

RESEARCH & POLLING
INC.

For the New Mexico
Legislative Council Service



LEGEND Created: September 17, 2011

Counties	Interstate
Rivers	US Highway
State Highway	

Research & Polling, Inc. distributes this map assuming no liability for any errors, omissions, or inaccuracies in the information provided regardless of the cause in reliance upon any maps.

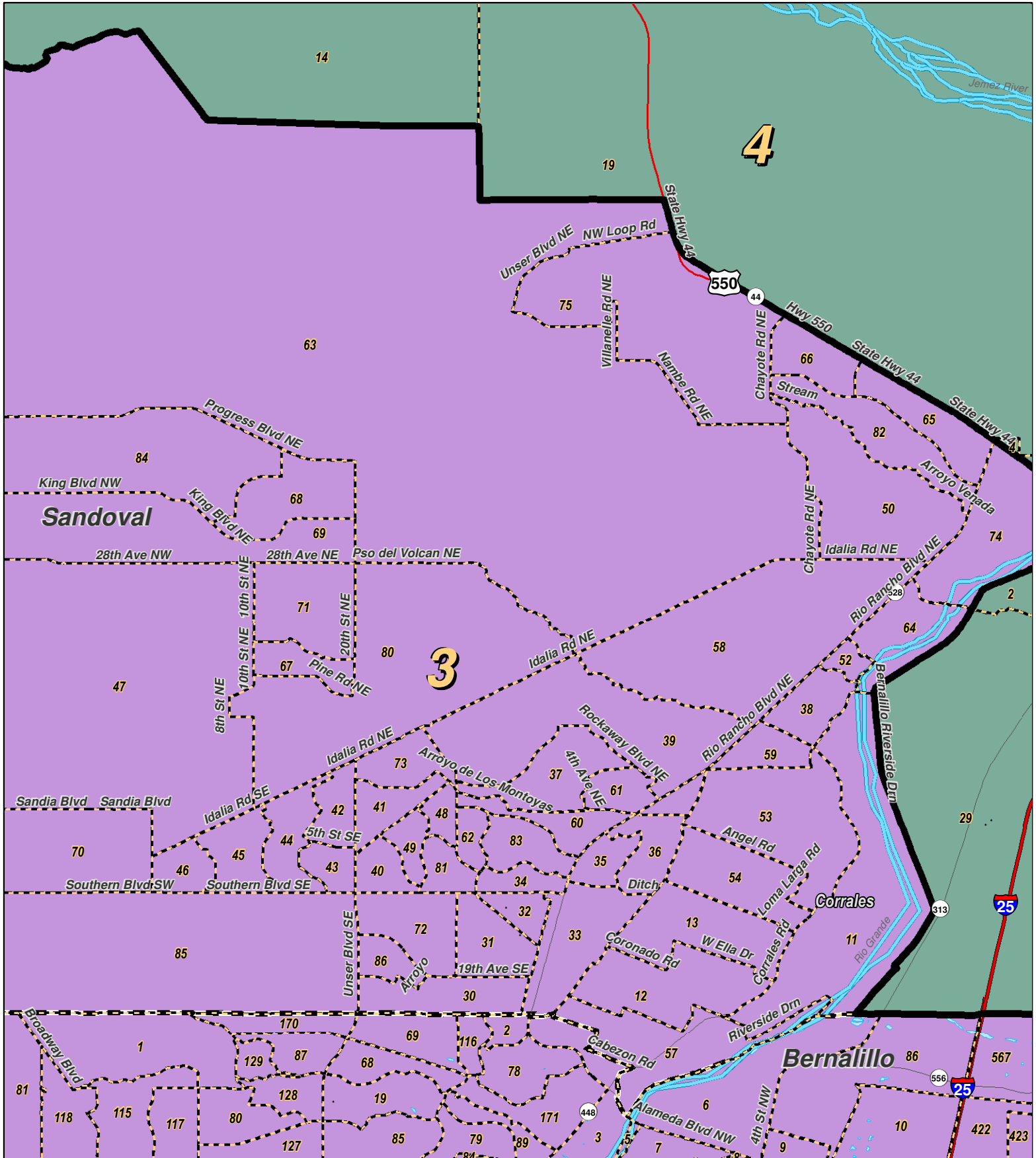

0 2.5 5 Miles

RESEARCH & POLLING INC.

For the New Mexico Legislative Council Service



LEGEND Created: September 17, 2011

- Counties
- Rivers
- Interstate
- US Highway

Research & Polling, Inc. distributes this map assuming no liability for any errors, omissions, or inaccuracies in the information provided regardless of the cause in reliance upon any maps.

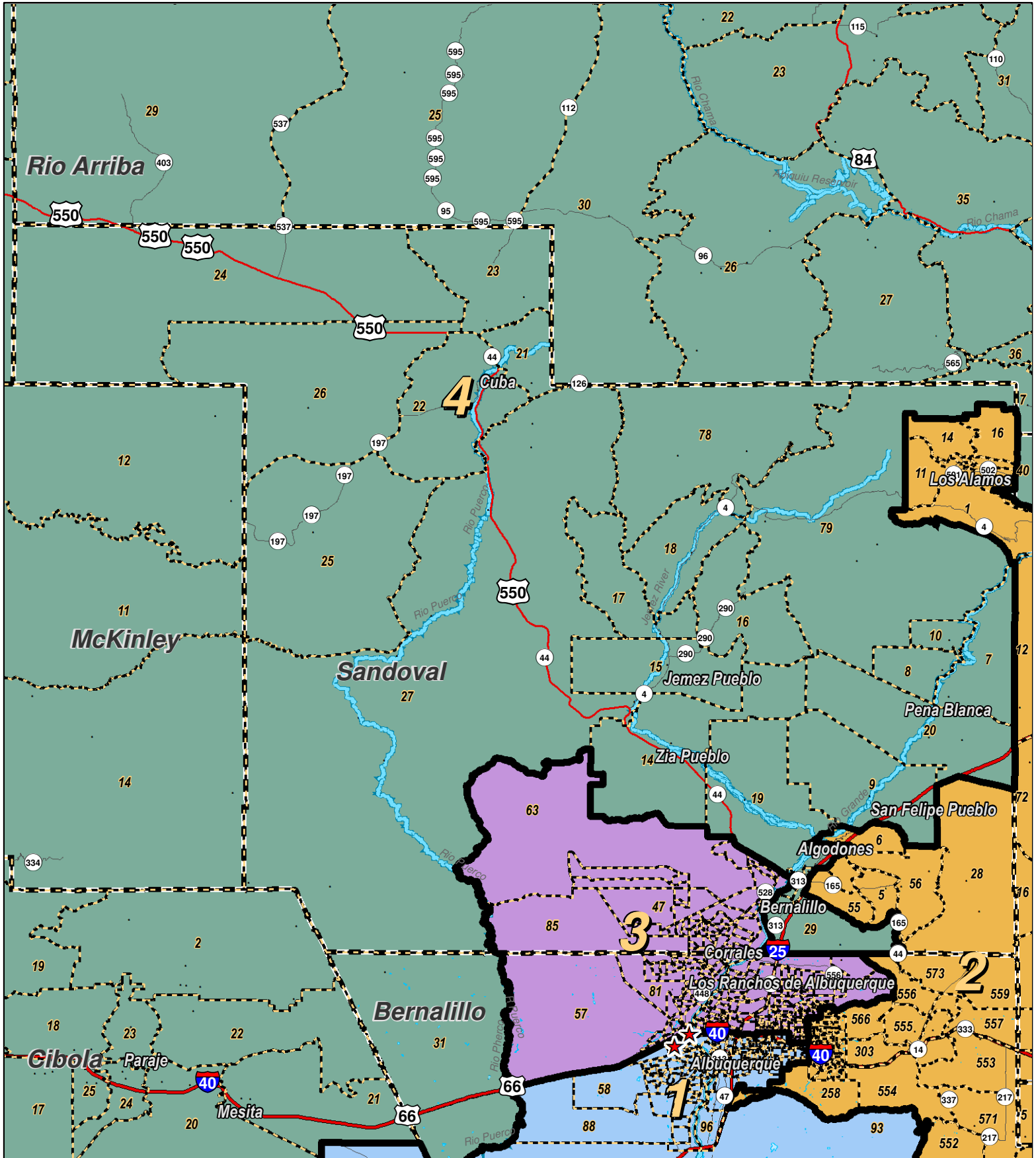

RESEARCH & POLLING INC.

For the New Mexico Legislative Council Service



LEGEND Created: September 17, 2011

- Precincts
- Counties
- Interstate
- US Highway

Research & Polling, Inc. distributes this map assuming no liability for any errors, omissions, or inaccuracies in the information provided regardless of the cause in reliance upon any maps.

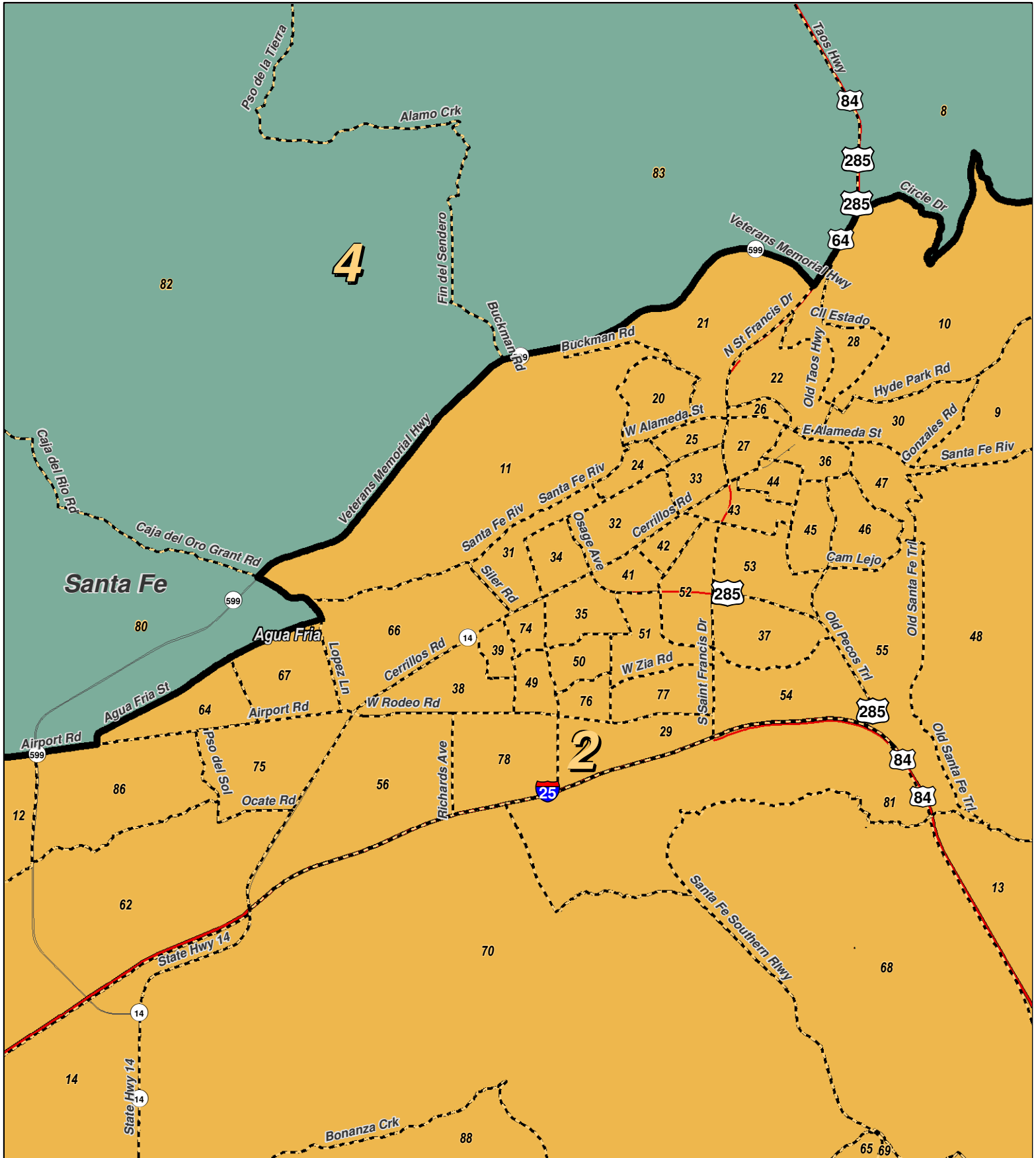

0 2.5 5 Miles

RESEARCH & POLLING
INC.

For the New Mexico
Legislative Council Service



LEGEND Created: September 17, 2011

	Counties		Interstate
	Rivers		US Highway

Research & Polling, Inc. distributes this map assuming no liability for any errors, omissions, or inaccuracies in the information provided regardless of the cause in reliance upon any maps.

District	Pop	Deviation	Hispanic	Non-Hispanic Origin				
				White	Native American	Black	Asian	Other Races
1	423,794	11,958 2.9%	254,922 60.2%	135,745 32.0%	14,372 3.4%	7,941 1.9%	4,320 1.0%	6,494 1.5%
18+	317,294		174,256 54.9%	117,683 37.1%	10,892 3.4%	6,386 2.0%	3,696 1.2%	4,381 1.4%
2	432,175	20,339 4.9%	174,765 40.4%	226,738 52.5%	6,762 1.6%	8,807 2.0%	7,290 1.7%	7,813 1.8%
18+	331,098		118,968 35.9%	189,978 57.4%	5,106 1.5%	6,647 2.0%	5,680 1.7%	4,719 1.4%
3	394,375	-17,461 -4.2%	155,369 39.4%	199,251 50.5%	12,687 3.2%	8,973 2.3%	9,356 2.4%	8,739 2.2%
18+	298,474		106,415 35.7%	163,756 54.9%	9,243 3.1%	6,874 2.3%	7,199 2.4%	4,987 1.7%
4	406,109	-5,727 -1.4%	149,759 36.9%	111,046 27.3%	135,034 33.3%	1,894 0.5%	1,923 0.5%	6,453 1.6%
18+	297,419		106,508 35.8%	92,171 31.0%	92,095 31.0%	1,515 0.5%	1,561 0.5%	3,569 1.2%
5	402,726	-9,110 -2.2%	218,588 54.3%	161,030 40.0%	6,513 1.6%	7,847 1.9%	3,416 0.8%	5,332 1.3%
18+	296,222		145,179 49.0%	134,260 45.3%	4,626 1.6%	6,031 2.0%	2,820 1.0%	3,306 1.1%
Totals	2,059,179	Ideal: 411,836	953,403 46.3%	833,810 40.5%	175,368 8.5%	35,462 1.7%	26,305 1.3%	34,831 1.3%
18+	1,540,507		651,326 42.3%	697,848 45.3%	121,962 7.9%	27,453 1.8%	20,956 1.4%	20,962 1.1%

District Profile

District	Total Population	Deviation		Total Adult Native American	Adult Hispanic	Adult Non-Hispanic			Performance Measure		Registered Voters				
						White	American	Black	Dem	Rep	Total	% Dem	% Rep	% DTS	% Other
1	423,794	11,958	2.9%	5.4%	54.9%	37.1%	3.4%	2.0%	60.8%	39.2%	226,972	54.4%	24.6%	17.4%	3.5%
2	432,175	20,339	4.9%	3.0%	35.9%	57.4%	1.5%	2.0%	50.8%	49.2%	255,703	46.5%	35.1%	15.8%	2.6%
3	394,375	-17,461	-4.2%	4.7%	35.7%	54.9%	3.1%	2.3%	47.7%	52.3%	251,338	42.6%	38.7%	15.2%	3.5%
4	406,109	-5,727	-1.4%	33.2%	35.8%	31.0%	31.0%	0.5%	60.7%	39.3%	229,960	59.7%	24.2%	13.8%	2.3%
5	402,726	-9,110	-2.2%	3.0%	49.0%	45.3%	1.6%	2.0%	45.0%	55.0%	195,242	43.4%	36.6%	17.7%	2.2%
NM	2,059,179	Ideal: 411,836		9.6%	42.3%	45.3%	7.9%	1.8%	53.0%	47.0%	1,159,215	49.3%	31.9%	15.9%	2.9%

NM Public Regulation Commission: PRC_187512.1

District Definitions by County and Precinct

PUBLIC REGULATION COMMISSION DISTRICT ONE.-- Public regulation commission district one is composed of Bernalillo county precincts 32 through 38, 40 through 56, 58 through 67, 71 through 77, 88, 90 through 99, 101 through 107, 109, 121 through 125, 131 through 133, 135 through 144, 153, 154, 161 through 166, 211, 212, 214 through 217, 221, 223 through 226, 241 through 246, 251 through 257, 271 through 275, 278, 281 through 287, 311 through 318, 321 through 323, 326, 327, 341 through 345, 351 through 358, 371 through 375, 381 through 387, 411 through 413, 441 and 475 through 478; Catron county; Grant county; Hidalgo county; Luna county; Sierra county; Socorro county precincts 1 through 14 and 16 through 26; and Valencia county."

PUBLIC REGULATION COMMISSION DISTRICT TWO.-- Public regulation commission district two is composed of Bernalillo county precincts 258, 289 through 308, 324, 328 through 333, 454, 480, 503 through 507, 514 through 522, 524 through 528, 530 through 536, 540, 542 through 559, 561, 564 through 566 and 570 through 573; Chaves county precincts 1 through 7, 9 through 16, 21 through 25, 31 through 36, 41 through 47, 51, 52, 61 through 63, 71 through 73, 81 through 85, 90 through 94 and 101 through 103; Curry county; De Baca county; Guadalupe county; Lea county precincts 2, 3, 10 and 13; Lincoln county precincts 1 through 3, 13, 15, 16 and 19; Los Alamos county; Quay county; Roosevelt county; Sandoval county precincts 5, 6, 28, 55, 56 and 76; Santa Fe county precincts 9 through 22, 24 through 39, 41 through 57, 62 through 78, 81, 84 through 86 and 88; Torrance county; and Union county."

PUBLIC REGULATION COMMISSION DISTRICT THREE.-- Public regulation commission district three is composed of Bernalillo county precincts 1 through 30, 39, 57, 68 through 70, 78 through 87, 89, 108, 110 through 120, 127 through 129, 134, 150 through 152, 170, 171, 180 through 187, 191 through 197, 346, 347, 400 through 410, 414 through 440, 442 through 453, 455, 456, 461 through 466, 471 through 474, 481 through 500, 502, 508 through 513, 523, 529, 537 through 539, 541, 560, 562, 563, 567 through 569 and 601 through 603; and Sandoval county precincts 11 through 13, 30 through 50, 52 through 54, 57 through 75 and 80 through 86."

PUBLIC REGULATION COMMISSION DISTRICT FOUR.-- Public regulation commission district four is composed of Bernalillo county precinct 31; Cibola county; Colfax county; Harding county; McKinley county; Mora county; Rio Arriba county; San Juan county; San Miguel county; Sandoval county precincts 1 through 4, 7 through 10, 14 through 27, 29, 51, 78 and 79; Santa Fe county precincts 1 through 8, 23, 40, 58 through 61, 79, 80, 82, 83 and 87; Socorro county precinct 15; and Taos county."

PUBLIC REGULATION COMMISSION DISTRICT FIVE.-- Public regulation commission district five is composed of Chaves county precinct 104; Dona Ana county; Eddy county; Lea county precincts 11, 12, 14 through 18, 20 through 36, 41 through 44, 51 through 55, 61, 62 and 71 through 74; Lincoln county precincts 4 through 12, 14, 17, 18, 20 and 21; and Otero county."