

Burrell College of Osteopathic Medicine *at New Mexico State University*



George Mychaskiw II, DO, FAAP, FACOP
Founding Dean and Chief Academic Officer



The Burrell College of Osteopathic Medicine is a free standing, privately funded, separately licensed and independently operated entity. It is not part of New Mexico State University



Para la gente y el futuro: For the people and the future, the Burrell College of Osteopathic Medicine at New Mexico State University (BCOM) is dedicated to improving the health of the Southwestern United States and Northern Mexico through culturally competent undergraduate, graduate and continuing osteopathic medical education, research and clinical service to the community.

BCOM is focused on increasing diversity in the physician workforce and fostering a practice of life-long learning, compassion, respect and excellence in its students.



Construction and Facilities



The Burrell College of Osteopathic Medicine is a free standing, privately funded, separately licensed and independently operated entity. It is not part of New Mexico State University



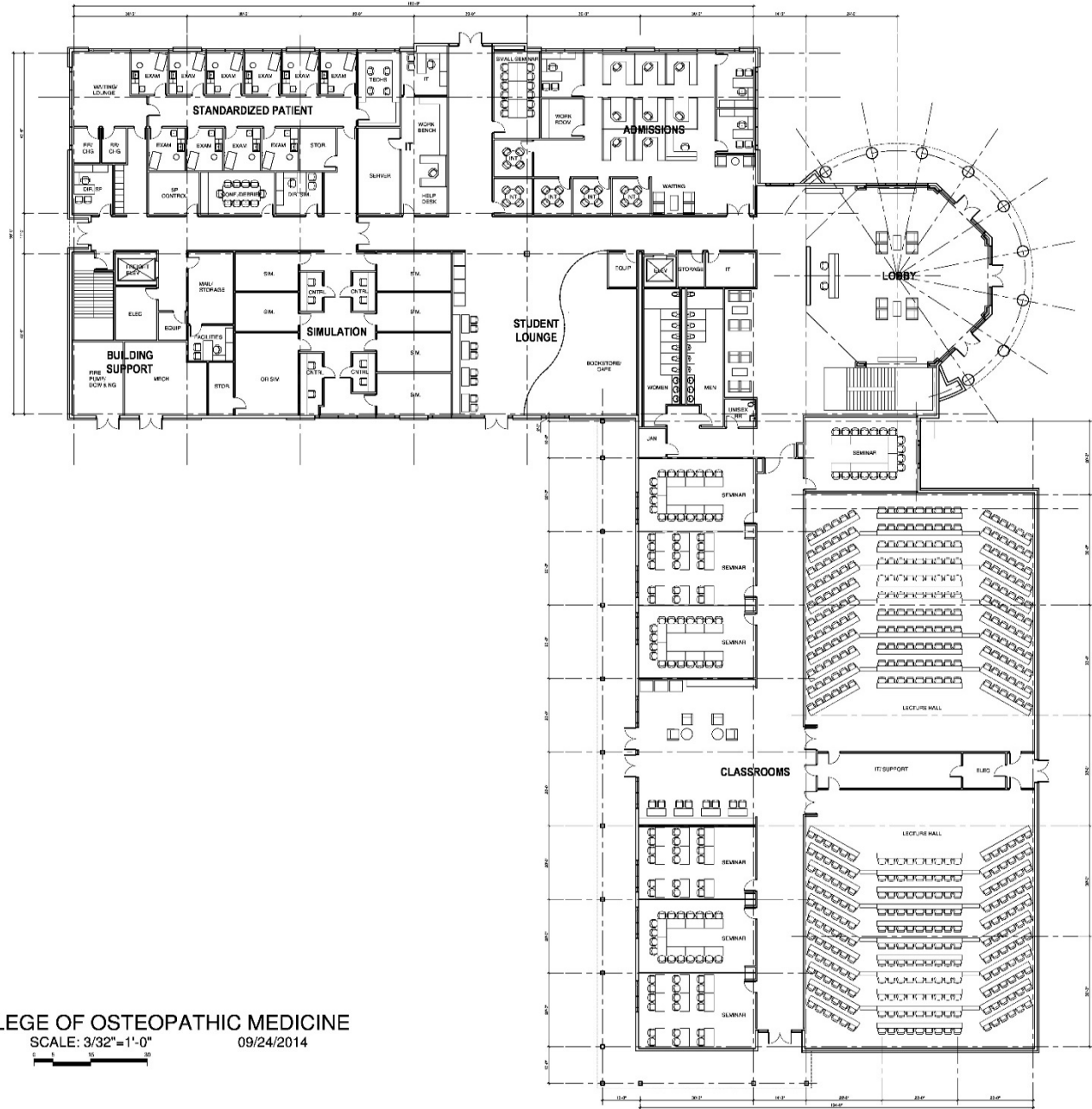

BURRELL COLLEGE OF OSTEOPATHIC MEDICINE
 FIRST FLOOR SCALE: 3/32"=1'-0" 09/24/2014



ARCHITECTURE / DESIGN / INSPIRATION

**DEKKER
 PERICH
 SABATINI**

7601 JEFFERSON NE, SUITE 100
 ALBUQUERQUE, NM 87109
 505.761.9703 / DPSDESIGN.ORG



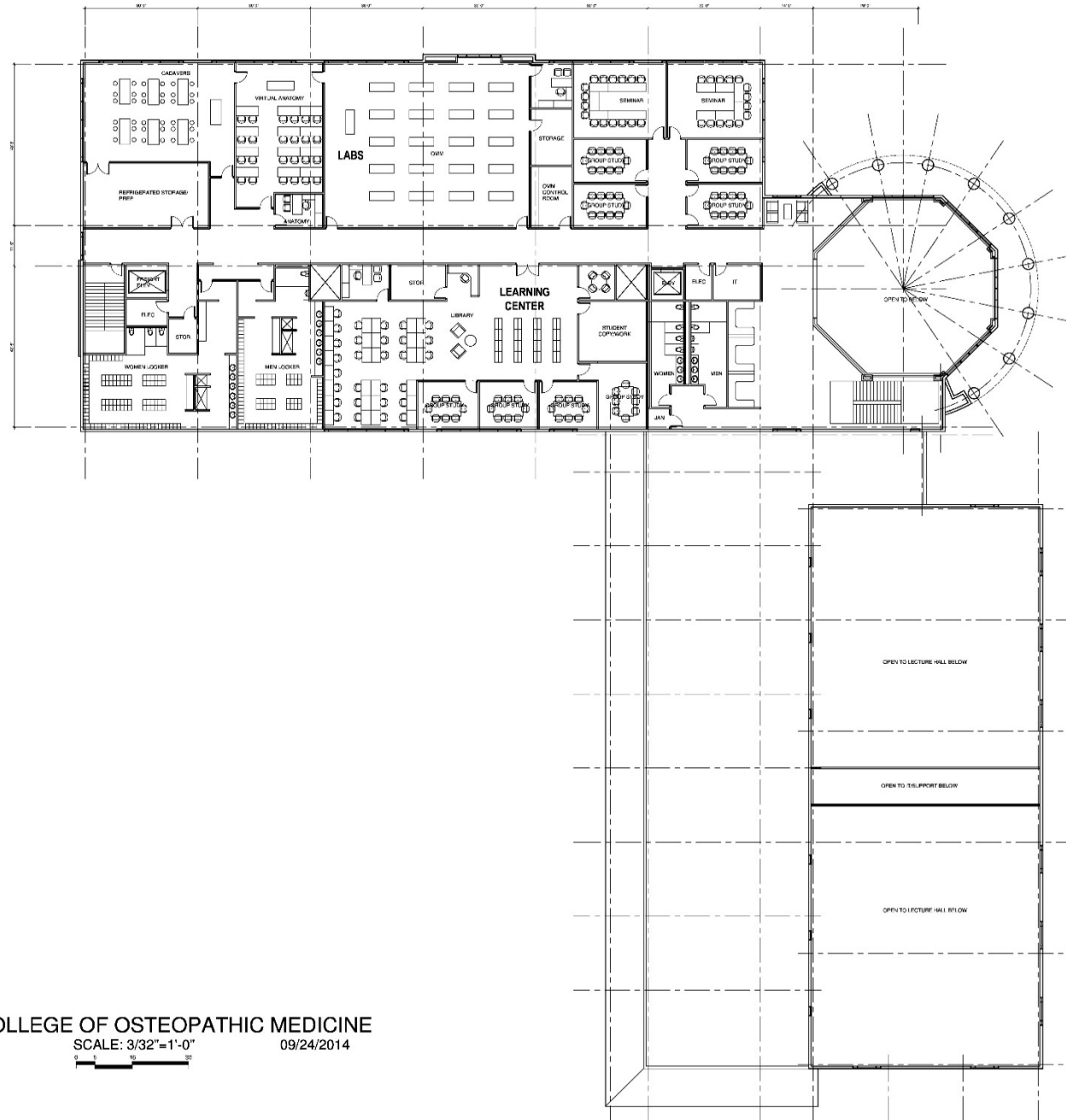

BURRELL COLLEGE OF OSTEOPATHIC MEDICINE

SECOND FLOOR

SCALE: 3/32"=1'-0"

09/24/2014



ARCHITECTURE / DESIGN / INSPIRATION

**DEKKER
PERICH
SABATINI**

7601 STEFFENSON NE, SUITE 100
ALBUQUERQUE, NM 87109
505.761.9700 / DPSDESIGN.ORG



The Inaugural Class

- August, 2016
- 162 Students (D.O.)
- 38 Post-baccalaureate students
- 38 Full-time faculty
- >400 Preceptors (2015)
- 89 Employees

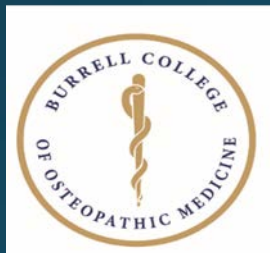

The Burrell College of Osteopathic Medicine is a free standing, privately funded, separately licensed and independently operated entity. It is not part of New Mexico State University



Update: August 24, 2015

ACCOMAS Designations by Application Status

In Progress	1133
Received	138
Complete	315
Verified	1071
Undeliverable/On Hold (Student or AACOMAS actions)	5
Total	2682

AMP

All Applications in AMP-Verified by AACOMAS	1070
BCOM Application Receipt Notification Sent	1070
Supplemental Application Request Sent	1070
Supplemental Application Received/Screen Ready	432
Interview Invited	265
Interview Scheduled	252
Interview Completed	108
Rejections	77
Withdraws	4
Waitlist	13
Offers	90
Accepted	12

GPA

Mean GPA 3.43
Mean Science GPA 3.35

MCAT

Mean Highest MCAT 25.29
MCAT Range: 14-35

OFFERED STUDENTS GPA

Mean GPA 3.34
Mean Science GPA 3.48

OFFERED STUDENTS MCAT

Mean Highest MCAT 25.25
MCAT Range 21-32

States Origin of Applications

California (256)
Texas (92)
Florida (65)
Michigan (51)
New York (53)
Illinois (58)
Pennsylvania (34)
Colorado (30)
Utah (38)
Virginia (24)
New Mexico (11)

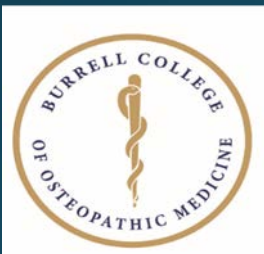

Clinical Education



The Burrell College of Osteopathic Medicine is a free standing, privately funded, separately licensed and independently operated entity. It is not part of New Mexico State University





BURRELL COLLEGE OF OSTEOPATHIC MEDICINE



Acute Care Hospitals with Clinical Affiliation and OPTI Membership Completed / In-Process



Inpatient Behavioral Health Hospital with Clinical Affiliation & OPTI Membership



FQHC's with Clinical Affiliation and/or a Teach Health Center



Large Multi-Specialty, Integrated Medical Group Clinical Affiliate

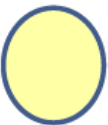

GME Development HUBS with both Acute Care Hospitals and FQHC THC's



International GME Development



NMSU Branch Locations / BCOM Clinical Teaching Sites

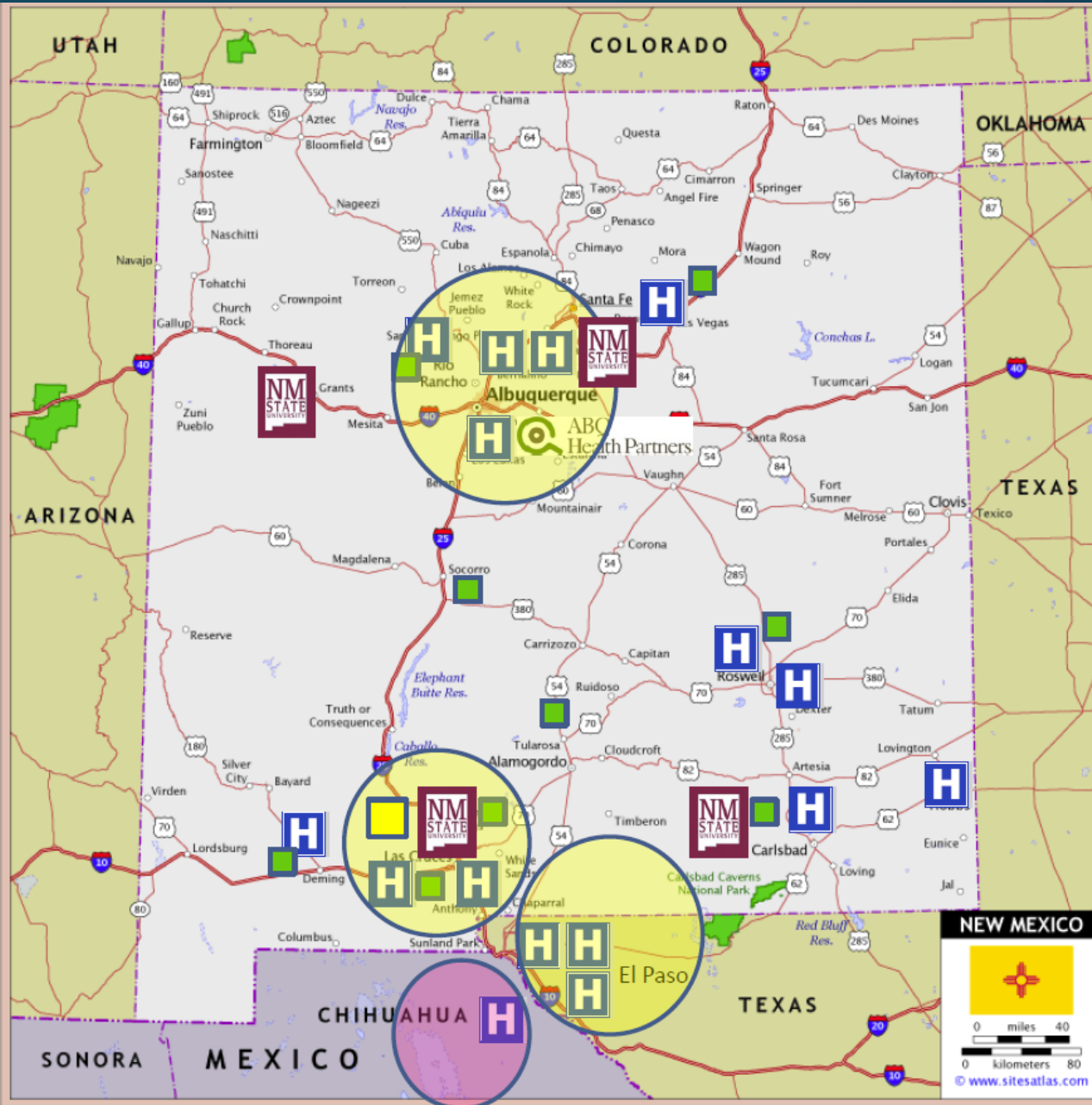

The Burrell College of Osteopathic Medicine is a free standing, privately funded, separately licensed and independently operated entity. It is not part of New Mexico State University



Clinical Rotation Demand and Supply

Rotation Demand

	Year 3	Year 4	Total for Years 3 and 4
Total Number of Students	150	150	300
Rotations per year	7	5	12
Total number of rotations per year	1050	750	3600 Total Demand

Rotation Supply

Current total number of Clinical Faculty	297
Rotations/preceptor/year	13
Total supply of rotations	3861

Current total supply is greater than total demand.



The Burrell College of Osteopathic Medicine is a free standing, privately funded, separately licensed and independently operated entity. It is not part of New Mexico State University



Residency –new positions

Location	Hospital	Specialty	Number
Las Cruces	Memorial Medical Center & La Clinica	FM	30
		Ortho	15
	Internship	4	
	IM	24	
	NMM	4	
Alamogordo	La Clinica de Familia	Psych	16
	Gerald Champion Regional Medical Center	FM	9
Roswell	Lovelace Regional Medical Center	FM	6
Las Cruces/NY/CA/WA	Consortium	Anesth*	60
	*Pending final approval	Total	168

Many more in progress. >600 new positions anticipated by 2020

The Burrell College of Osteopathic Medicine is a free standing, privately funded, separately licensed and independently operated entity. It is not part of New Mexico State University



Meeting the Mission and the Importance of Osteopathic Philosophy in the Culture

- Justin McHorse, MS: Assistant Dean for Multicultural Affairs, Marketing and Communications
- Tribal Citizen of Taos Pueblo
 - Tribal Affiliation with the Otoe-Missouria, Southern Arapaho, and Wisconsin Oneida Tribes and Nations
- Dartmouth College, A.B.
- Purdue University, M.S.
- Formerly Director of New Mexico State University's American Indian Program



The Burrell College of Osteopathic Medicine is a free standing, privately funded, separately licensed and independently operated entity. It is not part of New Mexico State University



Recruitment and Mission

- Culturally informed, targeted recruitment.
- Establish a culturally diverse, supportive and inclusive environment from the outset
- Develop a pipeline of students



The Burrell College of Osteopathic Medicine is a free standing, privately funded, separately licensed and independently operated entity. It is not part of New Mexico State University



Osteopathy and Regional Culture

- Regional American Indian and Hispanic cultural ways of healing body, mind, and spirit most appropriately align with the philosophy of osteopathy.
- Osteopathic medicine provides an additional healthcare resource to the Native American (IHS) and Hispanic communities.
- The increased number and diversity of osteopathic physicians who sustainably remain in the region can help meet the health needs of underserved communities.



The Burrell College of Osteopathic Medicine is a free standing, privately funded, separately licensed and independently operated entity. It is not part of New Mexico State University



Economic Impact

- 2014-2016: \$87.3 million
- 390 new jobs
- Beyond 2016: \$77.7 million/year
- 350 new jobs
- Regionally additional \$32 million/year, plus \$15 million/year savings and productivity increase



The Burrell College of Osteopathic Medicine is a free standing, privately funded, separately licensed and independently operated entity. It is not part of New Mexico State University



**NMAC- POST-SECONDARY EDUCATION TUITION AND FINANCIAL AID
TITLE 5
CHAPTER 7
PART 4 – PRIMARY CARE PHYSICIAN STUDENT LOAN-FOR-SERVICE
PROGRAM**

Purpose of 5.7.4 NMAC is to increase the number of primary care physicians in underserved areas of the state, by making educational loans to medical students seeking to become primary care physicians. A condition of the loan, that the student declare their intent to practice as a primary care physician within one of the counties of the state designated by the U.S. Department of Health and Human Services as having a shortage of primary care physicians.

In section 5.7.4.8 – Student Eligibility, a student must be accepted by the “university” to be considered for the Loan-For-Service program. In section 5.7.4.7 (N) - Definitions- “University” means the University of New Mexico School of Medicine.



- “This is the most important healthcare development in the history of the State of New Mexico”.

July 14, 2014



The Burrell College of Osteopathic Medicine is a free standing, privately funded, separately licensed and independently operated entity. It is not part of New Mexico State University

