

Teacher Housing

Public School Capital Outlay Oversight Task Force

October 25, 2021

Presenter:

Martica Casias, Director (Interim)

Alyce Ramos, Programs Manager

New Mexico Public School Facilities Authority

Agenda

- Existing Housing
- Teacher Housing Workshops
- Teacher Housing Surveys
- Teacher Housing Needs
- Current Teacher Housing Projects
- Questions

Existing Teacher Housing Units in New Mexico

of Units, Top 10 Districts

1.	Gallup	245
2.	Zuni	125
3.	Central	110
4.	Dulce	58
5.	Moriarty	39
6.	Artesia	19
7.	Animas	16
8.	Jemez Mountain	13
9.	Cuba	11
10.	Lovington	10
	• Corona	10
	• Reserve	10

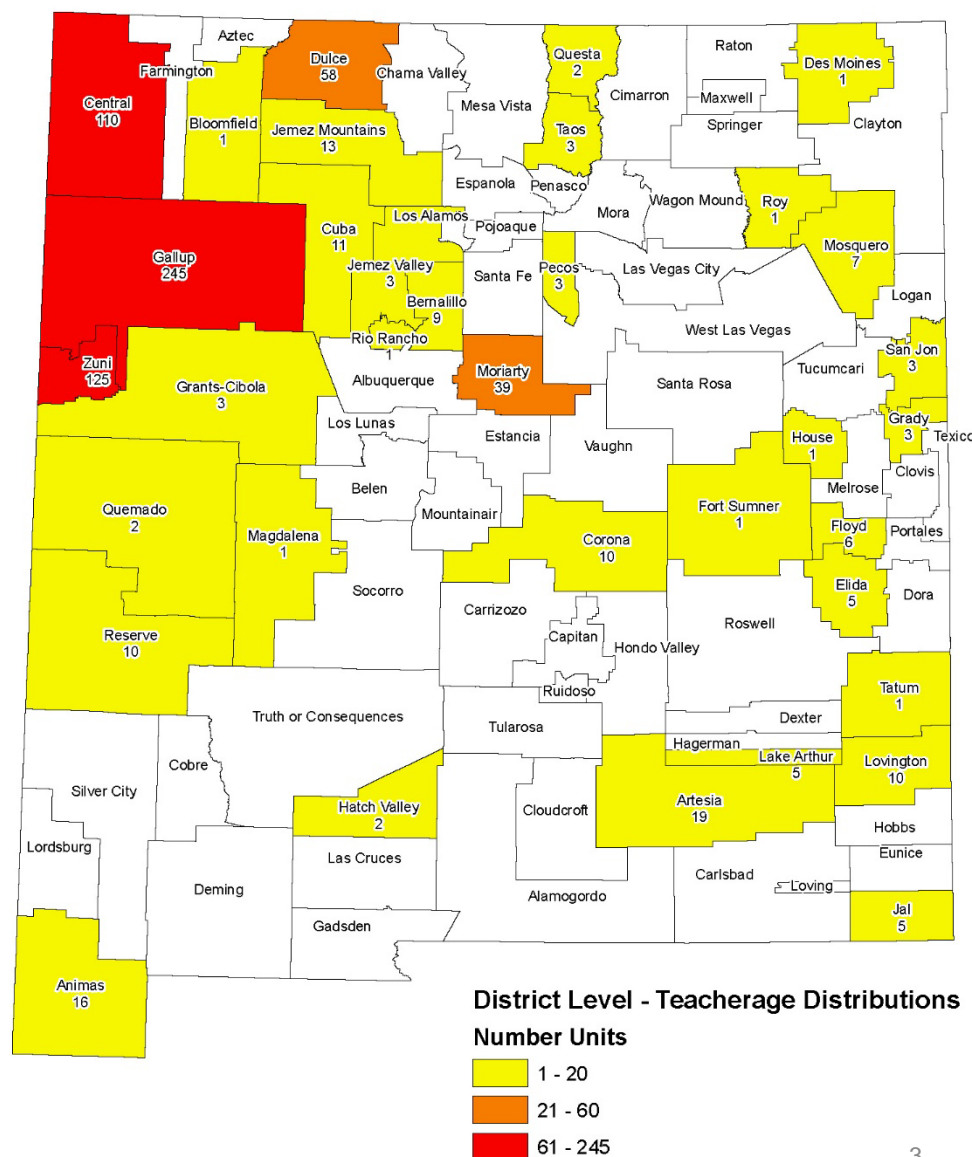

Existing Teacher Housing Age and Condition

- Approximately 350 of existing housing units are older than 50 years
- Approximately 50% of existing housing units are reported to be in poor condition

of Units by Condition

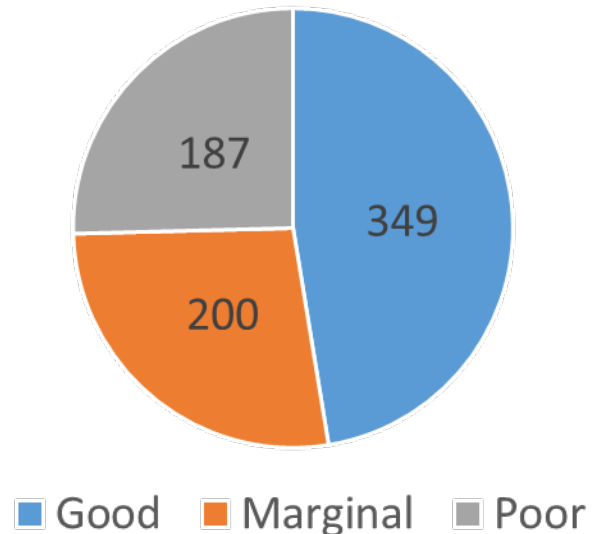

Age	Pre 1950	1950's	1960's	1970's	1980's	1990's	2000's
Buildings	64	60	82	35	52	48	119
Units	103	97	143	46	65	62	220
GSF	67,283	59,678	116,400	61,139	71,290	86,358	189,454

Existing Teacher Housing Age and Condition



2021 Teacher Housing Workshops

Date	Time	District	Address	Location	Go-to-Meeting Link
Monday Sept. 20	4- 6pm	Central	Highway 491 S, Newcomb, NM 87455	Newcomb HS Gym	https://global.gotomeeting.com/join/481406341
Thursday Sept. 23	4- 6pm	Gallup	8 Hawk Circle Thoreau, NM 87323	Thoreau MS Cafeteria	https://global.gotomeeting.com/join/251644053
Monday Sept. 27	4- 6pm	Raton	1535 Tiger Circle Raton, NM 87740	Raton HS Media Center	https://global.gotomeeting.com/join/252517509
Wednesday Sept. 29	4- 6pm	Las Cruces	505 S Main St. Las Cruces, NM 88001	Karen Trujillo Administrative Building Boardroom	https://global.gotomeeting.com/join/251485429
Tuesday Oct. 5	4- 6pm	Cuba	50 County Road 13 Cuba, NM 87103	Cuba HS Building 53	https://global.gotomeeting.com/join/504813677
Wednesday Oct. 13	4- 6pm	Artesia	301 Bulldog Blvd Artesia, NM 88210	Administration Training Center	https://global.gotomeeting.com/join/307344493
Monday Oct. 18	4- 6pm	Alb.	1312 Basehart Drive NW Albuquerque, NM 87106	PSFA Multipurpose Room	https://global.gotomeeting.com/join/588418469

- October – December: PSFA planning and design guidelines document for teacher housing.
- January 2022 PSCOC: PSCOC approval of Teacher Housing Funding Program Guidelines.
- Spring 2022: Release of Applications for Teacher Housing Funding (estimated).
- Spring 2022: PSCOC Awards for Teacher Housing Projects (estimated).

Teacher Housing Workshop Findings

- Many districts are interested in building new teacher housing in their districts.
- Teacher housing is needed to recruit and retain teachers throughout the state.
- A variety of housing unit types (studio, 1 / 2 / 3 bedroom) would be of value to districts in order to provide options for single occupants and families.
- Multi-family housing may provide an efficient and desired option to both teachers and districts.
- Maintenance of housing units is a constant burden on districts' maintenance workforce and funding.
- Districts are not well equipped to be landlords. The management of housing distracts from the administration of education and operations.
- Districts' funding sources for Local Match requirement are limited.

Teacher Housing Surveys

- PSFA developed and distributed two surveys at the Teacher Housing Workshops to collect input and information regarding existing teacher housing and future teacher housing needs.
- PSFA is currently reviewing the survey data.
 - **Teacher Survey (Tenant)**
 - Focus: experiences living in teacher housing units
suggestions for future teacher housing units.
 - 160 surveys have been submitted (as of yet).
 - **District / Administration Survey (Landlords)**
 - Focus: districts' existing teacher housing and landlord practices,
needs for future housing, suggestions for housing designs
and guidelines.
 - 16 surveys have been submitted (as of yet).

Tenant Surveys – Key Findings

- **Why does your district need to provide teacher housing?**

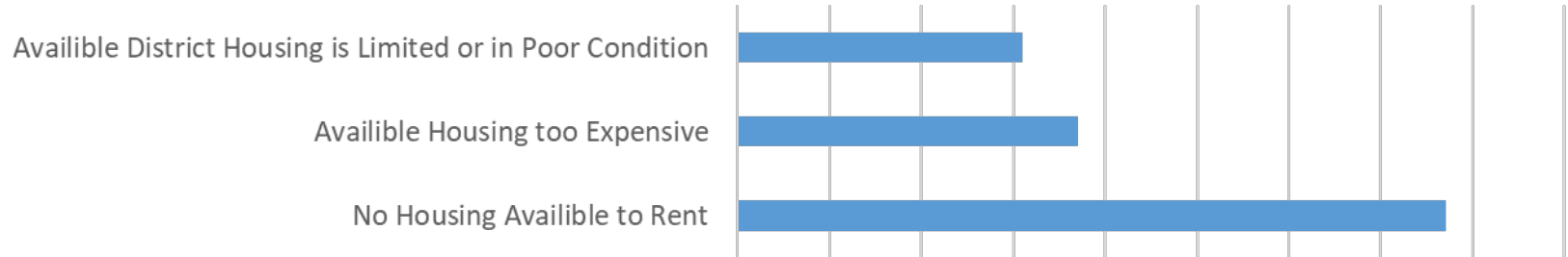

- **Did the availability of teacher housing attract you to locate to the school district?**

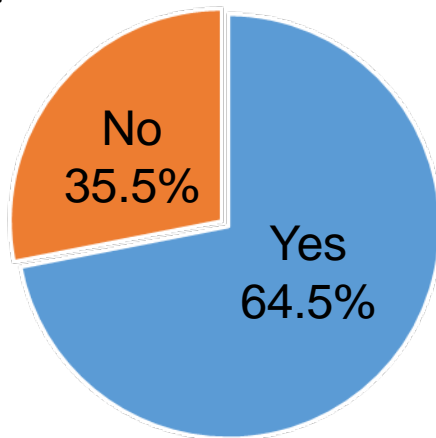

- **Average current condition of teacher housing units in district?**

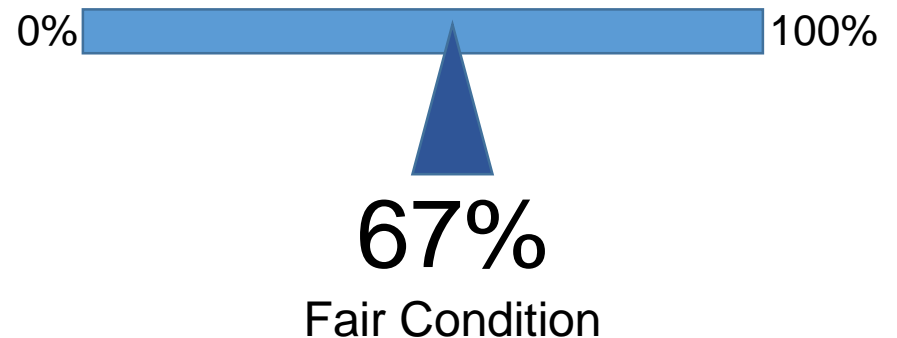

Landlord Surveys – Key Findings

- Does your district need new teacher housing units to replace older teacher housing units?

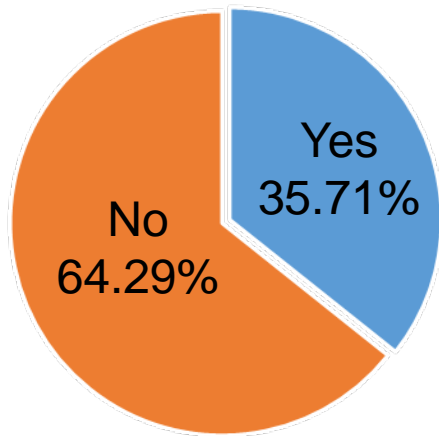

- Does your district need new teacher housing units to increase the total number of units available?

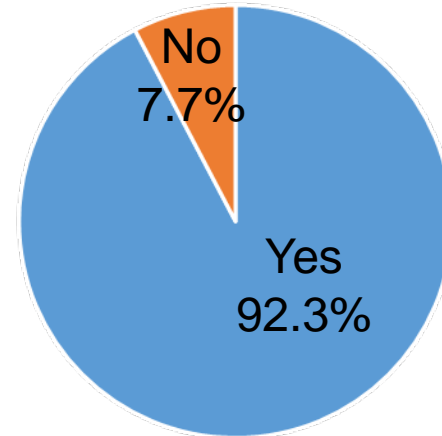

- Average current condition of existing teacher housing units in district?

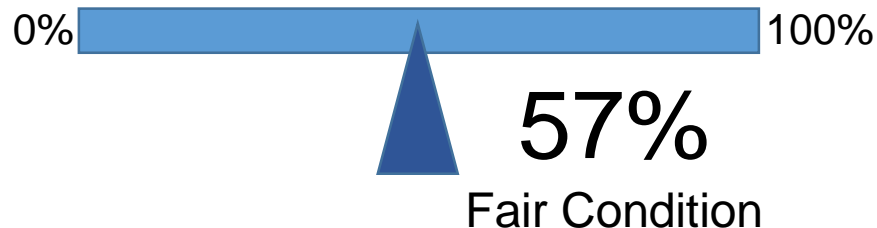

Teacher Housing Needs

Statewide Need to Replace Existing Housing

- Many districts have existing teacher housing units that are beyond their function life span.
- Many districts need replace some or all of their teacher housing units due to age and poor condition.

Statewide Need to Add Capacity

- Districts with existing teacher housing units need to increase the number of teacher housing units to provide an adequate number of units for teachers.
- Several districts that do not currently have teacher housing units are interested in adding teacher housing units to provide for teaching staff.

Current Teacher Housing Projects



Gallup Teacher Housing Units



Current Teacher Housing Projects

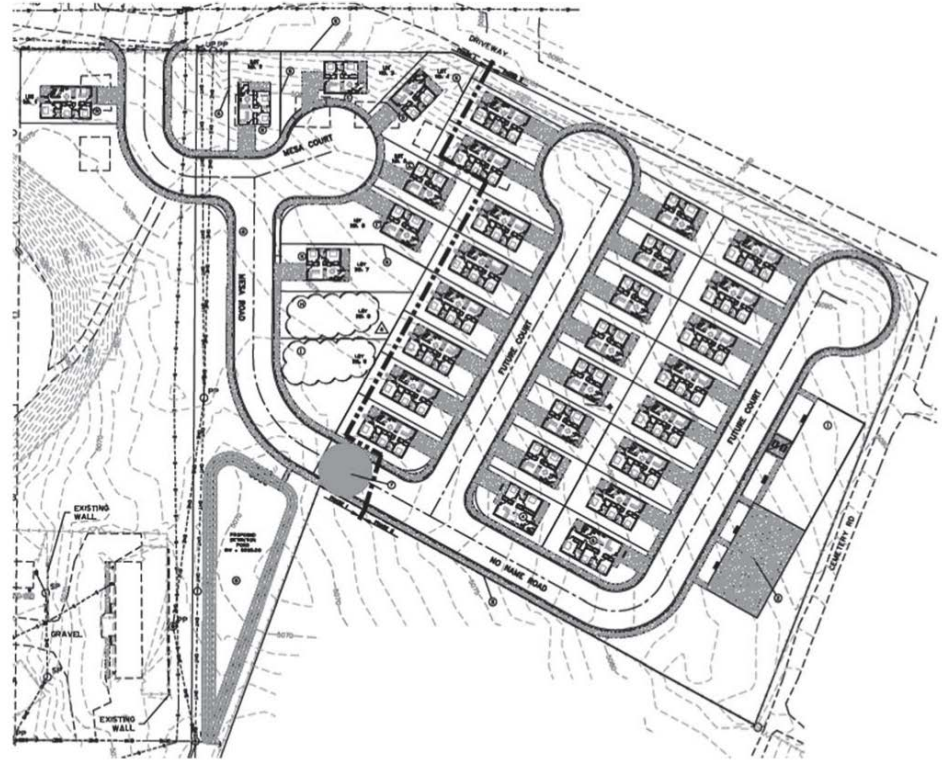

Gallup Teacher Housing Units

Questions

Martica Casias

Executive Director (Interim), PSFA

505-362-1356

mcasias@nmpsfa.org

Alyce Ramos

Programs Manager

505-468-0299

aramos@nmpsfa.org

Thank You!