

0 10 20 40 60 80 100 120 140 160 Miles

**RESEARCH & POLLING INC.**

For the New Mexico Legislative Council Service

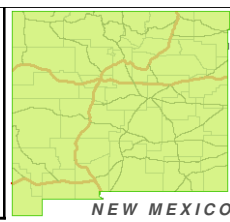

**LEGEND** Created: November 16, 2011

- Counties
- Rivers
- Interstate Highway
- US Highway

Research & Polling, Inc. distributes this map assuming no liability for any errors, omissions, or inaccuracies in the information provided regardless of the cause in reliance upon any maps.



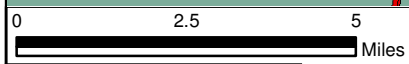
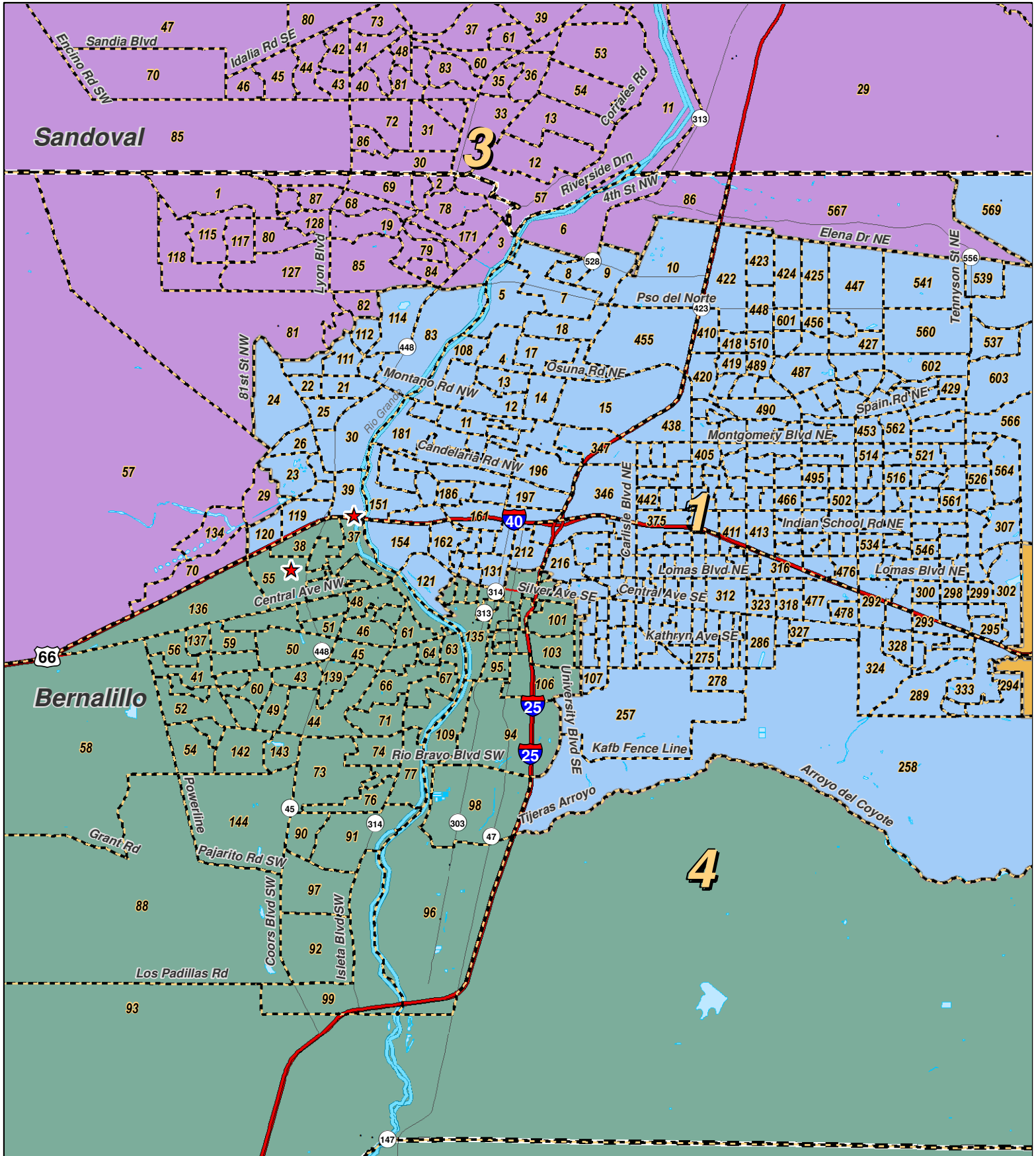

For the New Mexico  
Legislative Council Service



**LEGEND** Created: November 16, 2011

Precincts	Interstate
Counties	US Highway
Rivers	State Highway

Research & Polling, Inc. distributes this map assuming no liability for any errors, omissions, or inaccuracies in the information provided regardless of the cause in reliance upon any maps.

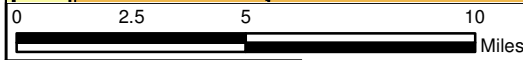
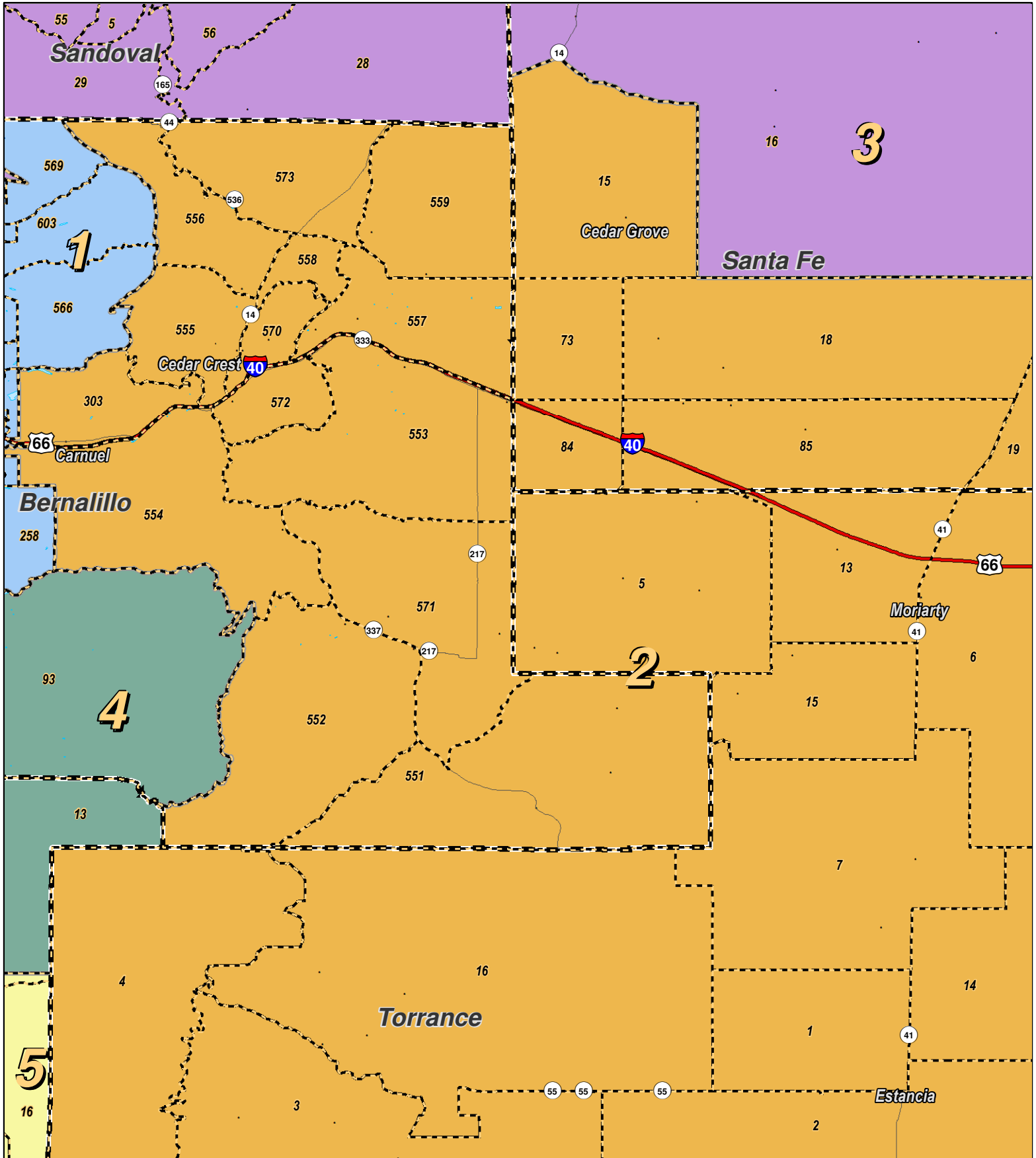

For the New Mexico  
Legislative Council Service



**LEGEND** Created: November 16, 2011

Precincts	Interstate
Counties	US Highway
Rivers	State Highway

Research & Polling, Inc. distributes this map assuming no liability for any errors, omissions, or inaccuracies in the information provided regardless of the cause in reliance upon any maps.

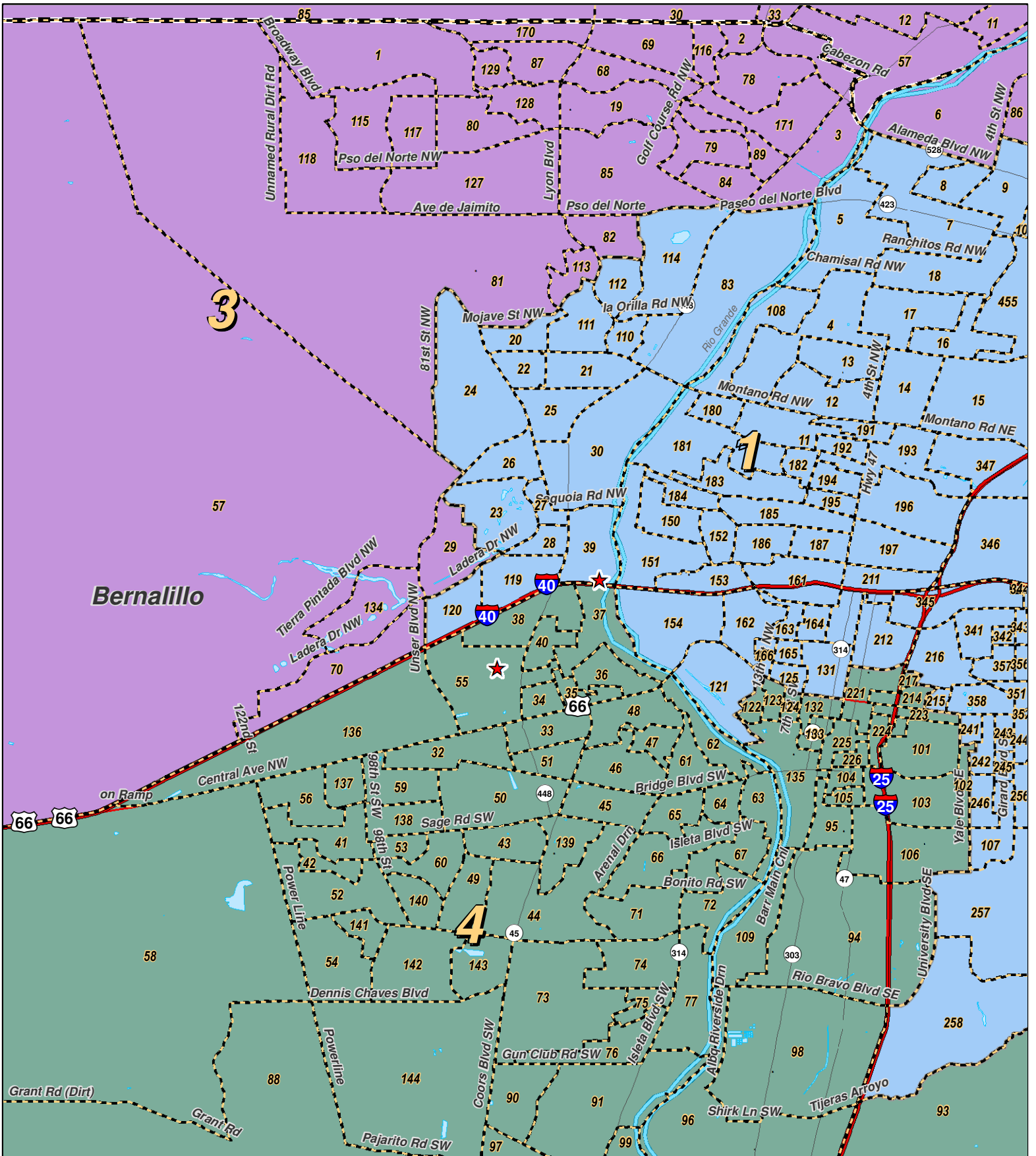

0 2.5 5 Miles

**RESEARCH & POLLING INC.**

For the New Mexico Legislative Council Service



**LEGEND** Created: November 16, 2011

- Counties
- Rivers
- Interstate
- US Highway
- State Highway

Research & Polling, Inc. distributes this map assuming no liability for any errors, omissions, or inaccuracies in the information provided regardless of the cause in reliance upon any maps.

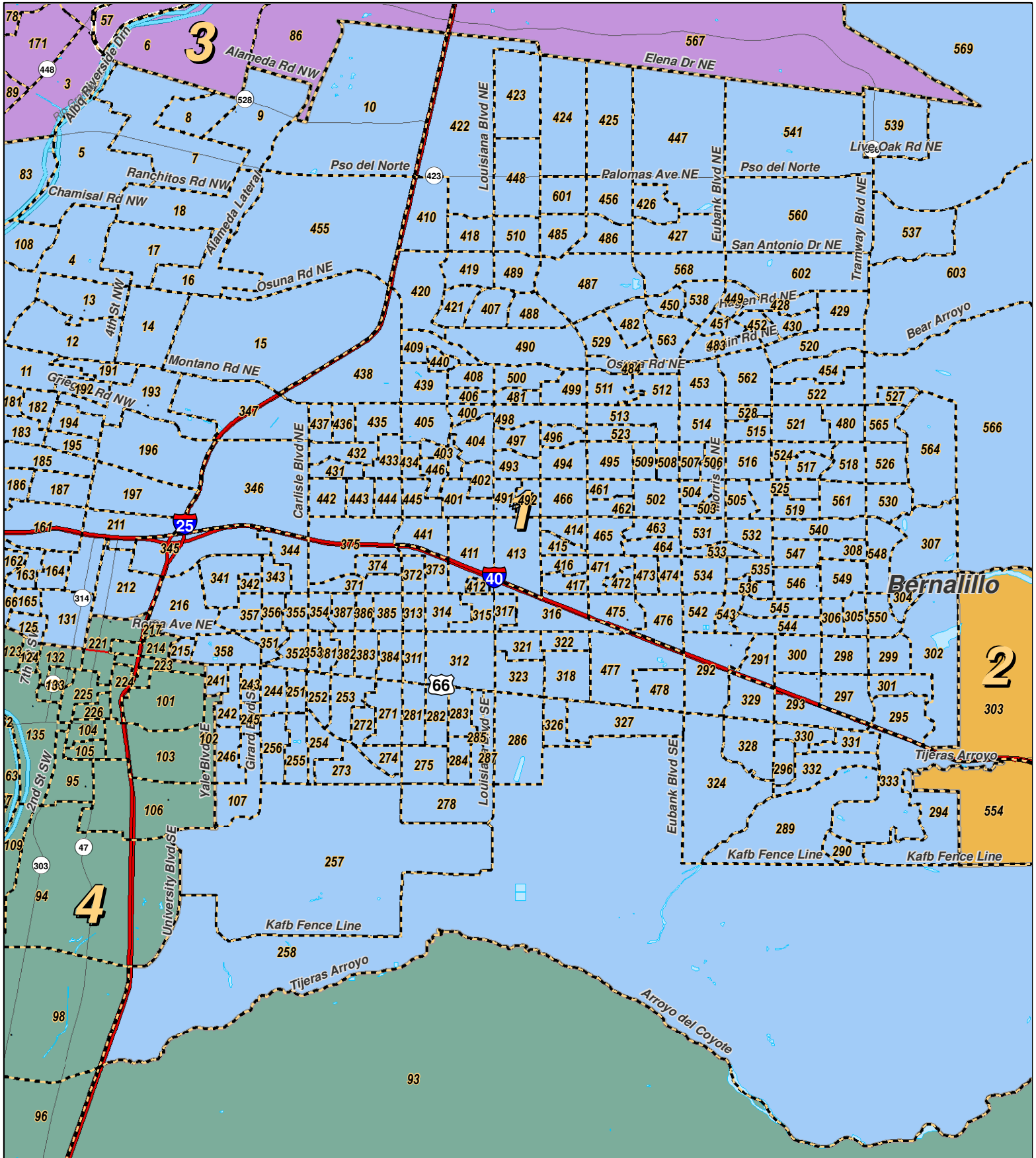

0 2.5 5 Miles

**RESEARCH & POLLING INC.**

For the New Mexico Legislative Council Service



**LEGEND** Created: November 16, 2011

- Counties
- Rivers
- Interstate
- US Highway
- State Highway

Research & Polling, Inc. distributes this map assuming no liability for any errors, omissions, or inaccuracies in the information provided regardless of the cause in reliance upon any maps.

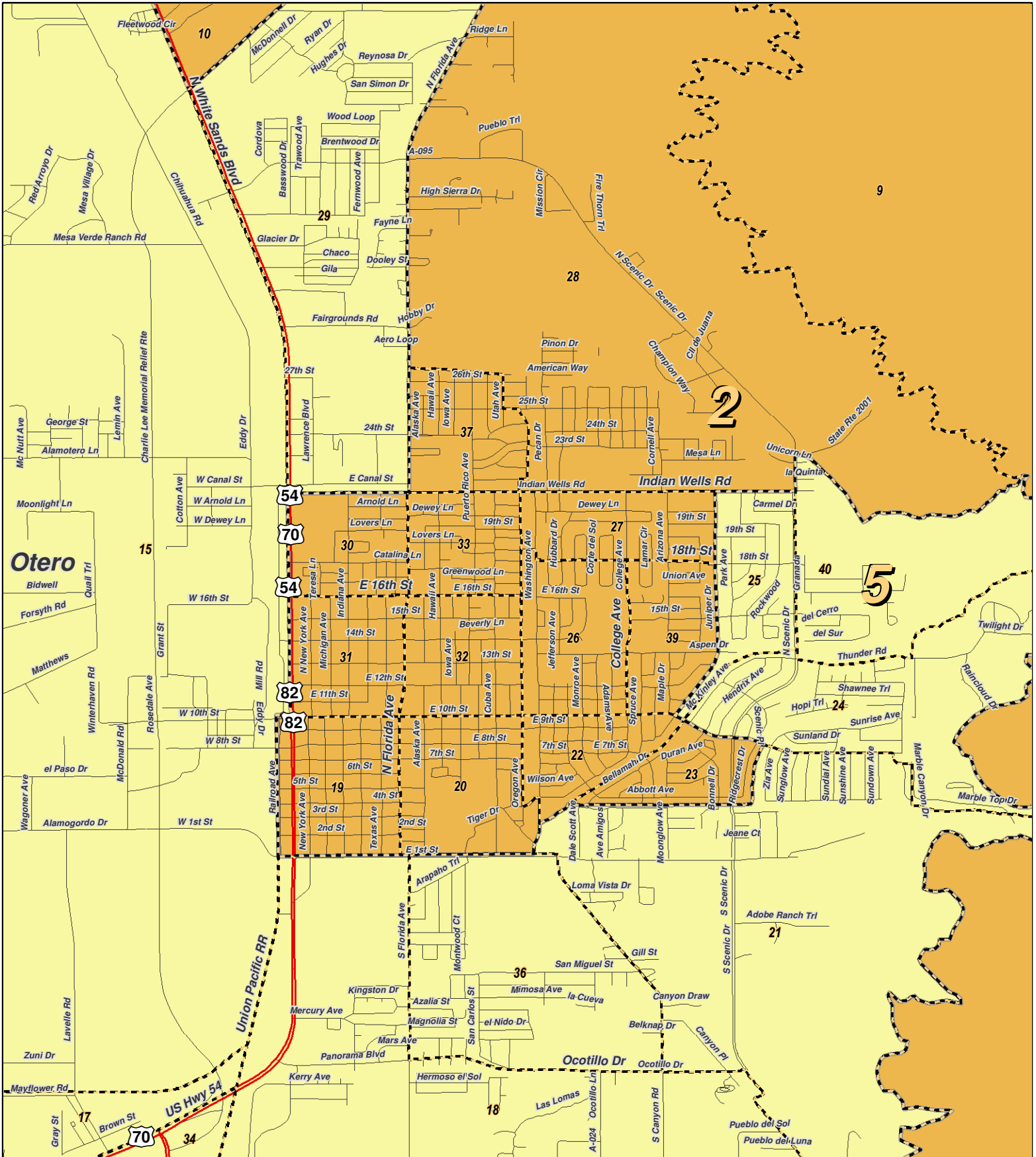

0 0.5 1 Miles



For the New Mexico  
Legislative Council Service



**LEGEND** Created: November 16, 2011

Counties	Interstate
Rivers	US Highway
	State Highway

Research & Polling, Inc. distributes this map assuming no liability for any errors, omissions, or inaccuracies in the information provided regardless of the cause in reliance upon any maps.

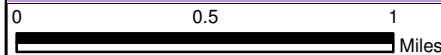
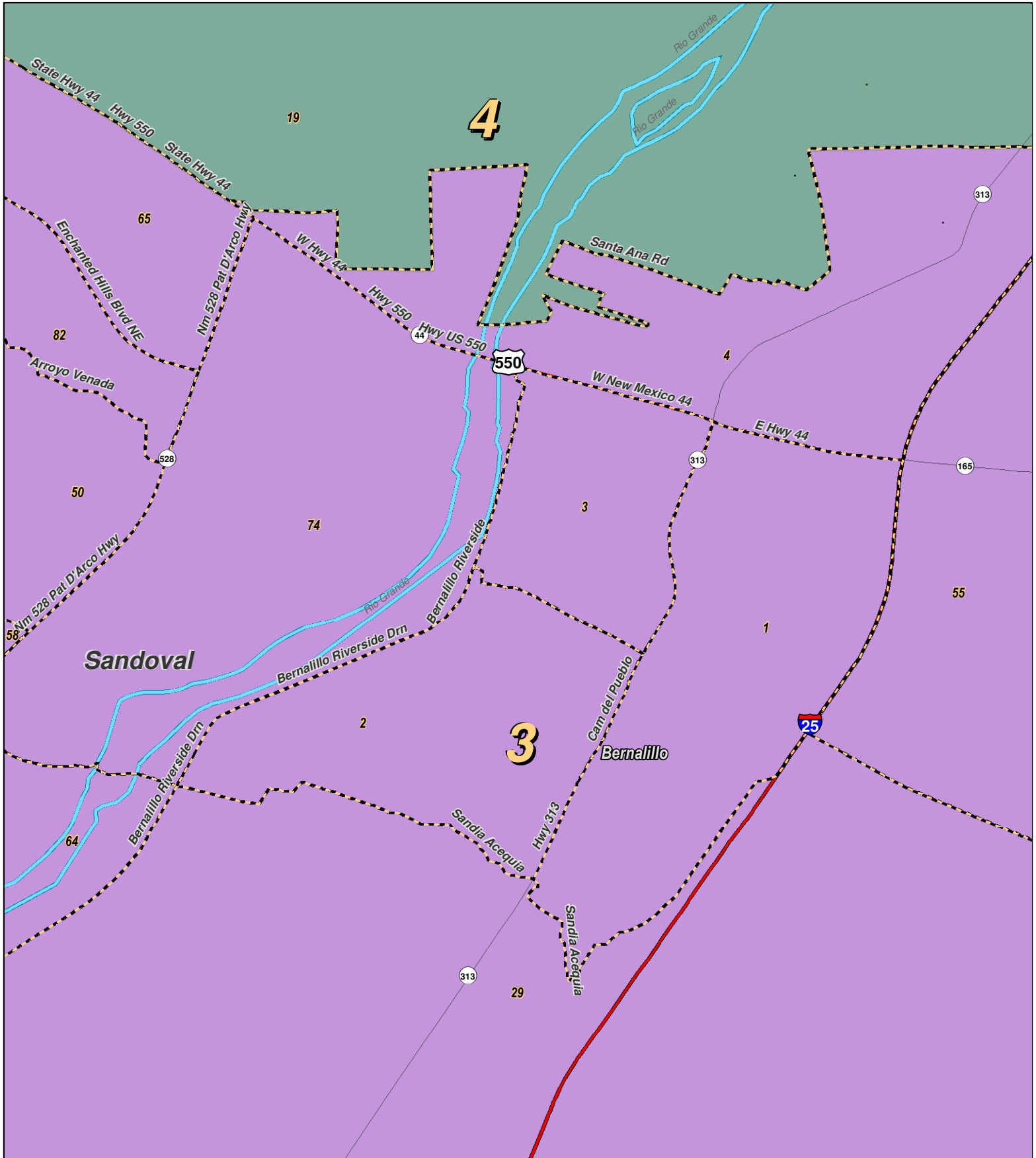

For the New Mexico  
Legislative Council Service



**LEGEND**

Created: November 16, 2011

- Counties
- Rivers
- Interstate
- US Highway
- State Highway

Research & Polling, Inc. distributes this map assuming no liability for any errors, omissions, or inaccuracies in the information provided regardless of the cause in reliance upon any maps.



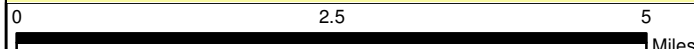
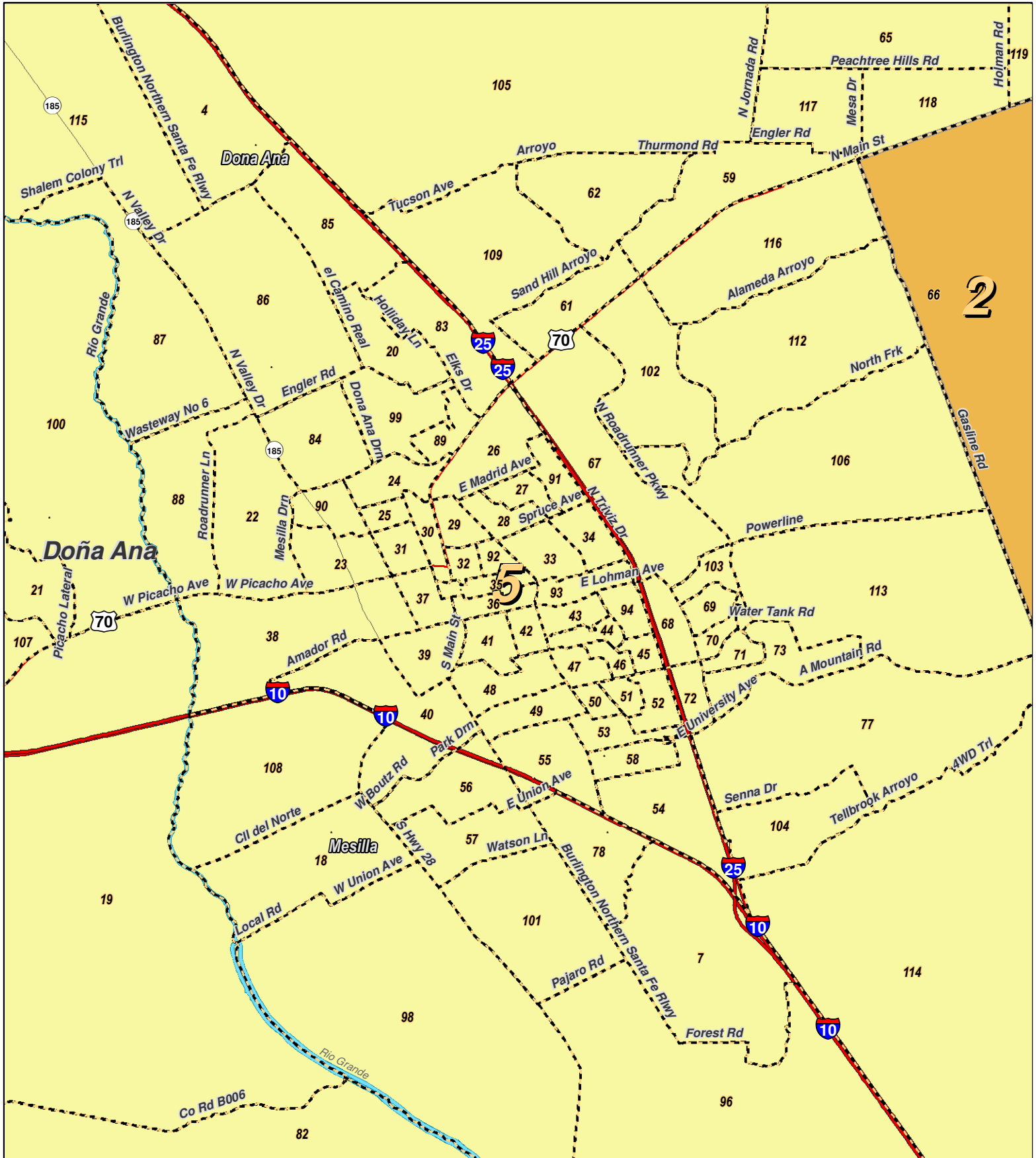

For the New Mexico  
Legislative Council Service



**LEGEND** Created: November 16, 2011

- Counties
- Rivers
- Interstate
- US Highway
- State Highway

Research & Polling, Inc. distributes this map assuming no liability for any errors, omissions, or inaccuracies in the information provided regardless of the cause in reliance upon any maps.

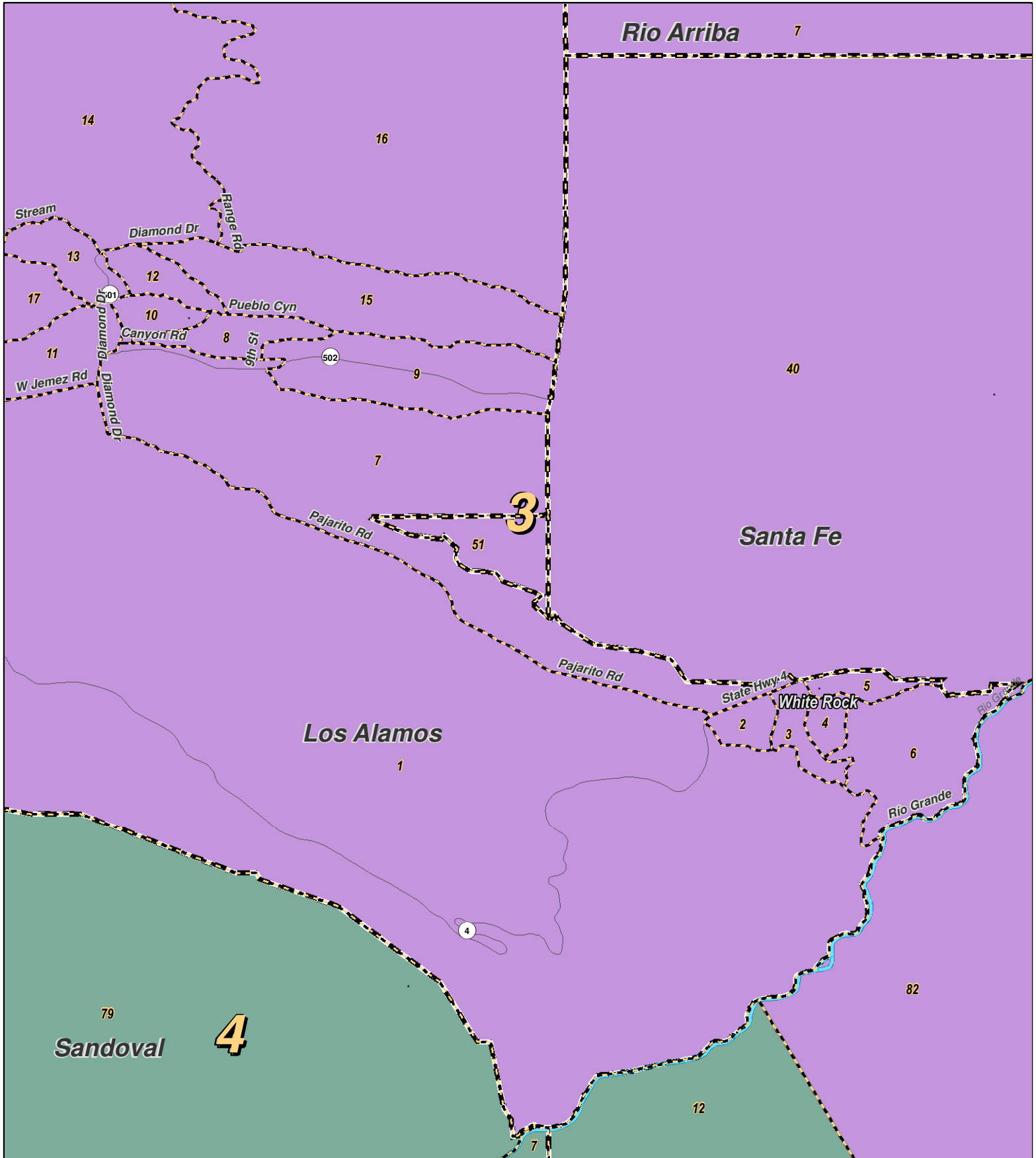

0 2 4 Miles

**RESEARCH & POLLING INC.**

For the New Mexico Legislative Council Service



**LEGEND** Created: November 16, 2011

Counties	Interstate
Rivers	US Highway
	State Highway

Research & Polling, Inc. distributes this map assuming no liability for any errors, omissions, or inaccuracies in the information provided regardless of the cause in reliance upon any maps.

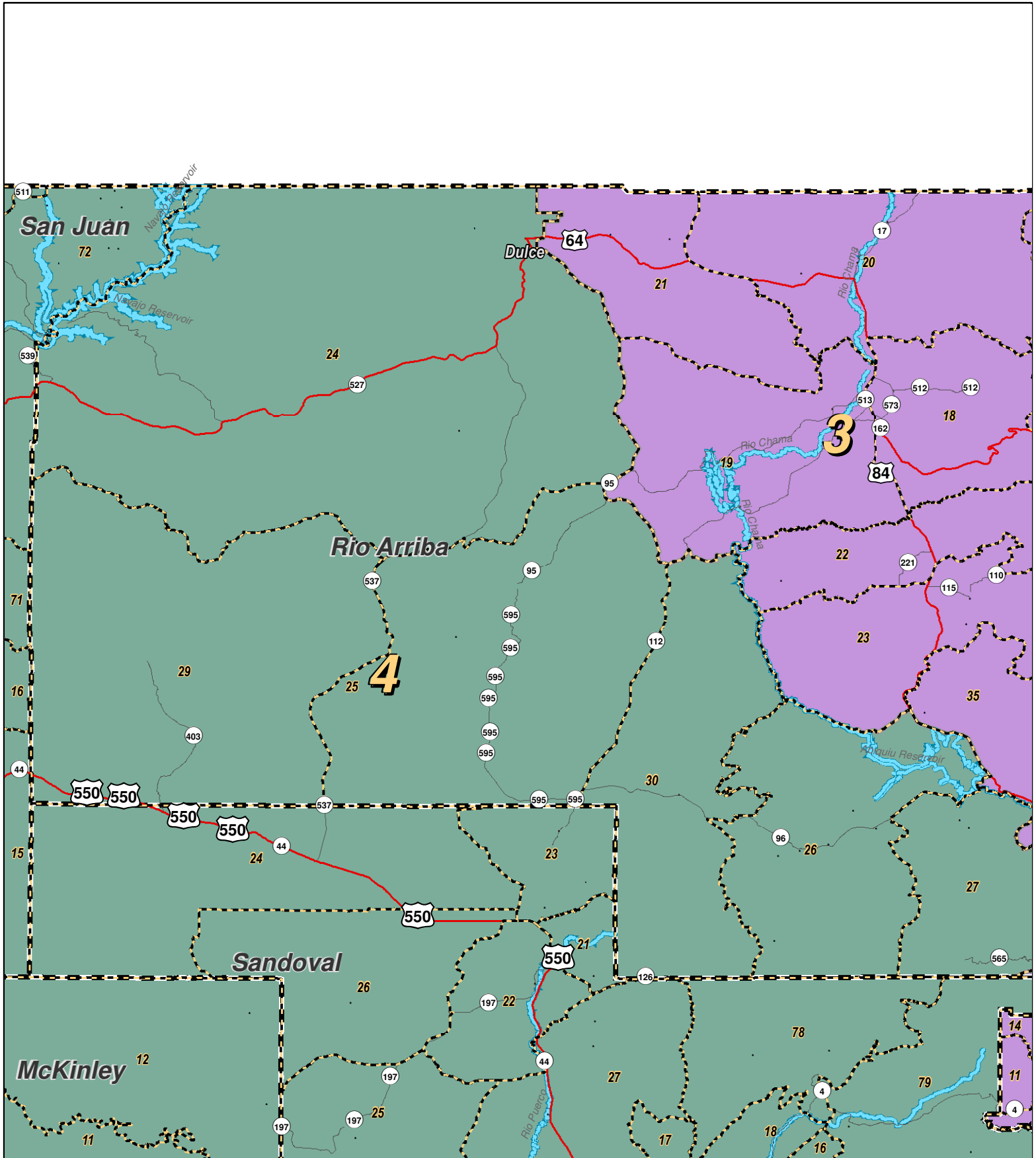

0 2.5 5 10 15 20 25 30 35 Miles

RESEARCH & POLLING INC.

For the New Mexico Legislative Council Service



**LEGEND** Created: November 16, 2011

Precincts	Interstate
Counties	US Highway
Rivers	State Highway

Research & Polling, Inc. distributes this map assuming no liability for any errors, omissions, or inaccuracies in the information provided regardless of the cause in reliance upon any maps.

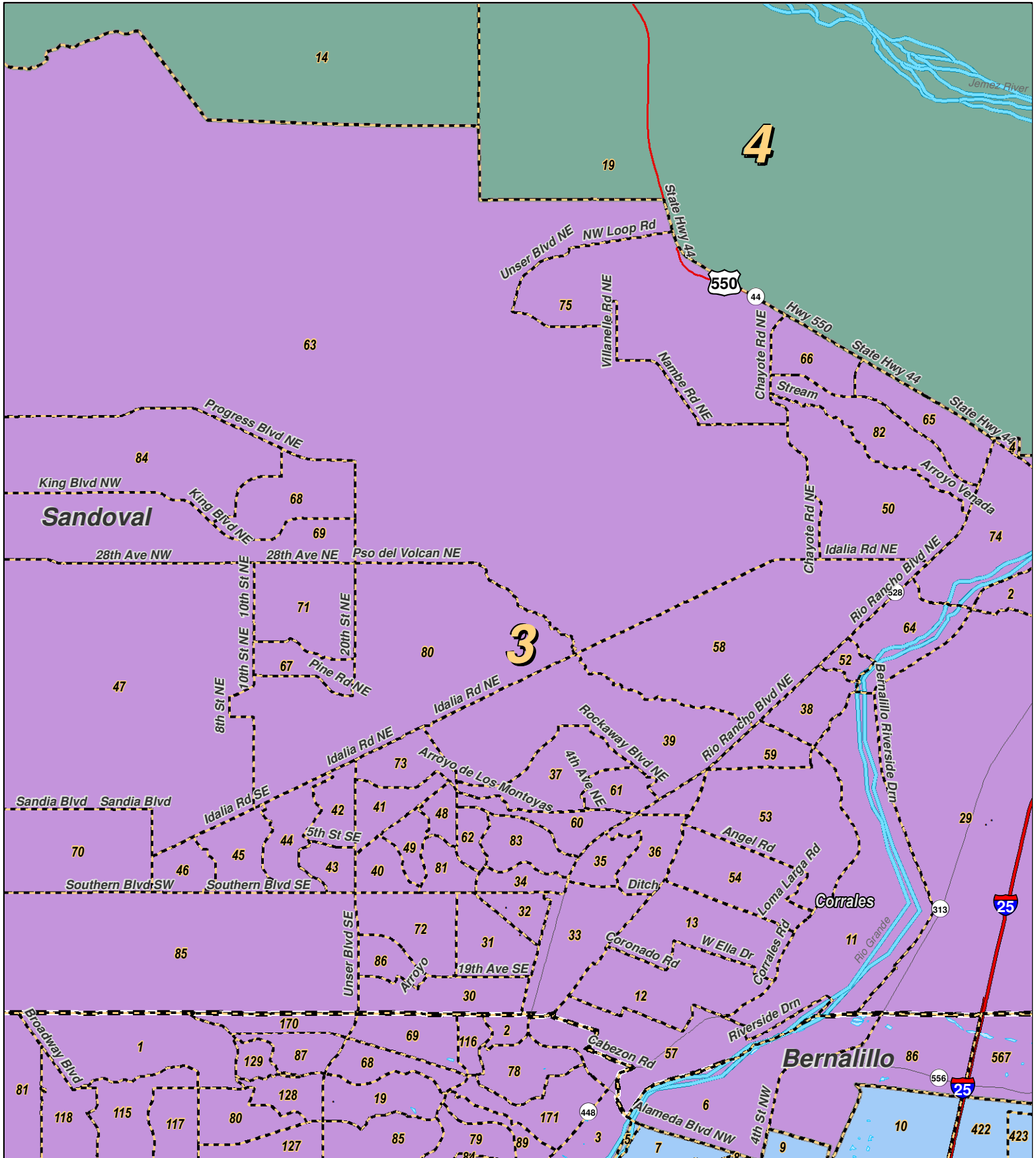

0 2.5 5 Miles

**RESEARCH & POLLING INC.**

For the New Mexico Legislative Council Service



**LEGEND** Created: November 16, 2011

- Counties
- Rivers
- Interstate
- US Highway
- State Highway

Research & Polling, Inc. distributes this map assuming no liability for any errors, omissions, or inaccuracies in the information provided regardless of the cause in reliance upon any maps.

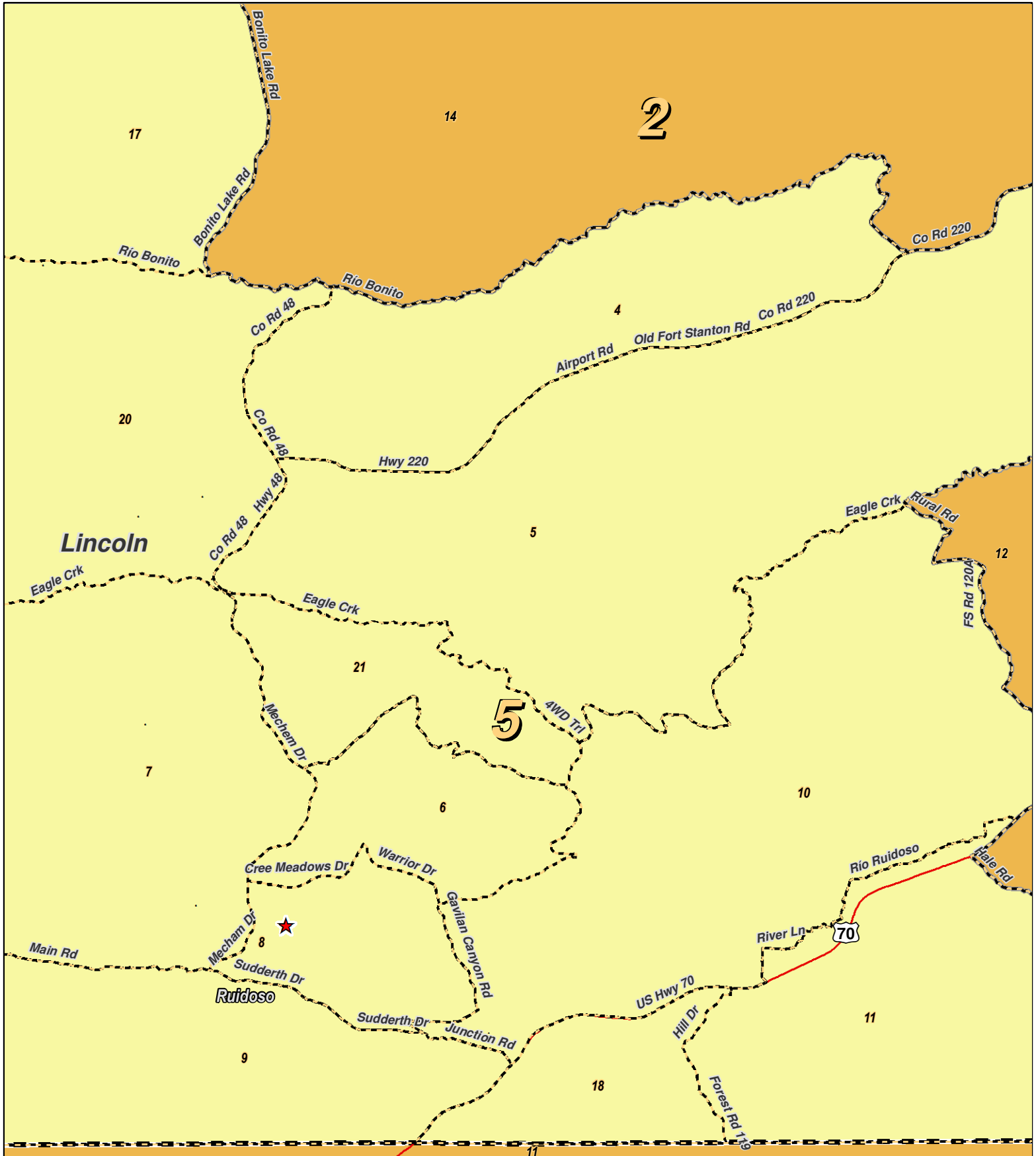

0 2.5 5 M

**RESEARCH & POLLING**  
INC.

For the New Mexico  
Legislative Council Service



**LEGEND** Created: November 16, 2011

Counties	Interstate
Rivers	US Highway
	State Highway

Research & Polling, Inc. distributes this map assuming no liability for any errors, omissions, or inaccuracies in the information provided regardless of the cause in reliance upon any maps.

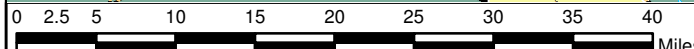
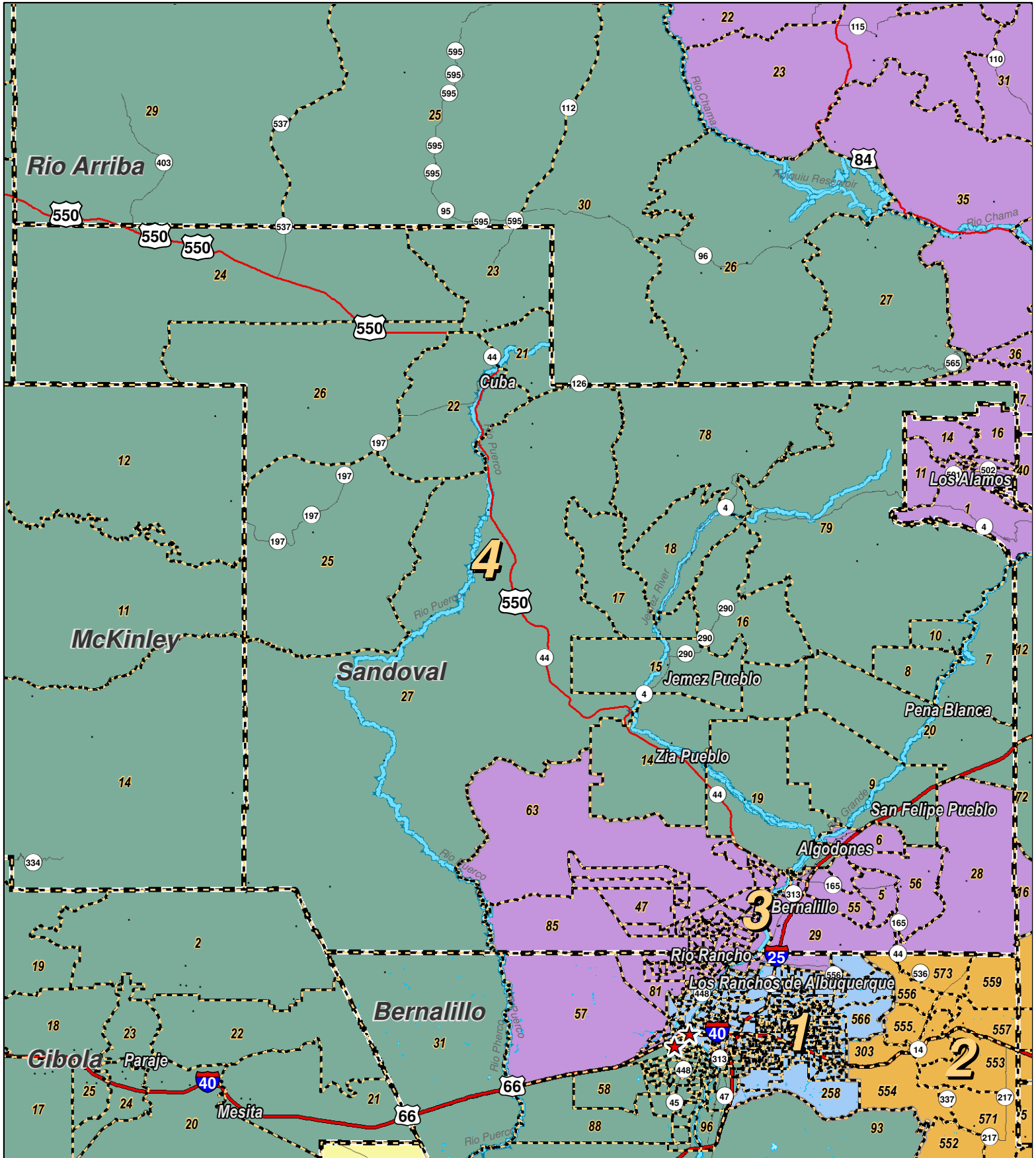

For the New Mexico  
Legislative Council Service



**LEGEND** Created: November 16, 2011

- Precincts
- Counties
- Rivers
- Interstate
- US Highway
- State Highway

Research & Polling, Inc. distributes this map assuming no liability for any errors, omissions, or inaccuracies in the information provided regardless of the cause in reliance upon any maps.

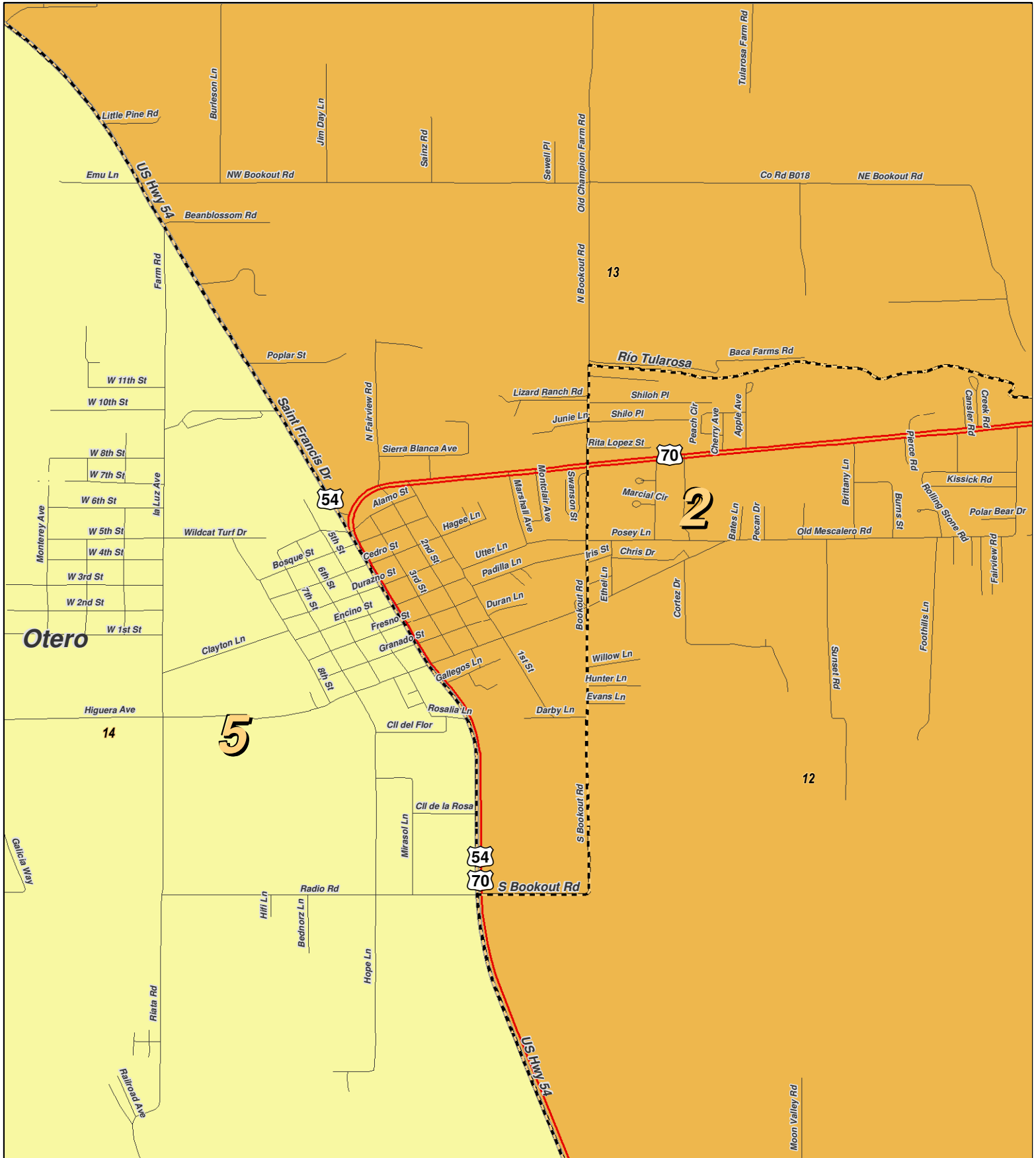

0 0.5 1 Miles

**RESEARCH & POLLING**  
INC.

For the New Mexico  
Legislative Council Service

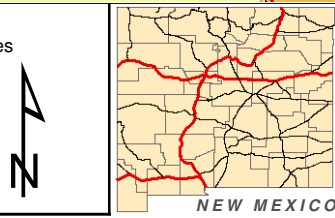

**LEGEND** Created: November 16, 2011

Counties	Interstate
Rivers	US Highway
	State Highway

Research & Polling, Inc. distributes this map assuming no liability for any errors, omissions, or inaccuracies in the information provided regardless of the cause in reliance upon any maps.





District	Pop	Deviation	Hispanic	Non-Hispanic Origin				
				White	Native American	Black	Asian	Other Races
1	413,027	1,191 0.3%	160,224 38.8%	205,226 49.7%	16,085 3.9%	10,543 2.6%	11,709 2.8%	9,240 2.2%
18+	325,108		114,010 35.1%	175,841 54.1%	11,933 3.7%	8,302 2.6%	9,264 2.8%	5,758 1.8%
2	413,678	1,842 0.4%	194,030 46.9%	195,324 47.2%	6,537 1.6%	9,189 2.2%	2,717 0.7%	5,881 1.4%
18+	305,823		129,018 42.2%	159,436 52.1%	4,717 1.5%	6,899 2.3%	2,192 0.7%	3,561 1.2%
3	409,470	-2,366 -0.6%	196,861 48.1%	179,428 43.8%	13,480 3.3%	5,816 1.4%	6,249 1.5%	7,636 1.9%
18+	310,706		137,288 44.2%	149,835 48.2%	9,804 3.2%	4,403 1.4%	4,865 1.6%	4,511 1.5%
4	415,331	3,495 0.8%	169,994 40.9%	96,967 23.3%	134,665 32.4%	4,605 1.1%	2,349 0.6%	6,751 1.6%
18+	293,629		113,210 38.6%	79,232 27.0%	92,024 31.3%	3,661 1.2%	1,902 0.6%	3,600 1.2%
5	407,673	-4,163 -1.0%	232,294 57.0%	156,865 38.5%	4,601 1.1%	5,309 1.3%	3,281 0.8%	5,323 1.3%
18+	305,241		157,800 51.7%	133,504 43.7%	3,484 1.1%	4,188 1.4%	2,733 0.9%	3,532 1.2%
<b>Totals</b>	2,059,179	Ideal: 411,836	953,403 46.3%	833,810 40.5%	175,368 8.5%	35,462 1.7%	26,305 1.3%	34,831 1.3%
18+	1,540,507		651,326 42.3%	697,848 45.3%	121,962 7.9%	27,453 1.8%	20,956 1.4%	20,962 1.2%

**District Profile**

District	Total Population	Deviation		Total Adult Native American	Adult Hispanic	Adult Non-Hispanic			Performance Measure		Registered Voters				
						White	American	Black	Dem	Rep	Total	% Dem	% Rep	% DTS	% Other
1	413,027	1,191	0.3%	5.3%	35.1%	54.1%	3.7%	2.6%	52.9%	47.1%	273,311	45.9%	34.0%	16.4%	3.7%
2	413,678	1,842	0.4%	3.0%	42.2%	52.1%	1.5%	2.3%	41.3%	58.7%	215,240	43.4%	40.6%	14.3%	1.8%
3	409,470	-2,366	-0.6%	4.9%	44.2%	48.2%	3.2%	1.4%	61.0%	39.0%	255,623	55.7%	26.3%	15.0%	3.0%
4	415,331	3,495	0.8%	33.5%	38.6%	27.0%	31.3%	1.2%	57.9%	42.1%	200,618	53.8%	26.3%	17.2%	2.7%
5	407,673	-4,163	-1.0%	2.7%	51.7%	43.7%	1.1%	1.4%	50.7%	49.3%	214,423	47.8%	32.5%	16.9%	2.9%
<b>NM</b>	2,059,179	<b>Ideal: 411,836</b>		9.6%	42.3%	45.3%	7.9%	1.8%	53.0%	47.0%	1,159,215	49.3%	31.9%	15.9%	2.9%

## **NM Public Regulation Commission: PRC\_187886.1\_Navajo**

### District Definitions by County and Precinct

PUBLIC REGULATION COMMISSION DISTRICT ONE.--Public regulation commission district one is composed of Bernalillo county precincts 4, 5, 7 through 18, 20 through 28, 30, 39, 83, 107, 108, 110 through 112, 114, 119 through 121, 125, 131, 150 through 154, 161 through 166, 180 through 187, 191 through 197, 211, 212, 215, 216, 241 through 246, 251 through 258, 271 through 275, 278, 281 through 287, 289 through 302, 304 through 308, 311 through 318, 321 through 324, 326 through 333, 341 through 347, 351 through 358, 371 through 375, 381 through 387, 400 through 456, 461 through 466, 471 through 478, 480 through 500, 502 through 550, 560 through 566, 568, 569 and 601 through 603.

PUBLIC REGULATION COMMISSION DISTRICT TWO.--Public regulation commission district two is composed of Bernalillo county precincts 303, 551 through 559 and 570 through 573; Chaves county; Colfax county precincts 2 through 5, 7 and 10 through 22; Curry county; De Baca county; Dona Ana county precincts 6, 66, 75, 76 and 110; Eddy county; Guadalupe county; Harding county; Lea county; Lincoln county precincts 1, 3, 12 and 14 through 16; Mora county precincts 9 through 11; Otero county precincts 1 through 13, 19, 20, 22, 23, 26 through 28, 30 through 33, 35, 37 through 39 and 41; Quay county; Roosevelt county; San Miguel county; Santa Fe county precincts 15, 18, 19, 73, 84 and 85; Tarrant county precincts 1 through 9 and 11 through 16; and Union county.

PUBLIC REGULATION COMMISSION DISTRICT THREE.--Public regulation commission district three is composed of Bernalillo county precincts 1 through 3, 6, 19, 29, 57, 68 through 70, 78 through 82, 84 through 87, 89, 113, 115 through 118, 127 through 129, 134, 170, 171 and 567; Colfax county precinct 1; Los Alamos county; Mora county precincts 1 through 8; Rio Arriba county precincts 1 through 23, 28 and 31 through 42; Sandoval county precincts 1 through 6, 11 through 13, 28 through 76 and 80 through 86; Santa Fe county precincts 1 through 11, 13, 14, 16, 17, 20 through 71, 74 through 83 and 86 through 88; and Taos county.

PUBLIC REGULATION COMMISSION DISTRICT FOUR.--Public regulation commission district four is composed of Bernalillo county precincts 31 through 38, 40 through 56, 58 through 67, 71 through 77, 88, 90 through 99, 101 through 106, 109, 122 through 124, 132, 133, 135 through 144, 214, 217, 221 and 223 through 226; Cibola county; McKinley county; Rio Arriba county precincts 24 through 27, 29 and 30; San Juan county; Sandoval county precincts 7 through 10, 14 through 27, 78 and 79; Santa Fe county precincts 12 and 72; Socorro county precincts 15 and 26; and Valencia county precinct 13.

PUBLIC REGULATION COMMISSION DISTRICT FIVE.--Public regulation commission district five is composed of Catron county; Dona Ana county precincts 1 through 5, 7 through 65, 67 through 74, 77 through 109 and 111 through 120; Grant county; Hidalgo county; Lincoln county precincts 2, 4 through 11, 13 and 17 through 21; Luna county; Otero county precincts 14 through 18, 21, 24, 25, 29, 34, 36 and 40; Sierra county; Socorro county precincts 1 through 14

and 16 through 25; Torrance county precinct 10; and Valencia county precincts 1 through 12 and 14 through 41.